

CERTIFIED CORNER RECORDATION

CORNER MC COR. S9 T.32 N., R.34 W., P.M.M. LINCOLN COUNTY

RECORD:

Refer to the attached Corner Recordation Form index # J-9.5 T32N R34W

FOUND EVIDENCE:

A 3 1/4 inch dia. Brass Cap stamped as shown
from which:

A 9" DBH Birch no visible scribe bears N37°W 15.4 ft. dist.

A 21" DBH Ponderosa Pine no visible scribe bears S36°E 96.4 ft. dist.

PERPETUATION:

Painted 6 inch wide bands and attached bearing tree tags and warning signs to trees.

MAGNETIC DECLINATION: 15° E

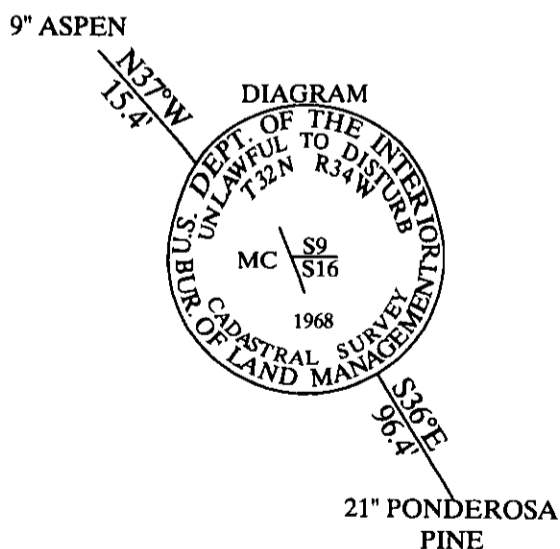

I, W.H. Davis CERTIFICATION
Certify the information shown herein is true and correct
Signature of Ground Party Chief
I, W.H. Davis
certify that this Corner Record correctly represents work
performed by me or under my direction in compliance with the
"Corner Recordation Act"
78-22-101, et seq. M.C.A.
Signature of Surveyor & Seal
Date 5/11/11 Reg. No. 4475-S
Employee Surveyor

SKETCH OF CORNER

Office of Clerk and Recorder, County of _____
This "corner record" was filed for record on _____
was noted on 232462 BOOK: CCR CC&R'S PAGE: 11889 Pages: 4
No. _____ STATE OF MONTANA LINCOLN COUNTY
RECORDED: 05/05/2011 10:19 KOI: CC&R'S
In book No. _____ JAMMY D. LAUER CLERK AND RECORDER
FEE: \$0.00 BY: Heather Dean
TO: FILED

Cross Index No. J-9.5 T. 32 N., R. 34 W., P.M.M.

SECTION

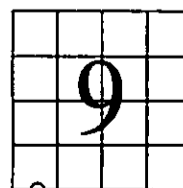

THIS CORNER