

CERTIFIED CORNER RECORDATION

CORNER E1/4 S11 T.32 N., R.34 W., P.M.M. LINCOLN COUNTY

RECORD:

Refer to the attached Corner Recordation Form index # G-21 Page 1834 T32N R34W

FOUND EVIDENCE:

A 3 1/4 inch dia. Brass Cap stamped as shown
from which:

A 11" DBH Douglas Fir no visible scribe bears S79°W 8 lks.

A 16" DBH Ponderosa Pine no visible scribe bears S31°E 12.4 ft dist.

PERPETUATION:

Painted 6 inch wide bands and attached bearing tree tags and warning signs to trees.

MAGNETIC DECLINATION: 15° E

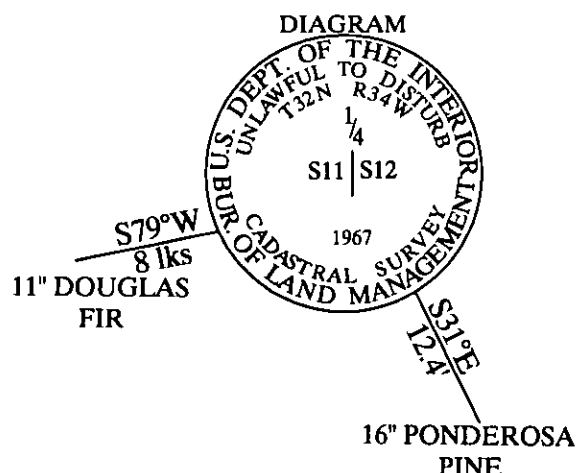

I, W. H. U. CERTIFICATION

Certify the information shown herein is true and correct
Signature of Ground Party Chief

I, David E. Davis

certify that this Corner Record correctly represents work
performed by me or under my direction in compliance with the
"Corner Recordation Act"
(70-22-101, et seq., M.C.A.)

Signature of Surveyor & Seal
Date 4/11/11 Reg. No. 4975-5
Employer Surveying, Inc.

Surveyor's Seal

SKETCH OF CORNER

Office of Clerk and Recorder, County of _____
This "corner record" was filed for record on _____
was note 232461 BOOK: CCR CC&R'S PAGE: 11888 Pages: 4
No. _____ STATE OF MONTANA LINCOLN COUNTY
In book RECORDED: 05/05/2011 10:18 KOI: CC&R'S
TAMMY D. LAUER CLERK AND RECORDER
FEE: \$0.00 BY: Flannery Davis
TO: FILED

Cross Index No. G-21 T. 32 N., R. 34 W., P.M.M.

SECTION

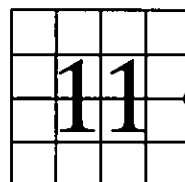

THIS CORNER