

CERTIFIED CORNER RECORDATION

CORNER S1/4 S1 T.32 N., R.34 W., P.M.M. LINCOLN COUNTY

RECORD:

Refer to the attached Corner Recordation Form index # E-23 Page 1846 T32N R34W

FOUND EVIDENCE:

A 31/4 inch dia. Brass Cap stamped as shown
from which:

A 14" DBH Larch no visible scribe bears N491/2°E 55 lks.

A 12" DBH Larch no visible scribe bears S611/2°W 60 lks..

PERPETUATION:

Painted 6 inch wide bands and attached bearing tree tags and warning signs to trees.

MAGNETIC DECLINATION: 15° E

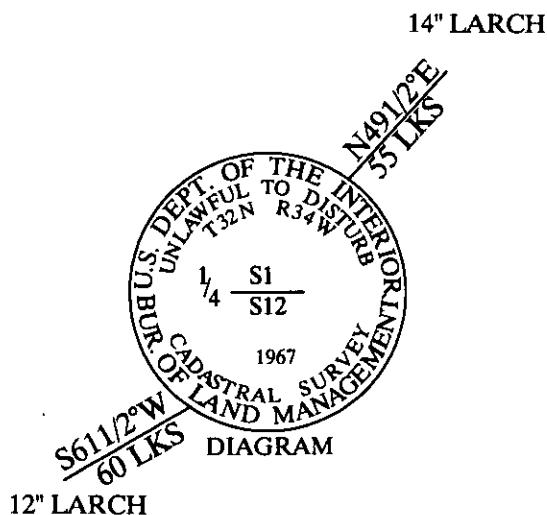

CERTIFICATION

I, Ken E. Davis

Certify the information shown herein is true and correct

Signature of Ground Party Chief

I, Ken E. Davis

certify that this Corner Record correctly represents work performed by me or under my direction in compliance with the "Corner Recordation act" (70-22-101, et seq., M.C.A.)

Signature of Surveyor & Seal

Date: 9/4/11 (Reg. No. 4975-S)

Emp. No. 4975-S

Ken E. Davis

SKETCH OF CORNER

Office of Clerk and Recorder, County of _____

This "corner record" was filed for record on _____

was noted on 232454 BOOK: CCR CC&R'S PAGE: 11884 Pages: 4

No. _____ STATE OF MONTANA LINCOLN COUNTY

In book No. RECORDED: 05/05/2011 9:30 KOI: CC&R'S

TAMMY D. LAUER CLERK AND RECORDER

FEE: \$0.00 BY: Seamus Davis

TO: FILED

SECTION

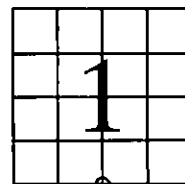

THIS CORNER

Cross Index No. E-23 T. 32 N., R. 34 W., P.M.M.