

# CERTIFIED CORNER RECORDATION

CORNER SW SEC. COR. S3 T.32 N., R.34 W., P.M.M LINCOLN COUNTY

## RECORD:

Refer to the attached Corner Recordation Form Page 2706 T32N R34W

## FOUND EVIDENCE:

A 31/4 inch dia. Brass Cap stamped as shown  
from which:

A 14" DBH Cedar no visible scribe bears N45°W 38.5 ft. dist.

A Dead Larch no visible scribe bears N12°W 30.0 ft. dist.

A 11" DBH Hemlock no visible scribe bears N48°E 58.5 ft. dist.

A 10" DBH Lodgepole Pine no visible scribe bears S31°E 57 ft. dist.

A 37" DBH Cedar no visible scribe bears S09°W 31.0 ft. dist.

## PERPETUATION:

Painted 6 inch wide bands and attached bearing tree tags and warning signs to trees.

MAGNETIC DECLINATION: 15° E

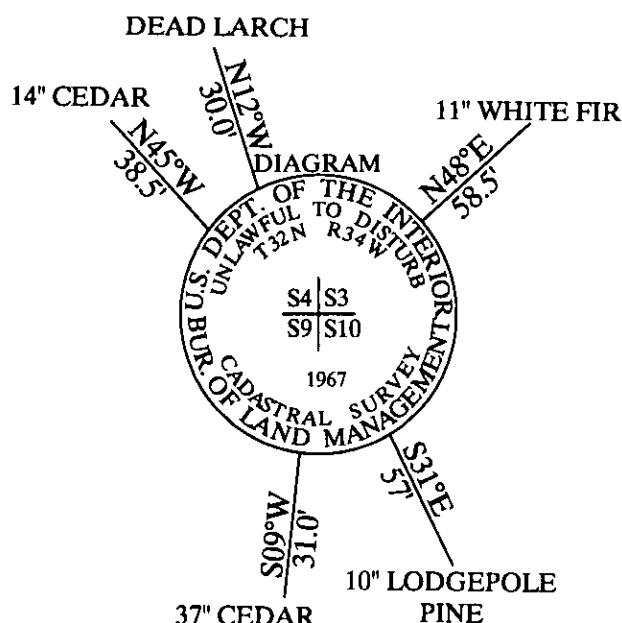

I, [Signature] CERTIFICATION

Certify the information shown herein is true and correct  
Signature of Ground Party Chief

I, KEN E. DAVIS

certify that this Corner Record correctly represents work  
performed by me or under my direction in compliance with the  
"Corner Recordation act"

(78-22-101, et seq. M.C.A.)

Signature of Surveyor & Seal

Date 5/11 Reg. No. 4975-5

Employer [Signature]

## SKETCH OF CORNER

Office of Clerk and Recorder, County of \_\_\_\_\_

This "corner record" was filed for record on \_\_\_\_\_

was noted on the 232449 BOOK: CCR CC&R'S PAGE: 11879 Pages: 5

No. \_\_\_\_\_ STATE OF MONTANA LINCOLN COUNTY

In book No. \_\_\_\_\_ RECORDED: 05/05/2011 9:25 KOI: CC&R'S

TAMMY D. LAUER CLERK AND RECORDER

FEE: \$0.00

BY: [Signature]

TO: FILED

Cross Index No. E-13 T. 32 N., R. 34 W., P.M.M.

## SECTION

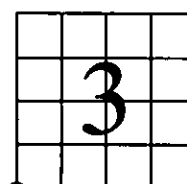

THIS CORNER

## INSTRUCTIONS

1. Subsequent record used to evaluate the corner position.
2. Description of evidence found, note discrepancies in the record, state method of establishing lost or obliterated corners.
3. Description of monument and accessories set to perpetuate the corner position.
4. Sketch of corner, show all pertinent data which can best be shown in a sketch example, corner marking, topography ties, position of accessories, etc.
5. Certification must be signed and sealed by Land Surveyor registered in the State of Montana.
6. Fill in Cross Index & Section Diagram at bottom of sheet.

## CERTIFIED CORNER RECORDATION

Corner  $\frac{4}{9} \frac{3}{10}$  T. 32N R. 34W. P.M.M. Lincoln County

1903 GLO Record: Set a limestone, 18x10x10ins., 12ins. in the ground, for cor. to secs. 3, 4, 9 and 10, marked with 5 notches on S. and 3 notches on E. edges;

from which;

A tamarack, 20ins. diam, bears N.34°45'E., 41 lks. dist., mkd. T32N R34W S3 BT.

A fir, 12ins. diam., bears S.82°45'E., 37 lks. dist., mkd. T32N R34W S10 BT.

A cedar, 20ins. diam bears S.10°W., 47 lks. dist., mkd T32N R34W S9 BT.

A tamarack, 22ins. diam., bears N.9½°W., 46 lks. dist., mkd T32N R34W S4 BT.

1967 BLM remonumentation: The cor. of secs. 3, 4, 9 and 10, as determined from the remains of the original bearing trees.

At the corner point

Set an iron post, 30ins. long, 2½ins. diam., 24ins. in the ground, with brass cap mkd.

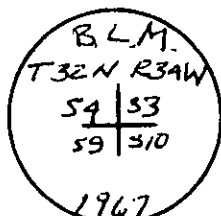

from which the original bearing trees:

a fir, 26ins. diam., bears N.34°45'E., 41 lks., mkd. R34W. (Record)

A cedar, 30ins. diam., bears S.10°W., 47 lks. dist., Mkd. T32N R34W S9 BT. (Record)

A tamarack snag, 23ins. diam., bears N.9½°W., 46 lks. dist., mkd. T32N R34W S4 BT. (Record)

The new bearing tree:

A cedar, 12ins. diam., bears N.41½°W., 56 lks. dist., mkd. T32N R34W S4 BT.

II. I find a BLM brass cap mkd. as shown above and slightly tilted to south.

from which:

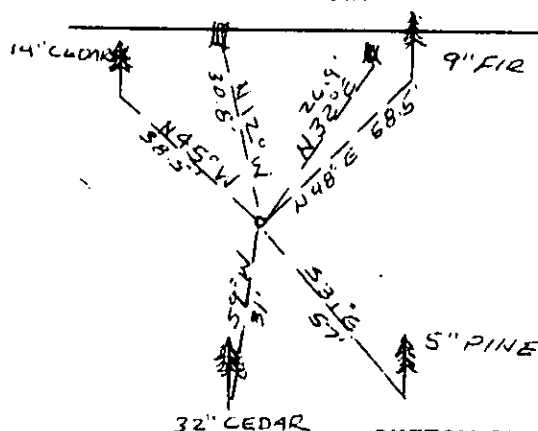

SKETCH OF CORNER

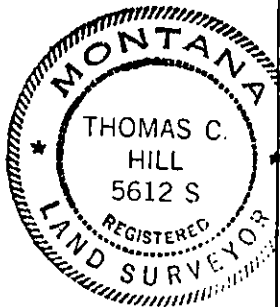

## CERTIFICATION

I, Thomas Hommel  
certify the information shown herein is true and correct.

Thomas C. Hill  
Signature of Ground Party Chief

I, Thomas C. Hill  
certify that this Corner Record correctly represents work performed by me or under my direction in compliance with the "Corner Recordation Act" (70-22-101, et seq., M.C.A.)

Thomas C. Hill  
Signature of Surveyor & Seal

Date: 6/28/84 Reg. No. 5612/S

Employer: USES

(OVER)

Office of Clerk and Recorder, County of \_\_\_\_\_ This "corner record" was filed for record on \_\_\_\_\_ was noted on the cross-index plat and is assigned page No. \_\_\_\_\_, in book No. \_\_\_\_\_

County Official

Cross Index No. E-13 T. 32N R. 34W P.M.M.  
Adopted July 1, 1981, Montana Board of Professional Engineers & Land Surveyors

Sec. 10

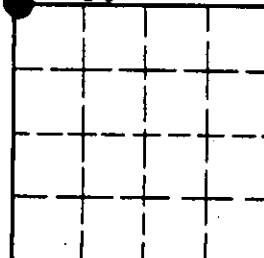

• corner this sheet

INSTRUCTIONS TO SURVEYORS FOR COMPLETING  
CERTIFIED CORNER RECORDATION FORMS

**I. ORIGINAL AND/OR SUBSEQUENT RECORD:**

This item should describe or quote those portions of the original or subsequent record which were used in evaluating the corner position. The original record will usually be the General Land Office field notes. Subsequent record can come from several sources: Previously filed corner records, maps and plats, private and public records, etc. Some of the subsequent record, even though not in the public record, but known to have validity by the surveyor, may be quoted and appropriately noted.

The record data helps support the reestablished corner position because it clearly shows what history the surveyor based his corner position on. In some cases, however, the record may be unknown or not pertinent. A statement to that effect should appear on the corner record.

**II. DESCRIPTION OF EVIDENCE FOUND OR METHOD OF LOCATING CORNER POSITION:**

This item will describe the original or subsequent record evidence found. If portions of the found evidence cannot be reconciled with the record, then the disregarded record should be noted, and, if possible, an opinion as to its cause narrated.

If no physical evidence of the original or subsequent monuments and accessories can be found, then the method used to reestablish the lost or obliterated corner (single proportion, fence intersection, parol evidence, terrain calls, centerline of road, etc.) shall be indicated.

**III. DESCRIPTION OF MONUMENTS AND ACCESSORIES SET TO PERPETUATE THE CORNER POSITION:**

This item should list all details about the corner and its location which will help exclusively identify the corner position; including size and type of monument, how marked if not shown in sketch, and distinguishing topographic calls which help locate the corner. In many cases, instructions on how to find the corner should be included.

References or ties to other corners are optional and may be drawn on the face or back of the corner record form, or references to Certificate of Survey may be made. Separate drawings may be attached to the corner form.

If state plane coordinate values for the corner position are shown, then the control upon which they are based should be indicated.

**IV. SKETCH OF CORNER:**

This item will usually show how a found or set corner is marked and may also show topography or accessory monuments found or set and their relation to the corner. There is no stipulated format; the sketch could be transcribed field note entries.

**V. CERTIFICATION:**

The name and signature of the ground party chief is optional.

The Surveyor who performed or directed the field work which is depicted on the "Certified Corner Record" shall sign and affix his seal in the Certification.

The employer blank is optional but useful in tracking down original field note data or adjacent record if, in the future, questions arise about the corner.

**VI.**

The Cross Index at the bottom of the page should be completed by the Surveyor. Only the single Township Index where the corner is filed shall be completed.

The lower righthand corner is a corner location diagram and should have the pertinent section filled in at the top and a closed circle indicating the appropriate corner position in the section filled in. This is intended to be an aid in searching the "Record" once it has been filed.

A cedar, 32in. diam., bears S.9°W., 31 ft., scribing visible.  
A cedar, 14ins. diam., bears N.45°W., 38.5 ft. dist., scribing visible.  
A stump, 30ins. diam., bears N.12°W., 30.8 ft. dist., scribing visible.  
A stump, bears N.32°E., 26.9 ft. dist., No visible scribe.

III. I set a 6 ft. carsonite post 1 ft. N. of corner.

from which the new bearing trees

A fir, 9in. diam., bears N.48°E., 58.5 ft. dist., scribed T32N R34W S3 BT.  
A pine, 5ins. diam., bears S.31°E., 57 ft. dist., scribed T32N R34W S10 BT.

I painted red bands around all BT's. and attached new BT signs.

