

CERTIFIED CORNER RECORDATION

CORNER NW SEC. COR. S1 T.32 N., R.34 W., P.M.M. LINCOLN COUNTY

RECORD:

Refer to the attached Corner Recordation Form index # S. 2 page 2837 T32N R34W

FOUND EVIDENCE:

A 3 1/4 inch dia. Alum. monument stamped as shown
from which:

A Dead Larch no visible scribe bears S68°E 33 lks.

A Dead Douglas Fir no visible scribe bears S28°W 29 lks.

A 15" DBH Douglas Fir no visible scribe bears S28°W 15'-11" dist.

PERPETUATION:

Established two new bearing trees for found monument
From which:

A 12" DBH Lodgepole Pine scribed T33N R33W S32 CC BT bears N45°W 4.75 ft. dist.

A 17" DBH Cedar scribed S1 CC BT bears S36°E 28.0 ft. dist.

Painted 6 inch wide bands and attached bearing tree tags and warning signs to trees.

MAGNETIC DECLINATION: 15° E

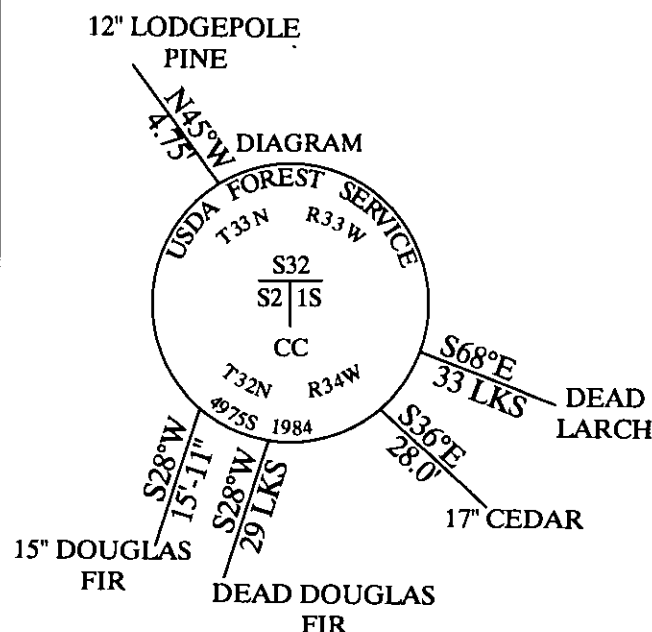

CERTIFICATION

I, [Signature]
Certify the information shown herein is true and correct
Signature of Ground Party Chief

I, DEN E. DAVIS

certify that this Corner Record correctly represents work
performed by me or under my direction in compliance with the
"Corner Recordation Act"
(70-22-101, et seq., M.C.A.)

Signature of Surveyor & Seal

Date 5/4/11 Reg No. 4975-S

Employer Surveying PAC

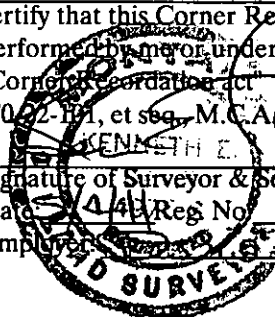

SKETCH OF CORNER

Office of Clerk and Recorder, County of _____

This "corner record" was filed for record on _____

was noted on t' 232442 BOOK: CCR CC&R'S PAGE: 11872 Pages: 4

No. _____ STATE OF MONTANA LINCOLN COUNTY

In book No. _____ RECORDED: 05/05/2011 9:18 KOI: CC&R'S

TAMMY D. LAUER CLERK AND RECORDER

FEE: \$0.00

TO: FILED

BY: [Signature]

Cross Index No. A-21 T. 32 N., R. 34 W., P.M.M.

SECTION

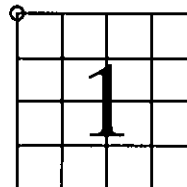

THIS CORNER