

1. Original and/or subsequent record used to evaluate the corner position.
2. Description of evidence found, note discrepancies in the record, state method of establishing lost or obliterated corners.
3. Description of monument and accessories set to perpetuate the corner position.
4. Sketch of corner, show all pertinent data which can best be shown in a sketch example, corner marking, topography ties, position of accessories,
5. Certification must be signed and sealed by Land Surveyor registered in the State of Montana.
6. Fill in Cross Index & Section Diagram at bottom of sheet.

CERTIFIED CORNER RECORDATION

Corner: 1/4 Corner: Secs. 25&36 T.32N. R. 34W. P.M.M. Lincoln County

1968 BLM Record: From found original evidence, set a 2-1/2 ins. x 30 ins. iron pipe, 24 ins. in the ground with brass cap from which:

A pine, 11 ins. dia., bears N4°30'E, 32 lks (21.1 ft.)
A pine, 12 ins. dia., bears S56°15'E, 51 lks (33.7 ft.)

1983 Record:
(Hill, 5612S)

Found a BLM iron pipe, 8 ins. above ground with brass cap from which:

A pine, 12 ins. dia., bears N8°E, 21.4 ft., with visible scribing.
A pine, 13 ins. dia., bears S53°E, 34.3 ft., with visible scribing.

2010 Found:

We find a 3-1/4 ins. dia. BLM brass cap, set firm in a large mound of stone, marked as shown below from which:

A pine, 14 ins. dia., bears N7°E, 21.4 ft., with an overgrown heel blaze.
A pine, 17 ins. dia., bears S57°E, 34.5 ft., with an overgrown heel blaze.

2010 Perpetuation:

Bearing trees affixed with BT tags, LSM signs, snow blazed and painted red bands.

Metal spike driven into BT's side center at point of measurement

Set a galvanized steel post South, 1.9 ft from the monument with LSM and USFS boundary decals.

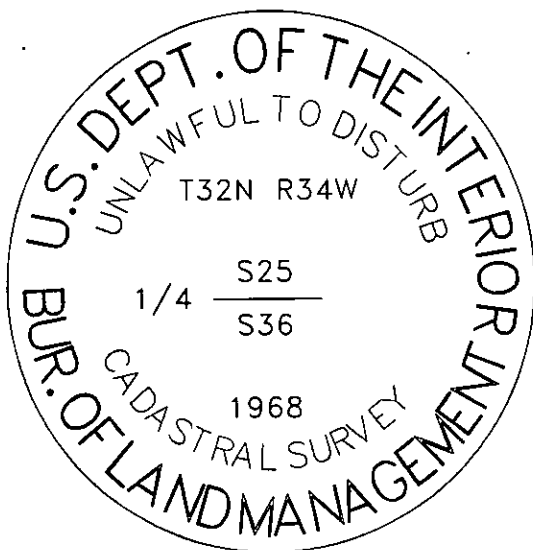

SKETCH OF CORNER

CERTIFICATION

I, Travis R. Williams
certify the information shown herein is true and correct.

Travis R. Williams
Signature Ground Party Chief

I, Ken E Jenkins
certify that this Corner Record correctly represents work performed by me or under my direction in compliance with the "Corner Recordation Act" (70-22-101).

Ken E Jenkins
Signature of Surveyor & Seal

Date: 12/2010 Reg. No. 9330 LS

Employer: Montana Northwest Company

P.O. Box 8777, Missoula, MT 59807

406-721-4033 Project No. 1617-10

Office of Clerk and Recorder, County of _____ This "corner record" was filed for record _____ was noted on the cross-index book No. _____

231898 BOOK: CCR CC&R'S PAGE: 11841 Pages: 1
STATE OF MONTANA LINCOLN COUNTY
RECORDED: 03/31/2011 10:16 KOI: CC&R'S
TAMMY D. LAUER CLERK AND RECORDER
FEE: \$0.00 BY: *Tammy D. Lauer*
TO: MONTANA NORTHWEST COMPANY P.O. BOX 8777, MISSOULA, MONTANA
County Official

Sec. 36

