

1. Original and/or subsequent record used to evaluate the corner position.
2. Description of evidence found, note discrepancies in the record, state method of establishing lost or obliterated corners.
3. Description of monument and accessories set to perpetuate the corner position.
4. Sketch of corner, show all pertinent data which can best be shown in a sketch example, corner marking, topography ties, position of accessories.
5. Certification must be signed and sealed by Land Surveyor registered in the State of Montana.
6. Fill in Cross Index & Section Diagram at bottom of sheet.

CERTIFIED CORNER RECORDATIONCorner: Section Corner; Secs. 13,14,23,24 T.32N. R. 34W. P.M.M. Lincoln County

1968 BLM Record: The cor. of secs. 13, 14, 23 and 24, monumented with a limestone, 18 ins. x 10 ins. x 6 ins., firmly set, mkd. with 1 notch on the East and 3 notches on the South edges, and witnessed by the remains of the original bearing trees.

At the corner point set an iron post, 30 ins. long, 2-1/2 ins. dia., 24 ins. in the ground, with a brass cap from which the original bearing trees:

A snag, 12 ins. dia., bears S62°E, 11 lks (7.3 ft.), marked "T32NR34WS24BT".

A stump hole, bears N22°45'W, 25 lks (16.5 ft.), marked "T32NR34WS14BT".

The new bearing trees:

A Cedar, 10 ins. dia., bears N34°45'E, 68 lks (44.9 ft.), marked "T32NR34WS13BT".

A Cedar, 9 ins. dia., bears S25°45'E, 37 lks (24.4 ft.), marked "T32NR34WS24BT".

A pine, 14 ins. dia., bears S18°W, 81 lks (53.5 ft.), marked "T32NR34WS23BT".

A Cedar, 7 ins. dia., bears N44°30'W, 13 lks (8.6 ft.), marked "T32NR34WS14BT".

Bury the original stone alongside post.

2010 Found: We find a 3-1/4 ins. brass cap on a 2-1/2 ins. dia. alum. shaft rising 8 ins. out of ground, marked as shown below from which:

A Cedar stump, 14 ins. dia., bears N34°30'E, 45.0 ft., with the scribing "S13BT"

A Larch snag, 10 ins. dia., bears S59°E, 7.7 ft., scribed "2N 34WS24BT"

A Cedar, 12 ins. dia., bears S26°E, 24.3 ft., scribed "T32NR34 S24BT"

A rotted stump, bears S18°W, 53.4 ft., no visible markings.

2010 Perpetuation: Establish new bearing trees as follows:

A Hemlock, 10 ins. dia., bears N23°30'E, 16.3 ft., scribed "T32NR34WS13BT"

A Cedar, 11 ins. dia., bears S52°30'W, 13.7 ft., scribed "T32NR34WS23BT"

A Larch, 6 ins. dia., bears N56°W, 15.6 ft., scribed "T32NR34WS14BT"

Bearing trees affixed with BT tags, LSM signs, snow blazed and painted red bands.

Steel spikes driven into BT's, side center at point of measurement.

We set galvanized steel posts, North, 12 ins. and West 14 ins. from monument, with LSM and USFS boundary decals.

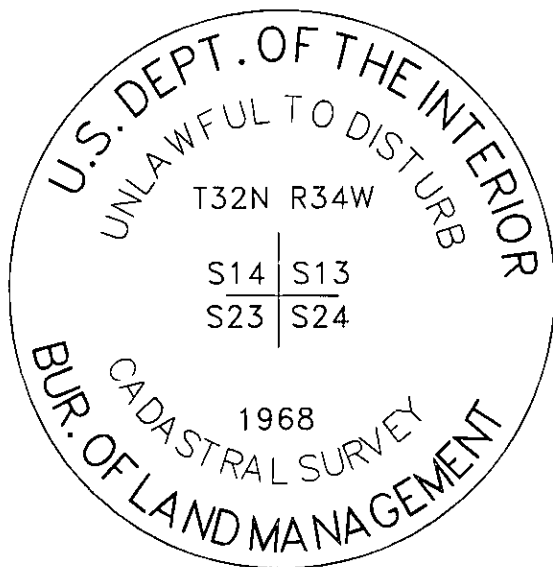
**SKETCH OF CORNER****CERTIFICATION**

I, Keith Brandt
certify the information shown herein is true and correct.

Keith Brandt
Signature Ground Party Chief

I, Ken E Jenkins
certify that this Corner Record correctly represents work performed by me or under my direction in compliance with the "Corner Recordation Act" (70-22-101, et seq., M.C.A.)

Ken E Jenkins
Signature of Surveyor & Seal

Date: 11/2010 Reg. No. 9330 LS

Employer: Montana Northwest Company

P.O. Box 8777, Missoula, MT 59807

406-721-4033 Project No.1617-10

Sec. 14

Office of Clerk and Recorder, County of _____ This "corner

record" was filed for 231841 BOOK: CCR CCR'S PAGE: 11810 Pages: 1

STATE OF MONTANA LINCOLN COUNTY
RECORDED: 03/30/2011 11:59 KOI: CCR'S

was noted on the cro: TAMMY D. LAUER CLERK AND RECORDER

book No. FEE: \$0.00

BY: Glennie Davis

TO: MONTANA NORTHWEST COMPANY P.O. BOX 8777, MISSOULA, MONTANA

County Official

