

1. Original and/or subsequent record used to evaluate the corner position.
2. Description of evidence found, note discrepancies in the record, state method of establishing lost or obliterated corners.
3. Description of monument and accessories set to perpetuate the corner position.
4. Sketch of corner, show all pertinent data which can best be shown in a sketch example, corner marking, topography ties, position of accessories,
5. Certification must be signed and sealed by Land Surveyor registered in the State of Montana.
6. Fill in Cross Index & Section Diagram at bottom of sheet.

CERTIFIED CORNER RECORDATION

Corner: Section Corner; Secs. 14,15,22,23 T.32N. R. 34W. P.M.M. Lincoln County

1966 BLM Record: The cor. of secs. 14, 15, 22 and 23, as determined from the remains of the original bearing trees. At the corner point, set an iron post, 30 ins. long, 2-1/2 ins. dia., 24 ins. in the ground, with brass cap from which the original bearing trees:

A Hemlock, 16 ins. dia., bears N32°E, 28 lks (18.5 ft.), marked "R34W 14"
 A dead Hemlock, 14 ins. dia., bears S39°E, 5 lks (3.3 ft.), marked "T32NR34WS23BT"
 A dead Hemlock, 9 ins. dia., bears N83°30'W, 21 lks (13.9 ft.), marked "R34WS15BT"

The new bearing trees:

A Cedar, 7 ins. dia., bears S29°30'E, 26 lks (17.2 ft.), marked "T32NR34WS23BT"
 A fir, 10 ins. dia., bears S37°30'W, 52 lks (34.3 ft.), marked "T32NR34WS22BT"
 A Cedar, 7 ins. dia., bears N9°W, 26 lks (17.2 ft.), marked "T32NR34WS15BT"

2010 Found: We find a 3-1/4 ins. brass cap on a 2-1/2 ins. dia. steel shaft rising 0.4 ft. out of ground, marked as shown below, from which:

A down Hemlock, 20 ins. dia., bears N29°E, 21.2 ft., with partial visible scribing.
 A Cedar stump, 11 ins. dia., bears S30°30'E, 19.0 ft. (Slope dist.), scribed "T32NR34WS23"
 A Cedar stump, 8 ins. dia., bears N8°W, 17.2 ft., scribed "T32NR34WS15BT"
 A small t-post with 1 ins. dia. survey cap bears West, flush with cap.

2010 Perpetuation: Establish new bearing trees as follows:
 A Cedar, 15 ins. dia., bears N42°E, 7.7 ft., scribed "T32NR34WS14BT"
 A Cedar, 14 ins. dia., bears S25°E, 21.0 ft. (Slope dist.), scribed "T32NR34WS23BT"
 A Larch, 6 ins. dia., bears S58°30'W, 28.1 ft., scribed "T32NR34WS22BT"
 A Larch, 8 ins. dia., bears N36°W, 26.3 ft., scribed "T32NR34WS15BT"
 Bearing trees affixed with BT tags, LSM signs, snow blazed and painted red bands.
 Steel spikes driven into BT's, side center at point of measurement.
 We set a galvanized steel post, North, 1.1 ft. and East 1.0 ft. from monument, with LSM and USFS boundary decals.

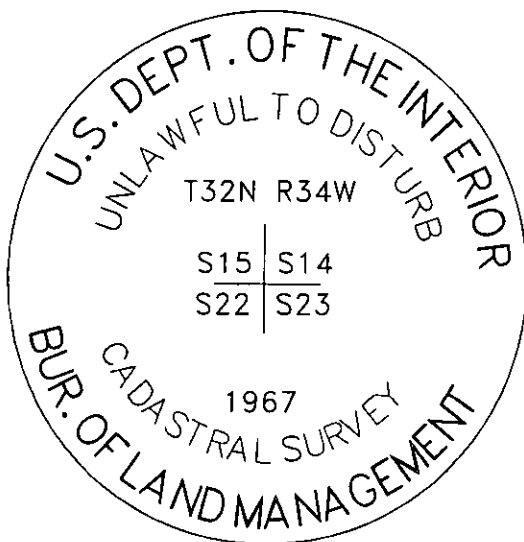

SKETCH OF CORNER

CERTIFICATION

I, Keith Brandt
 certify the information shown herein is true and correct.

Keith Brandt
 Signature Ground Party Chief

I, Ken E Jenkins
 certify that this Corner Record correctly represents work performed by me or, under my direction in compliance with the Corner Recordation Act" (70-22-101; et seq., M.C.A.)

Ken E Jenkins
 Signature of Surveyor & Seal

Date: 11/2010 Reg. No. 9330 LS

Employer: Montana Northwest Company

P.O. Box 8777, Missoula, MT 59807

406-721-4033 Project No. 1617-10

Office of Clerk and Recorder
 record" was filed for rec
 was noted on the cross-i
 book No. _____

231827 BOOK: CCR CC&R'S PAGE: 11796 Pages: 1
 STATE OF MONTANA LINCOLN COUNTY
 RECORDED: 03/30/2011 11:45 KOI: CC&R'S
 TAMMY D. LAUER CLERK AND RECORDER
 FEE: \$0.00 BY: Tammy D. Lauer
 TO: MONTANA NORTHWEST COMPANY P.O. BOX 8777, MISSOULA, MONTANA
 County Official

Sec. 14

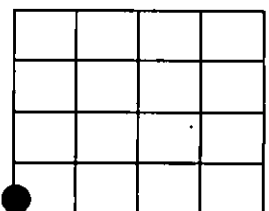

Cross Index No. N-17 T. 32N R. 34W PMM

- Corner this sheet