

# CERTIFIED LAND CORNER RECORDATION

## DESCRIPTION OF CORNER EVIDENCE FOUND, AND ORIGINAL RECORD (IF KNOWN)

FOUND: No evidence of corner monument.

RECORD: Falls on a limestone rock in place, 4 x 2 x 1 ft. above ground.  
I cut a cross (+) at exact corner point for 1/4 sec. corner,  
marked 1/4 on W. side.

FOUND: A 36" Ponderosa Pine with scribing & a pine lying on ground with  
bearing tree scribing.

RECORD: (From which) A pine, 30 ins. diam., bears S. 76° E., 78 lks. dist.,  
marked 1/4 S. 14 B.T.

A pine 32 ins. diam., bears S. 1° 30' W., 32 lks. dist., marked 1/4  
S. 15 B.T.

## DESCRIPTION OF MONUMENT AND ACCESSORIES ESTABLISHED TO PERPETUATE THE ORIGINAL LOCATION OF THIS CORNER:

Date of work: DEC 4, 1975

### REMONUMENTATION:

We measure original distances from 2 bearing trees and intersection  
point falls on rock in place.

At intersection point we set a 4" DIA. brass disk in rock and mark  
as per sketch below.

## SKETCH, WITH COURSE AND DISTANCE TO ADJACENT CORNERS IF DETERMINED IN THIS SURVEY. (MAY SKETCH OR PASTE REPRODUCTION ON REVERSE SIDE.)

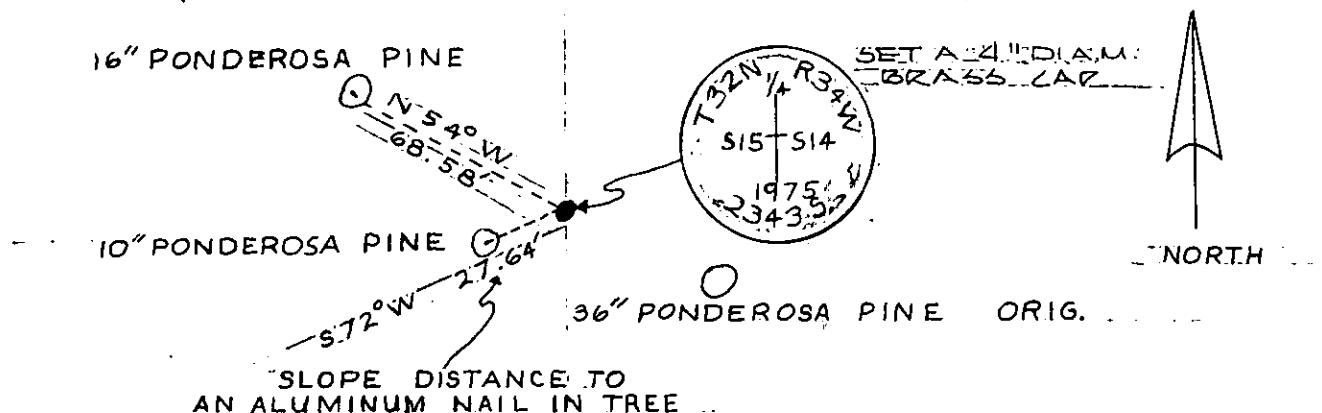

Surveyor's Seal

I, R. GORDON RILEY  
certify that the information shown herein is true and  
correct.

[Signature]  
Signature of Ground Party Chief

I, J. T. SHAW  
certify that I have carefully performed or reviewed the  
work done on the diagrammed corner as reported on this  
recording form and approve the same.

[Signature]  
Signature of Surveyor

### DIAGRAM OF CORNER:

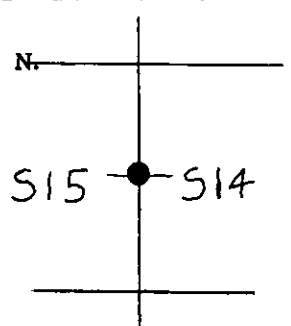

● = Corner recorded on the sheet

2343.9  
Registration Number

T32N R34W 1/4

Office of Clerk and Recorder, County of Lincoln 2:35 p.m.

This "corner record" was filed for record on the 4th day of March 1976 was noted on the cross-index plat and is

assigned page No. 447, in book No. 1

Eleanor Z. Laughlin by Sherry Davis  
County Official deputy