

CERTIFIED LAND CORNER RECORDATION
(REFERENCE FSM 7153.53)

DESCRIPTION OF CORNER EVIDENCE FOUND, AND ORIGINAL RECORD (IF KNOWN)

FOUND: None.

RECORD: No previous record.

DESCRIPTION OF MONUMENT AND ACCESSORIES ESTABLISHED
TO PERPETUATE THE ORIGINAL LOCATION OF THIS CORNER:

Date of work: NOV. 1975

We set 1 1/2" I.D. x 30" Forest Service Brass-Capped Pipe 24" in ground. Stamped as per sketch. We built a mount of stones around pipe and painted it red.

We make reference monuments for reference to corner. Description of reference monuments 1 and 2 as per sketch.

Steel Fence post with land survey monuments and location posters located as per sketch.

SKETCH, WITH COURSE AND DISTANCE TO ADJACENT CORNERS IF DETERMINED IN THIS SURVEY.
(MAY SKETCH OR PASTE REPRODUCTION ON REVERSE SIDE.)

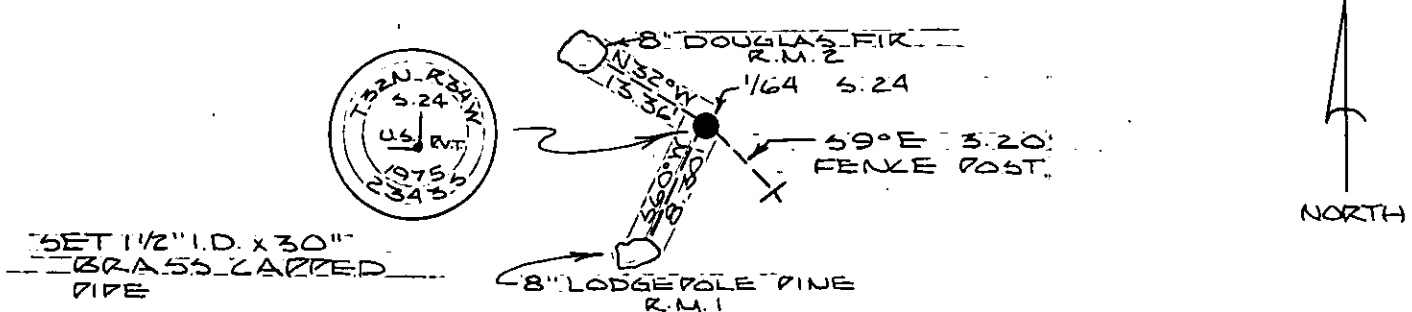

Surveyor's Seal

I, R. G. RILEY
certify that the information shown herein is true and correct.

[Signature of R. G. Riley]
Signature of Ground Party Chief

I, J. T. SHAW
certify that I have carefully performed or reviewed the work done on the diagrammed corner as reported on this recordation form and approve the same.

[Signature of J. T. Shaw]
Signature of Surveyor

DIAGRAM OF CORNER:

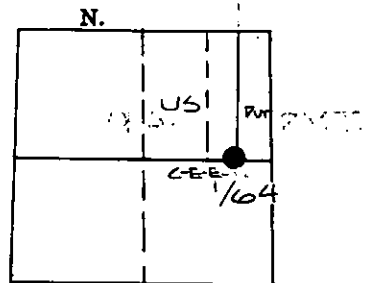

● = Corner recorded on the sheet
S. 24 T. 32 N. R. 34 W. 1/64
C-E-E-1/64

23455
Registration Number

Office of Clerk and Recorder, County of Lincoln 1:30 p.m.

This "corner record" was filed for record on the 4th day of March 1976, was noted on the cross-index plat and is assigned page No. 434, in book No. 1

[Signature of Eleanor Z. Vaughn]
County Official *[Signature of Deputy]*

Cross Index No. P-24-25 T. 32 N R. 34 W Mer.