

INSTRUCTIONS

1. Original and/or subsequent record used to evaluate the corner position.
2. Description of evidence found, note discrepancies in the record, state method of establishing lost or obliterated corners.
3. Description of monument and accessories set to perpetuate the corner position.
4. Sketch or corner, show all pertinent data which can best be shown in a sketch example, corner marking, topography ties, position of accessories, etc.
5. Certification must be signed and sealed by Registered Land Surveyor in State of Montana.
6. Fill in Cross Index & Section Diagram at bottom of sheet.

CERTIFIED CORNER RECORDATION

Corner Property Corner Sec. 27 T. 32N. R. 3W. P.M.M. Lincoln County

I. Davis Surveying Inc. 1987

I set a 5/8" diam.x 24" long rebar with a yellow P.V.C. Cap stamped K.E.D. 4975-S. from which,

A 5" tamarack bears due North 37 feet from center of tree scribed BT/.
A 10" tamarack bears N.32°E. 29.3 feet from center of tree scribed BT.
Notched trees at root crown. Painted a red band around trees.

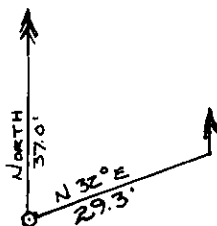
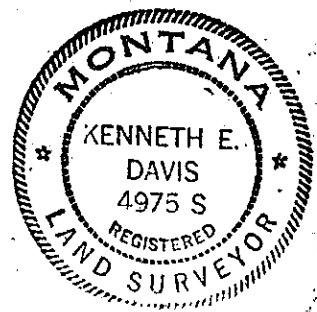

SKETCH OF CORNER

CERTIFICATION

Ken E. Davis

I, Ken E. Davis, certify the information shown herein is true and correct.

Tom Davis

Signature Ground Parts Chief

I, Ken E. Davis, certify that this record correctly represents work performed by me or under my direction in compliance with the "Corner Recordation Act" (20-22-01, et seq. M.C.A.)

Signature of Surveyor

Date: 1/87

Employer: Davis Surveying Inc.

Sec. 27

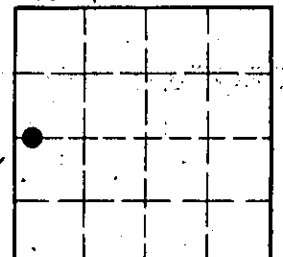

• - corner this sheet

Office of Clerk and Recorder, County of Lincoln. This "corner record" was filed for record on the January 29 day of 1987 was noted on the cross-index plat and is assigned page No. 3502 in book No.

Grant B. Sugar County Official Deputy

Cross Index No. T. R. P.M.M.