

## INSTRUCTIONS

1. Original and/or subsequent record used to evaluate the corner position.
2. Description of evidence found, note discrepancies in the record, state method of establishing lost or obliterated corners.
3. Description of monument and accessories set to perpetuate the corner position.
4. Sketch or corner, show all pertinent data which can best be shown in a sketch example, corner marking, topography ties, position of accessories, etc.
5. Certification must be signed and sealed by Registered Land Surveyor in State of Montana.
6. Fill in Cross Index & Section Diagram at bottom of sheet.

## CERTIFIED CORNER RECORDATION

Corner N  $\frac{1}{4}$  Corner Section 22 T. 32 N. R. 34 W. P.M.M. Lincoln County

I. Original G.L.O. Notes 1903 Allen B. Benedict

Set a fir post 3 ft. long, 4 ins. square, 24 ins. in the ground, (for  $\frac{1}{4}$  sec. cor. marked  $\frac{1}{4}$  S.15 on N. and 22 on S. faces; from which  
A pine, 30 ins. diam. bears N.24°30'E. 18 lks. dist. marked 1-4 S.15 BT.  
A pine, 18 ins. diam. bears S.29°E. 22 lks. dist. marked, 1-4 S.22 BT.

II. I found no original evidence except barely visible scribing on a pine stump but inconclusive.III. Davis Surveying Inc. 1986

I set a  $3\frac{1}{4}$ " diam. Aluminum Cap on a  $5/8$ " diam. x 4' long rebar driven into the ground. Stamped;

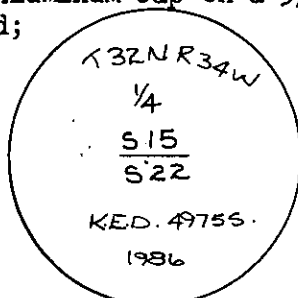

from which,

A 6" Fir bears S.54°W. 11.2 feet from center of the tree. Scribed  $\frac{1}{4}$  S.22 BT. Painted red band around tree. Placed BT sign #54.3 on front and warning sign #54-9 on back of tree. Notched at root crown.  
An 8" tamarack bears S.80°E. 16.0 feet from center of tree. Scribed  $\frac{1}{4}$  S.22 BT. Painted a red band around tree, placed BT sign on front and warning sign on back of tree. Notched at root crown.  
Set a steel post 1' North of corner.

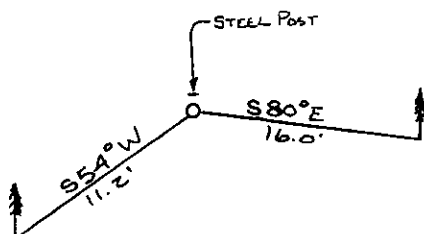

SKETCH OF CORNER

## CERTIFICATION

1. Ken E. Davis

certify the information shown herein is true and correct.

Signature of Ground Party Chief

1. Ken E. Davis  
certify that this Corner Record correctly represents work performed by me or under my direction in compliance with the "Corner Recordation Act" (70-2210, sec. 1, M.C.A.)

Signature of Surveyor & Seal

Date: 12/86

Employer: Davis Surveying Inc.

Office of Clerk and Recorder, County of Lincoln. This "corner record" was filed for record on the Dec 29 day of 1986 was noted on the cross-index plat and is assigned page No. 3452, in book No. \_\_\_\_\_  
Janet St. Sogelby Deputy  
County Official

Sec. 22

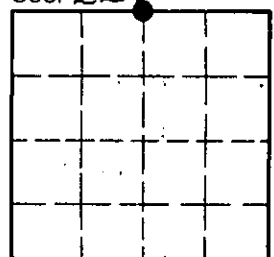

Cross Index No. \_\_\_\_\_ T. \_\_\_\_\_ R. \_\_\_\_\_ P.M.M.

• - corner this sheet