

## INSTRUCTIONS

1. Original and/or subsequent record used to evaluate the corner position.
2. Description of evidence found, note discrepancies in the record, state method of establishing lost or obliterated corners.
3. Description of monument and accessories set to perpetuate the corner position.
4. Sketch or corner, show all pertinent data which can best be shown in a sketch example, corner marking, topography ties, position of accessories, etc.
5. Certification must be signed and sealed by Registered Land Surveyor in State of Montana.
6. Fill in Cross Index & Section Diagram at bottom of sheet.

## CERTIFIED CORNER RECORDATION

Corner E 1/4 Corner Section 22 T. 32N. R. 34W. P.M.M. Lincoln County

I. Original G.L.O Notes 1903 Allen B. Benedict

Set a tamarack post 8 ft. long, 4 ins. square, 24 ins. in the ground, for 1/4 sec. cor. marked 1/4 S.23 in E. and 22 on W. faces: from which  
 A tamarack, 5 ins. diam. bears S.20°45'E., 23 lks. dist. marked 1-4 S23 BT.  
 A tamarack, 6 ins. diam. bears S.18°W., 24 lks. dist. marked 1-4 S22 BT.

II. I found one original bearing tree. A 13" tamarack in poor shape with the scribing visible but the face is badly cut up.III. Davis Surveying Inc., 1986

I set a 3 1/4" U.S.D.A. Forest Service Aluminum Cap with a 5/8" diam. x 4' long rebar driven into the ground. Cap is Stamped:

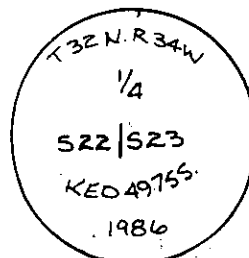

from which the original bearing tree

A 13" tamarack bears S.18°W. 24 lks. 15.84 feet, with 1/4 scribing visible. Painted a red band around tree.

from which the new bearing trees

A 8" spruce bears S.75°E., 15.40 feet from the center of the tree. Scribed 1/4 S23 B T. Placed BT sign # 54-3 on front and warning sign # 54-9 on back. Painted a red band around tree and notched at root crown. Scribed a 4"x 4" X above red band.

A 9" red fir bears N.87°W., 19.60 feet from the center of tree, scribed 1/4 S22 BT. Placed BT sign # 54-3 on front and warning sign # 54-9 on back. Painted a red band around tree and notched at root crown, Scribed a 4"x 4" X above red band.

Set a steel post 1' North of corner.

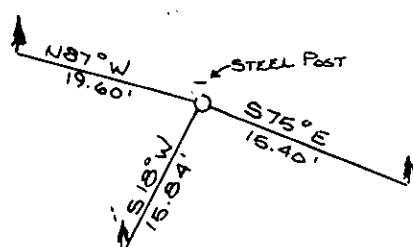

SKETCH OF CORNER

## CERTIFICATION.

I, KEN E. DAVIS

certify the information shown herein is true and correct

Tom DAVIS  
 Signature of Second Party Chief

I, KEN E. DAVIS  
 certify that this Corner Record correctly represents work performed by me or under my direction in compliance with the "Corner Recordable Act" (70-22-101, et seq., M.C.A.)

KEN E. DAVIS  
 Signature of Surveyor & Seal

Date: 12/29/86 Reg. No. 4975

Employer: DAVIS SURVEYING INC.

Office of Clerk and Recorder, County of Lincoln. This "corner record" was filed for record on the Dec 29 day of 1986 was noted on the cross-index plat and is assigned page No. 3457, in book No. \_\_\_\_\_

Grant B. Sigel  
 County Official

Sec. 22

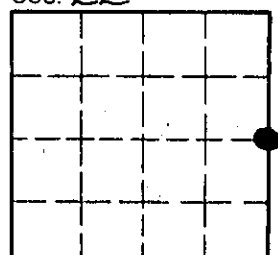

Cross Index No. \_\_\_\_\_ T. \_\_\_\_\_ R. \_\_\_\_\_ P.M.M.

• - corner this sheet