

CERTIFIED CORNER RECORDATION

Corner MC Sec. 35 T. 33N R. 34W P.M., MT Lincoln County

- I. 1903 G.L.O. Record by Allen B. Benedict: Right bank of Kootenai River, set a granite stone, 18x12x10 ins., 6 ins. in the ground, for meandor cor. of fractional sec. 35, mkd. "M.C." on West face, and "S.C." on the North Face.

Established two bearing trees:

A fir, 14 ins. diam., bears N47°E, 35 lks. dist., mkd "T33N R34W S35 MC BT".
A fir, 14 ins. diam., bears N36°W, 15 lks. dist., mkd "T33N R34W S35 MC BT".

- II. No evidence found of corner monument, the M.C. of secs. 35 and 5, as determined from the remains of one original bearing tree.
- III. At the corner point, set an aluminum rock cap, 3 1/4 ins. diam., 3 1/2 in. stem, with concrete grout in a rock ledge, cap mkd. as shown.

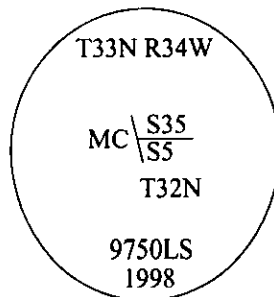

from which:

The original bearing tree:

A fir, 24 ins. diam., bears N47°E, 23.1 ft. dist., with visible marks. (GLO-record)

The new bearing tree:

A fir, 17 ins. diam., bears N01°E, 50.5 ft. dist., mkd. "T33N R34W S35 MC BT".

Painted bearing trees and attached Land Survey Monument and Bearing Tree signs.

Magnetic Declination: 20° East

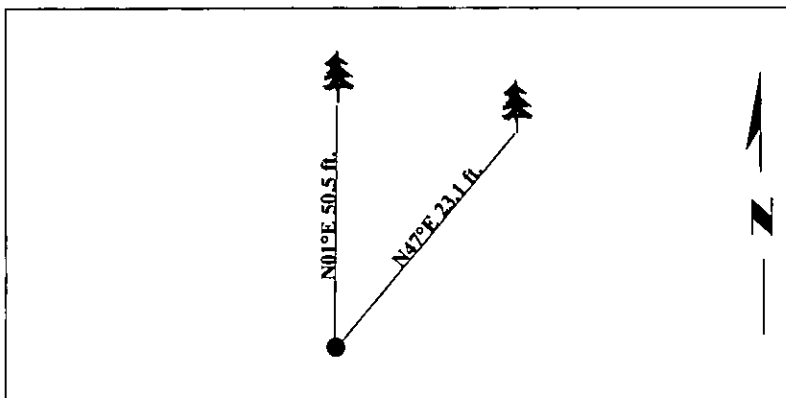

SKETCH OF CORNER

CERTIFICATION

I, Thomas M. Hommel
certify the information shown herein is true and correct.

I, Steve A. Boyer
certify that this Corner Record correctly represents work performed by me or under my direction in compliance with the "Corner Recordation Act", (76-22-101, et seq., M.C.A.)

Signature of Surveyor & Seal

Date: 6/09/98

Reg. No.: 9750LS

Employer: U.S. FOREST SERVICE

Office of Clerk and Recorder, County of Lincoln. This "corner record" was filed for record on 8-19-98 and was noted on the cross-index plat and is assigned page No. 1018 in book No.

Coral M. Cummings By PB
County Official



Cross Index No. MC S35 T. 33N R. 34W P.M., MT