

CERTIFIED CORNER RECORDATION

Corner: E. W. W. 1/256 Sec. 26, Twp. 32 N., R.34 W., P.M.M.

Lincoln County Montana

Record : None

Found Evidence: None

Perpetuation : Set a 5/8 inch dia. rebar 24 inches long, 20 inches in the ground with a 3 1/4 inch aluminum cap stamped: Davis Surveying, Inc. (See diagram below).

From which: I established the following two new bearing trees:

A 10 1/2 inch DBH white fir bears S 15° E 18.70 ft. dist. scribed E.W.W. 1/256 S 26 BT.

A 10 inch DBH white fir bears S 81° E 13.90 ft. dist. scribed E.W.W. 1/256 S 26 BT.

Declination 18 °E

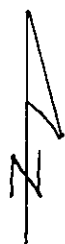

E W W
1/256 S 26 BT

E W W
1/256 S 26 BT

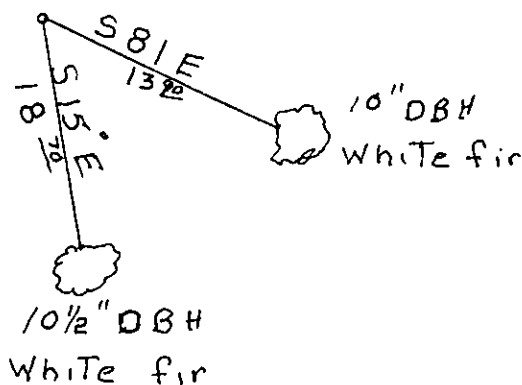
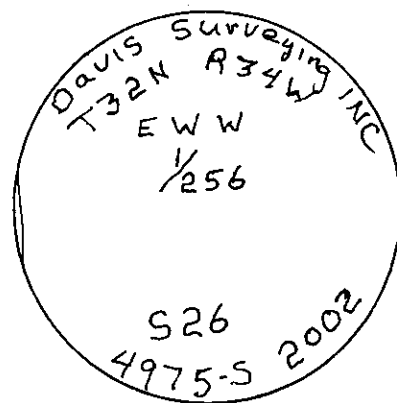

CERTIFICATION

I, **George Clark**

certify the information shown herein is true and correct

Signature of Ground Party Chief

I, **Ken Davis**

certify that this Corner Record correctly represents work performed by me and my direction in compliance with the "Corner Recordation

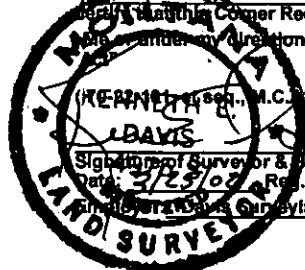

Signature of Surveyor & Seal

Date: 3/25/02

Reel No. 4975-S

Davis Surveying, Inc.

Sketch of Corner

Office of Clerk and Recorder, County of Lincoln

This "corner record" was filed for record on 3/26/02 **10562**

was noted on the cross-index plat and is assigned page No.

In book No. Coral M. Cummins By DB

County Official

Section

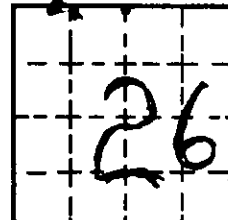

Cross Index No. Twp. 32 N., R. 34 W., P.M.M.

• THIS CORNER