

CERTIFIED CORNER RECORD

Corner: NW CC S 3 Twp. 32 N., R. 34 W., P.M.M.
NE CC S 4

Lincoln County

Record :

Per GLO 1903 Allen Benidict

Set a limestone 15 X 12X 6 inch 10 inch in the ground for closing corner of sec. 3 and 4 marked CC on the S with 3 grooves on E and 3 grooves on the W faces.

From Which:

A Tamarack 8 inch diameter bears S 45° E 90 lks. distance marked Twp. 32N., R.34W., S 3 BT.

A Pine 8 inch diameter bears S 40° 15' W 97 lks. dist. Marked Twp. 32 N., R. 34W., S 4 BT.

Found Evidence :

Original stone out of position, original Larch bearing tree, scribing legible bears S 44° E 59.4 ft distance.

Perpetuation :

Set a 3 inch OD, X 30 inch long, with a 3 1/4 inch cap, 26 inch in the ground stamped as follows, see (diagram below).

Established the following two new bearing trees

From Which:

A 14 inch DBH Douglas Fir scribed Twp. 32N., R.34 W., S 4 CCBT bears S 70°W 41.3 ft distance.

A 8 inch DBH Larch scribed X BT, bears S 9° E 46.0 ft distance.

Painted six inch red bands and attached warning and bearing tree signs to both trees.

Magnetic Declination 18 °E

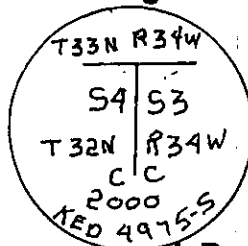
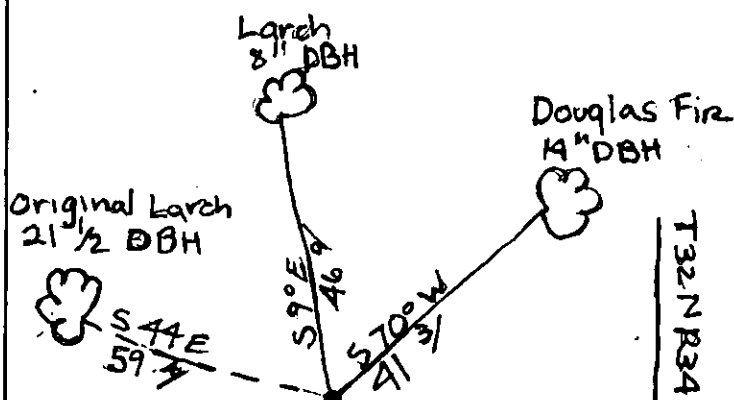

CERTIFICATION

I, Randy Borgmann
certify the information shown herein is true and correct

Signature of Ground Party Chief
Randy Borgmann
I, E. Davis
certify that this Corner Record correctly represents work performed
under my direction in compliance with the "Corner Record"

Signature of Surveyor
E. Davis
Date
Employer Davis Surveying, Inc.

Sketch of Corner

Office of Clerk and Recorder, County of Lincoln

This "corner record" was filed for record on Jan 3, 2001

was noted on the cross-index plat and is assigned page No.

In book No. 10462
County Official Coral M. Cummins By DB

Section

4

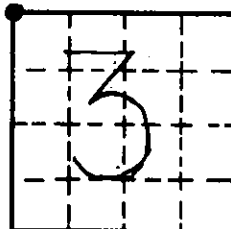

Cross Index No. NW CC S 3 Twp. 32 N., R. 34 W., P.M.M.
NW CC S 4

• THIS CORNER