

- CERTIFIED CORNER RECORDATION -

Corner 1/4 Secs. 5 & 8 T. 32 N. R. 34 W. P.M., MT Lincoln County

- I. 1903 G.L.O. Record by Allen B. Benedict: "Set a granite stone, 16x10x9 ins., 11 ins. in the ground, for 1/4 sec. cor. marked 1/4 on N. face.

from which:

A pine, 4 ins. diam., bears S.41°15'W., 13 lks. dist., marked 1/4 S8 BT.
A cottonwood, 5 ins. diam., bears N.83°W., 15 lks. dist., marked 1/4 S5 BT."

- II. Found a stone, 7" x 9", protruding 4 ins. above the ground, firmly set, mkd. "1/4" on the N. face.

from which:

No evidence found of pine, at S41°W, 13 lks. distance.
A stump hole w/rotten crown, bears N83°W, 10.0 ft. distance.
A ponderosa pine, 12 ins. diam., bears S28°E, 15.2 ft. dist., with a healed blaze (not of record).

- III. In the position of the found stone, set an aluminum pipe, 30 ins. long, 2 1/2 ins. diam., 22 ins. in the ground, with a 3 1/4 in. diam. aluminum cap, mkd. as shown.

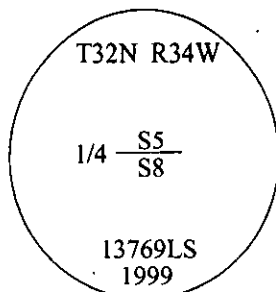

from which:

A pine, 14 ins. diam., bears N65°E, 46.6 ft. dist., scribed "1/4 S5 BT".
A fir, 8 ins. diam., bears S25°E, 17.5 ft. dist., scribed "1/4 S8 BT".

Buried original stone along side of aluminum pipe and surrounded monument with a mound of stone.

Magnetic Declination: 20° East

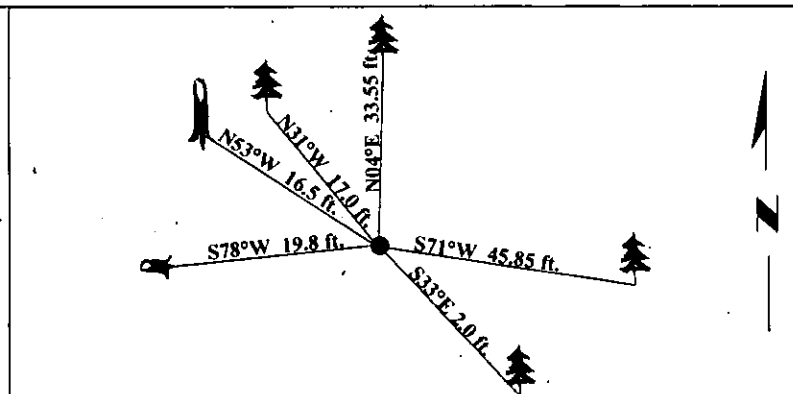

SKETCH OF CORNER

CERTIFICATION	
I. <u>Rex O. Rice</u>	certify the information shown here is true and correct.
<i>Rex O. Rice</i>	
I. <u>Roger O. Green</u>	certify that this Corner Record correctly represents work performed by me or under my direction in compliance with the "Corner Recordation Act," (22-2-101 et seq., M.C.A.)
<i>Roger O. Green</i>	
Date: <u>9/01/99</u>	Signature of Surveyor & Seal
Reg. No.: <u>13769LS</u>	
Employer: <u>U.S. FOREST SERVICE</u>	

Office of Clerk and Recorder, County of Lincoln. This "corner record" was filed for record on 10/27/99 and was noted on the cross-index plat and is assigned page No. 10397 in book No. _____.

Coral M. Cummings
County Official

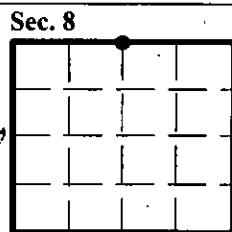

● - corner this sheet

Cross Index No. E-07 T. 32 N. R. 34 W. P.M., MT