

INSTRUCTIONS

1. Original and/or subsequent record used to evaluate the corner position.
2. Description of evidence found, note discrepancies in the record, state method of establishing lost or obliterated corners.
3. Description of monument and accessories set to perpetuate the corner position.
4. Sketch of corner, show all pertinent data which can best be shown in a sketch example, corner marking, topography ties, position of accessories, etc.
5. Certification must be signed and sealed by Land Surveyor registered in the State of Montana.
6. Fill in Cross Index & Section Diagram at bottom of sheet.

CERTIFIED CORNER RECORDATION

Corner 5 of HES 1241 T. 32 N. R. 33 W. Lincoln County

- I. 1927 HES 1241 record by Harold Townsend: "Place a small stone marked with a cross(x) under a iron post 2 ins. in diam., 36 ins. long, 24 ins. in the ground, with a brass cap marked 1927 5 HES 1241 and a point on top for the exact corner point, from which

A cross(x) on a hemlock tree 7 ins. diam., bears $N85^{\circ}55'E$, 26 lks. (17.16 ft.) dist.
 A cross(x) on a hemlock tree 6 ins. diam., bears $S30^{\circ}45'E$, 25 lks. (16.50 ft.) dist.
 Each blazed and scribed 5 HES 1241 BT."

- II. Found a 2 ins. diam. iron pipe 12 ins. out of the ground with brass cap mkd. as shown.

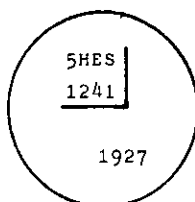

From which:

A hemlock, 21 ins. diam., bears $N88^{\circ}E$, 17.9 ft. dist., healed face.
 A rotten stump, bears $S30^{\circ}E$, 16.0 ft. dist.

- III. Established one new bearing tree:

A hemlock, 9 ins. diam., bears $S53^{\circ}W$, 6.2 ft., dist., mkd. 5 HES 1241 BT.

Painted red bands around the bearing trees and attached "Land Survey Monument" and "Bearing Tree" signs.
 Set a galvanized steel gaurd post with "Land Survey Marker" and Property Boundary: decals, $N11^{\circ}E$, 3 ft.

Magnetic declination: 20° East

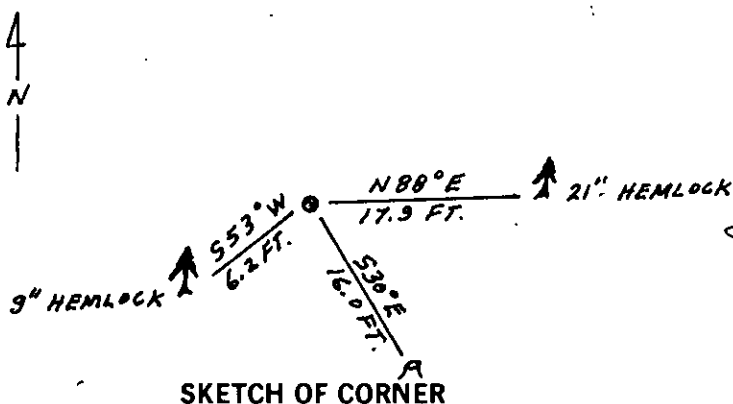

CERTIFICATION

I, Kevin A. Todd
 certify the information shown herein is true and correct.

Kevin A. Todd
 Signature Ground Party Chief

I, Ronald A. Pearson
 certify that this Corner Record correctly represents work performed
 by me or under my direction in compliance with the "Corner
 Recordation Act" (70-22-101, et seq., M.C.A.)

Ronald A. Pearson
 Signature of Surveyor & Seal
 Date: 11/16/92 Reg. No. 9008LS
 Employer: U.S. FOREST SERVICE

Office of Clerk and Recorder, County of Lincoln. This "corner
 record" was filed for record on 12-15-92
 was noted on the cross-index plat and is assigned page No. 5191, in
 book No. Coral M Cummings by RSB

County Official

5 HES 1241 32 N 33W

Cross Index No. T. R. PMM

Sec. 8

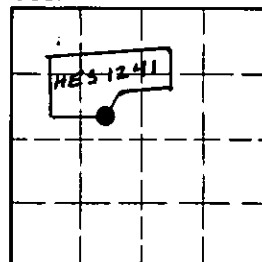

• - corner this sheet