

INSTRUCTIONS

1. Original and/or subsequent record used to evaluate the corner position.
2. Description of evidence found, note discrepancies in the record, state method of establishing lost or obliterated corners.
3. Description of monument and accessories set to perpetuate the corner position.
4. Sketch of corner, show all pertinent data which can best be shown in a sketch example, corner marking, topography ties, position of accessories, etc.
5. Certification must be signed and sealed by Land Surveyor registered in the State of Montana.
6. Fill in Cross Index & Section Diagram at bottom of sheet.

CERTIFIED CORNER RECORDATION

Corner South 1/4 Sec. 15 T. 32 N. R. 31 W. P.M.M. Lincoln County

I. 1901 GLO record by Abram L. Jaqueth: Set a stone and two bearing trees.

1965 BLM remonumentation record: The 1/4 sec. cor. of secs. 15 and 22, monumented with a limestone, 12x6x4 ins., firmly set marked 1/4 on the N side and witnessed by the remains of the original bearing trees.

At the corner point set an iron post, 30 ins. long, 2 1/2 ins. diam., 26 ins. in the ground, with brass cap mkd.

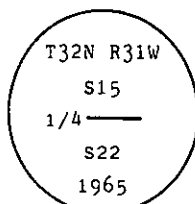

From which the original bearing trees:

- A pine, 11 ins. diam., bears N11 1/2° E, 20 lks. (13.20 ft.) dist., mkd. 1/4 S15 BT.
A stump hole, bears S40 3/4° W, 9 lks. (5.94 ft.) dist., with fallen log mkd. 1/4 S22 BT.

The new bearing trees:

- A larch, 12 ins. diam., bears S67 1/2° W, 28 lks. (18.48 ft.) dist., mkd. 1/4 S22 BT.
A cedar, 8 ins. diam., bears N44 1/2° W, 28 lks. (18.48 ft.) dist., mkd. 1/4 S15 BT.

II. Found a 2 1/2 ins. diam. iron pipe 4 ins. out of the ground with BLM brass cap mkd. as shown.

From which:

- A dead pine, 13 ins. diam., bears N13° E, 13.1 ft. dist., mkd. 1/4 S15 BT.
A fallen pine, 9 ins. diam., bears S43° W, 6.9 ft. dist., mkd. 1/4 S22 BT.
A larch, 18 ins. diam., bears S67° W, 18.7 ft. dist., healed face.
A cedar, 11 ins. diam., bears N44° W, 18.6 ft. dist., visible scribing.

III. Painted red bands around the bearing trees and attached "Land Survey Monument" and "Bearing Tree" signs.
Set a galvanized steel gaurd post with "Land Survey Marker" and Property Boundary: decals, West, 3 ft.

Magnetic declination: 20° East

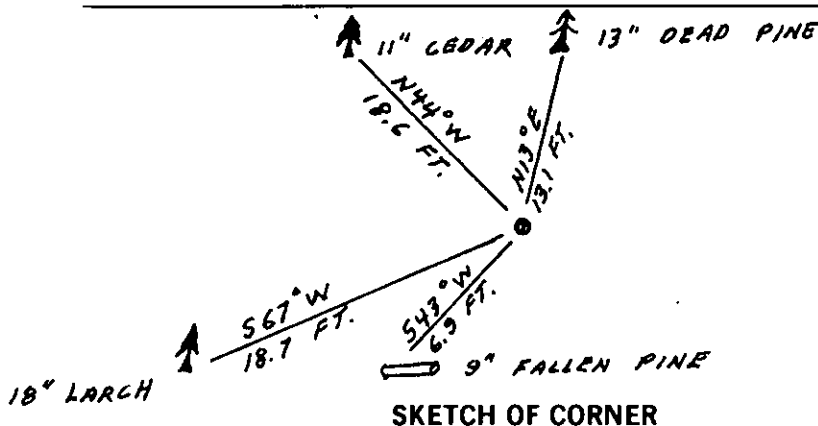

SKETCH OF CORNER



CERTIFICATION
I, Kevin A. Todd
certify the information shown herein is true and correct.
Kevin A. Todd
Signature Ground Party Chief
I, Ronald A. Pearson
certify that this Corner Record correctly represents work performed
by me or under my direction in compliance with the "Corner
Recordation Act" (70-22-101, et seq., M.C.A.)
Ronald A. Pearson
Signature of Surveyor & Seal
Date: 11/30/92 Reg. No. 9008LS
Employer: U.S. FOREST SERVICE

Office of Clerk and Recorder, County of Lincoln. This "corner
record" was filed for record on 12-15-92
was noted on the cross-index plat and is assigned page No. 5158, in
book No. Coral M Cummings by BB

County Official

N-15

32 N

31W

Cross Index No. _____ T. _____ R. _____ PMM

Sec. 15

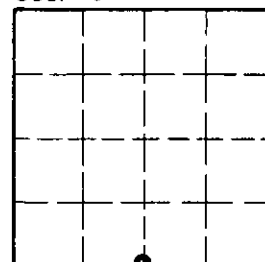

• - corner this sheet