

## INSTRUCTIONS

1. Original and/or subsequent record used to evaluate the corner position.
2. Description of evidence found, note discrepancies in the record, state method of establishing lost or obliterated corners.
3. Description of monument and accessories set to perpetuate the corner position.
4. Sketch of corner, show all pertinent data which can best be shown in a sketch example, corner marking, topography ties, position of accessories, etc.
5. Certification must be signed and sealed by Land Surveyor registered in the State of Montana.
6. Fill in Cross Index & Section Diagram at bottom of sheet.

## CERTIFIED CORNER RECORDATION

Corner SW sec. cor. S32 T. 32 N. R. 31 W. P.M.M. Lincoln County

I. 1901 GLO record by Abram L. Jaqueth: Set a stone and four bearing trees.

1964 BLM remonumentation record: The cor. of secs. 5, 6, 31, and 32, on the S bdy. of the Tp., monumented with a argillite stone, 20x12x6 ins., firmly set and mkd. as described in the official record, and witnessed by the remains of three of the original bearing trees.

At the corner point set an iron post, 30 ins. long, 2 1/2 ins. diam., 26 ins. in the ground, with brass cap mkd.

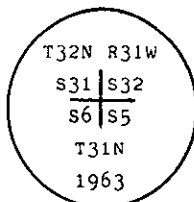

From which the remains of the original bearing trees:

- A dead larch, 18 ins. diam., bears N83° E, 142 lks. (93.72 ft.) dist., visible mks. T R3 S3 B.
- A dead larch, 16 ins. diam., bears S32 1/4° E, 88 lks. (58.08 ft.) dist., mkd. T31N R31W S5 BT.
- A dead larch, 20 ins. diam., bears S2 3/4° W, 80 lks. (52.80 ft.) dist., mkd. T 31N R31W S6 BT.

The new bearing trees:

- A larch, 6 ins. diam., bears N66° E, 33 lks. (21.78 ft.) dist., mkd. T32N R31W S32 BT.
- A larch, 8 ins. diam., bears S33 1/2° E, 44 lks. (29.04 ft.) dist., mkd. T31N R31W S5 BT.
- A pine, 7 ins. diam., bears S31 1/2° W, 49 lks. (32.34 ft.) dist., mkd. T31N R31W S6 BT.
- A pine, 6 ins. diam., bears N3/4° W, 29 lks. (19.14 ft.) dist., mkd. T32N R31W S31 BT.

II. Found a 2 1/2 ins. diam. iron pipe 4 ins. out of the ground with BLM brass cap mkd. as shown.

From which:

- A larch, 9 ins. diam., bears N66° E, 22.0 ft. dist., healed face.
- A dead larch, 18 ins. diam., bears N84° E, 94.0 ft. dist., visible scribing.
- A dead larch, 9 ins. diam., bears S32° E, 29.2 ft. dist., healed face.
- A dead larch, 16 ins. diam., bears S31° E, 58.4 ft. dist., visible scribing.
- A larch, 19 ins. diam., bears S2° W, 53.2 ft. dist., visible scribing.
- A dead pine, 8 ins. diam., bears S31° W, 32.2 ft. dist., visible scribing.
- A dead larch, 8 ins. diam., bears North, 19.3 ft. dist., healed face.

III. Established two new bearing trees:

- A fir, 7 ins. diam., bears S46° E, 13.0 ft. dist., mkd. T31N R31W S5 BT.
- A fir, 13 ins. diam., bears N70° W, 28.0 ft. dist., mkd. T32N R31W S31 BT.

Painted red bands around the bearing trees and attached "Land Survey Monument" and "Bearing Tree" signs.  
Set a galvanized steel gaurd post with "Land Survey Marker" and Property Boundary: decals, North, 3 ft.  
Magnetic declination: 20° East

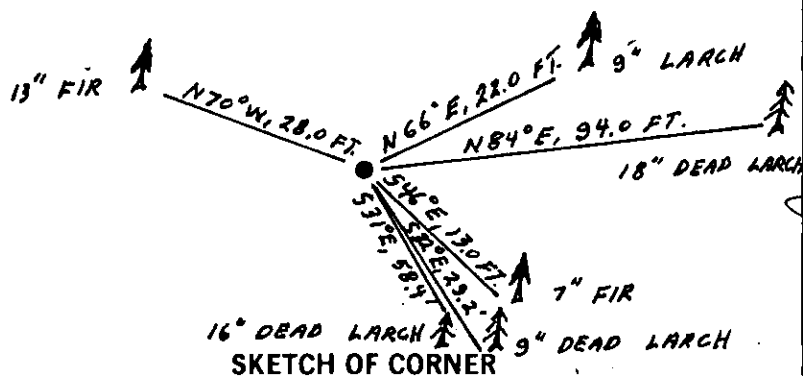
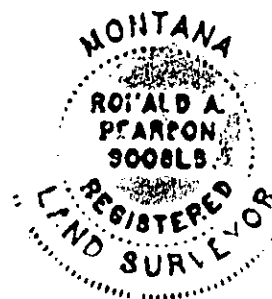

## CERTIFICATION

I, Kevin A. Todd  
certify the information shown herein is true and correct.

Kevin A. Todd  
Signature Ground Party Chief

I, Ronald A. Pearson  
certify that this Corner Record correctly represents work performed  
by me or under my direction in compliance with the "Corner  
Recordation Act" (70-22-101, et seq., M.C.A.)

Ronald A. Pearson  
Signature of Surveyor & Seal

Date: 11/30/92 Reg. No. 9008LS

Employer: U.S. FOREST SERVICE

Office of Clerk and Recorder, County of Lincoln. This "corner  
record" was filed for record on 12-15-92  
was noted on the cross-index plat and is assigned page No. 5157, in  
book No. Coral M Cummings by BLS

County Official

Cross Index No. Z-5 T. 32 N R. 31 W P.M.M.

Sec. 31

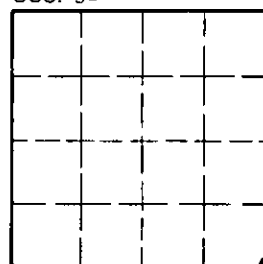

• corner this sheet