

INSTRUCTIONS

1. Original and/or subsequent record used to evaluate the corner position.
2. Description of evidence found, note discrepancies in the record, state method of establishing lost or obliterated corners.
3. Description of monument and accessories set to perpetuate the corner position.
4. Sketch of corner, show all pertinent data which can best be shown in a sketch example, corner marking, topography ties, position of accessories, etc.
5. Certification must be signed and sealed by Land Surveyor registered in the State of Montana.
6. Fill in Cross Index & Section Diagram at bottom of sheet.

CERTIFIED CORNER RECORDATION

Corner CC Secs. 4 and 5 T. 32 N. R. 31 W. P.M.M. Lincoln County

I. 1901 GLO record by Abram L. Jaqueth: Set a stone and one bearing tree.

1964 BLM remonumentation record: The closing cor. of secs. 4 and 5, monumented with a sandstone, 18x10x6 ins firmly set and mkd. with 4 grooves on the E, CC and 6 grooves on the S, and with 2 grooves on the W faces, and witnessed by the remains of one of the original bearing trees.

At the corner point set an iron post, 30 ins. long, 2 1/2 ins. diam., 27 ins. in the ground, with brass cap mkd.

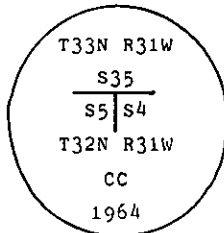

From which the remains of the original bearing tree

A dead larch, 20 ins. diam., bears S20° E. 25 lks. (16.50 ft.) dist., with a burned out blazed.

The new bearing trees:

A larch, 6 ins. diam., bears S14° E. 17 lks. (11.22 ft.) dist., mkd. T32N R31W S4 CC BT.

A fir, 6 ins. diam., bears S73° W. 44 lks. (29.04 ft.) dist., mkd. T32N R31W S5 CC BT.

II. Found a 2 1/2 ins. diam. iron pipe 6 ins. out of the ground with BLM brass cap mkd., as shown.

From which:

A dead larch, 29 ins. diam., bears S16° E. 17.0 ft. dist., visible scribing.

A larch, 12 ins. diam., bears S10° E. 11.6 ft. dist., healed face.

A dead fir, 10 ins. diam., bears S75° W. 29.3 ft. dist., healed face.

III. Established one new bearing tree:

A larch, 11 ins. diam., bears S82° W. 38.3 ft. dist., mkd. T32N R31W S5 CC BT.

Painted red bands around the bearing trees and attached "Land Survey Monument" and "Bearing Tree" signs. Set a galvanized steel gaurd post with "Land Survey Marker" and Property Boundary: decals. South. 3 ft.

Magnetic declination: 20° East

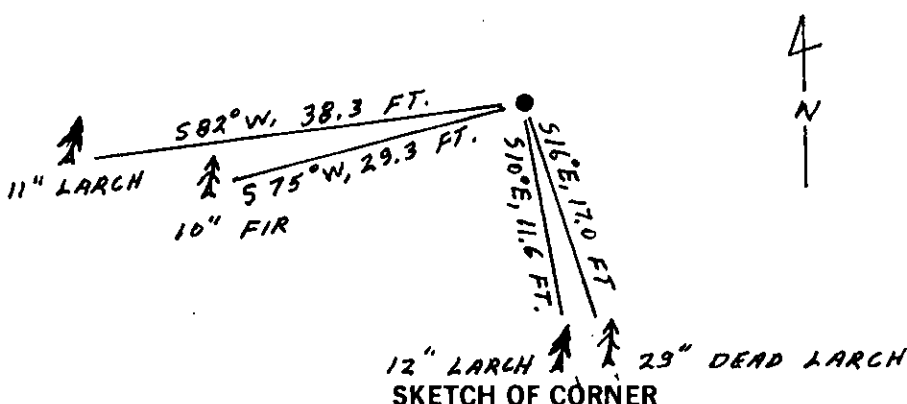

CERTIFICATION

I, Kevin A. Todd
certify the information shown herein is true and correct.

Kevin A. Todd
Signature Ground Party Chief

I, Ronald A. Pearson
certify that this Corner Record correctly represents work performed by me or under my direction in compliance with the "Corner Recordation Act" (70-22-101, et seq., M.C.A.)

Ronald A. Pearson
Signature of Surveyor & Seal

Date: 11/30/92 Reg. No. 9008LS

Employer: U.S. FOREST SERVICE

Office of Clerk and Recorder, County of Lincoln. This "corner record" was filed for record on 12-15-92 was noted on the cross-index plat and is assigned page No. 5156, in book No. Coral M Cummings by B.B.

County Official

A-9

32 N 31 W

Cross Index No. _____ T. _____ R. _____ PMM

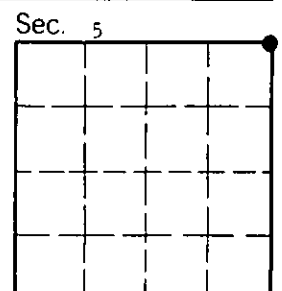

• - corner this sheet