

## INSTRUCTIONS

1. Original and/or subsequent record used to evaluate the corner position.
2. Description of evidence found, note discrepancies in the record, state method of establishing lost or obliterated corners.
3. Description of monument and accessories set to perpetuate the corner position.
4. Sketch of corner, show all pertinent data which can best be shown in a sketch example, corner marking, topography ties, position of accessories, etc.
5. Certification must be signed and sealed by Land Surveyor registered in the State of Montana.
6. Fill in Cross Index & Section Diagram at bottom of sheet.

## CERTIFIED CORNER RECORDATION

Corner CE 1/16 S9 T. 32N R. 31W P.M.M. LINCOLN County

1) NO ORIGINAL EVIDENCE/RECORD

2) NONE

3) SET 3 1/2" ALUMINUM CAP ON 3/4" ROD FROM WHICH:

A 11" DBH. L.P. PINE BEARS S61°W 2.1 FT (B.T.)  
C-E 1/16 S9 BT

A 6" DBH. CEDAR BEARS S15°W 25.7 FT (B.T.)  
C-E 1/16 S9 BT

SCRIBES AND 6" BANDS PAINTED RED.

SET STEEL POST BEARS 0.9 SWLY.

BT. TAGS AND SURVEY MONUMENT SIGNS ATTACHED TO BEARING TREES.

LOCATION POSTER ON S" CEDAR SELLY.

ROCK MOUND.

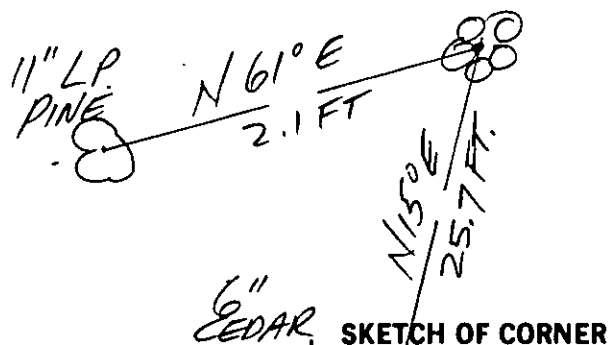

## CERTIFICATION

I, [Signature] certify the information shown herein is true and correct.

Signature Ground Party Chief

I, ERARD E. BUNTON certify that this Corner Record correctly represents work performed by me or under my direction in compliance with the "Corner Recordation Act" (70-2210, 2nd Sec., MCA).

Signature of Surveyor & Seal

Date: 8/29/85 Reg. No. 4774-S

Employer: BUNTON'S TECH. SVCS., INC.

Office of Clerk and Recorder, County of Lincoln. This "corner record" was filed for record on Sept 10, 1985

was noted on the cross-index plat and is assigned page No. 3072, in

book No. \_\_\_\_\_

[Signature]  
County Official

Sec. 9

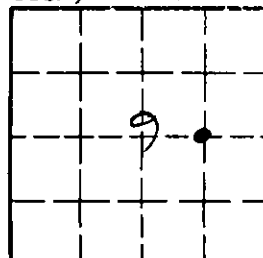

Cross Index No. \_\_\_\_\_ T. \_\_\_\_\_ R. \_\_\_\_\_ P.M.M.

• corner this sheet