

# CERTIFIED CORNER RECORDATION

Corner W 1/4 S4 T 32 N. R. 31 W. P.M.M. Lincoln County

I. Record: 1901 GLO survey by Abram L. Jaqueth: Set a limestone 18x8x6 ins. 12 ins. in the ground, for 1/4 sec. cor. marked 1/4 on W. face, from which:

- A cedar 16 ins. diam., bears N60°E., 10 lks. dist., (6.60 ft), mkd. 1/4 S4 BT.
- A white pine, 20 ins. diam., bears S.84°W., 52 lks. dist., (34.32 ft.), mkd. 1/4 S5 BT.

II. Found: Found a limestone 18x8x6 ins., 15 ins. in the ground, mkd. 1/4 on the W. face from which:

- A cedar stump, 20 ins. diam., bears N.60°E. 7.00 ft. dist., with visible face.
- A pine stump, 24 ins. diam., bears S.84°W., 34.50 ft. dist., with visible face.

III. Perpetuation: At a point determined from the original bearing trees, we set a Alum. pipe 2 1/2 ins. diam., 30 ins. long 24 ins. in the ground, with a 3 1/4 ins. diam. Alum. cap marked as shown below from which:

- A hemlock, 11 ins. diam., bears N.90°E., 15.50 ft. dist., scribed 1/4 S4 BT.
- A white pine 10 ins. diam., bears N.55°E., 20.10 ft. dist., scribed 1/4 S4 BT. (Note: no suitable trees within 250.00 ft. to set bearing tree in Sec. 5).

Painted faces and 6 in. wide red bands to all bearing trees and attached Land Survey Monument and Bearing Tree signs.

Magnetic declination: 20° East assumed

Equipment used: Hand compass and loggers tape

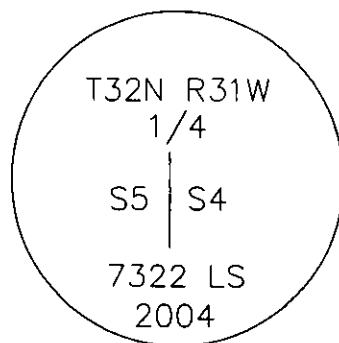

Kootenai Surveyors Inc., 314 California Av., Libby, MT. 59923 (406) 293-4354

KSI Project: Pipe Cr. - PCTC

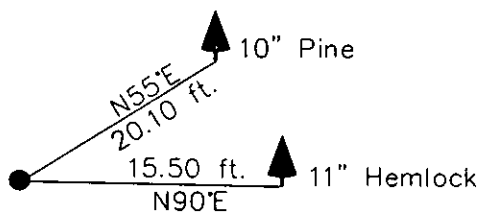

SKETCH OF CORNER

## CERTIFICATION

I, Kenneth R. Kern  
certify the information shown herein is true and correct.  
Kenneth Kern  
Signature Ground Party Chief

I, Alvah F. Hughes  
certify that this Corner Record correctly represents work performed by me or under my direction in compliance with the "Corner Recordation Act" (70-22-101, et seq., M.C.A.)  
Alvah F. Hughes  
Signature of Surveyor & Seal

Date: 12/27/2004 Reg. No. 7322-LS

Employer: Kootenai Surveyors Inc.

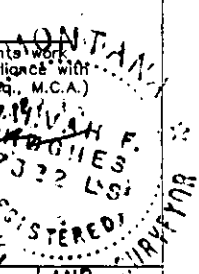

Office of Clerk and Recorder, County of Lincoln. This "corner

record" was filed for record on \_\_\_\_\_

was noted on the cross-index \_\_\_\_\_

book No. \_\_\_\_\_

188879 BOOK: CCR CC&R'S PAGE: 10862 Pages: 1

STATE OF MONTANA LINCOLN COUNTY

RECORDED: 10/18/2005 8:43 KOI: CC&R'S

CORAL M. CUMMINGS CLERK AND RECORDER

FEE: \$0.00

BY: Coral M. Cummings

TO: KOOTENAI SURVEYORS INC. P.O. BOX 393, LIBBY, MT 59923

Cross Index No. C 09 T. 32N R. 31W P.M., MT

Adopted July 1, 1981, Montana Board of Professional Engineers & Land Surveyors

• corner this sheet

