

CERTIFIED CORNER RECORDATION

CORNER NE CORNER SEC. 7 T. 32N R. 30W P.M.M., LINCOLN COUNTY

FOUND: 3 1/4" BLM BRASS CAP STAMPED AS SHOWN, FROM WHICH;

- 20" FIR BEARS N36°E, 45.60' SCRIBED T32N R30W S5 BT.
- 15" WHITEFIR BEARS S56°E, 25.30' WITH SOME SCRIBE.
- 15" WHITEFIR BEARS S27°W, 22.20' SCRIBED T32N R30W S7 BT.
- 30" LARCH BEARS N17°W, 7.10' WITH SOME SCRIBE.

MAINTENANCE: REMOVED BRUSH AND TREE LIMBS FROM CORNER AREA.
SET STEEL POST 3 FEET WEST OF CORNER, PAINTED RED BANDS ON BT'S.

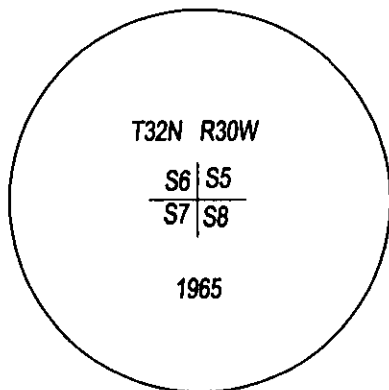
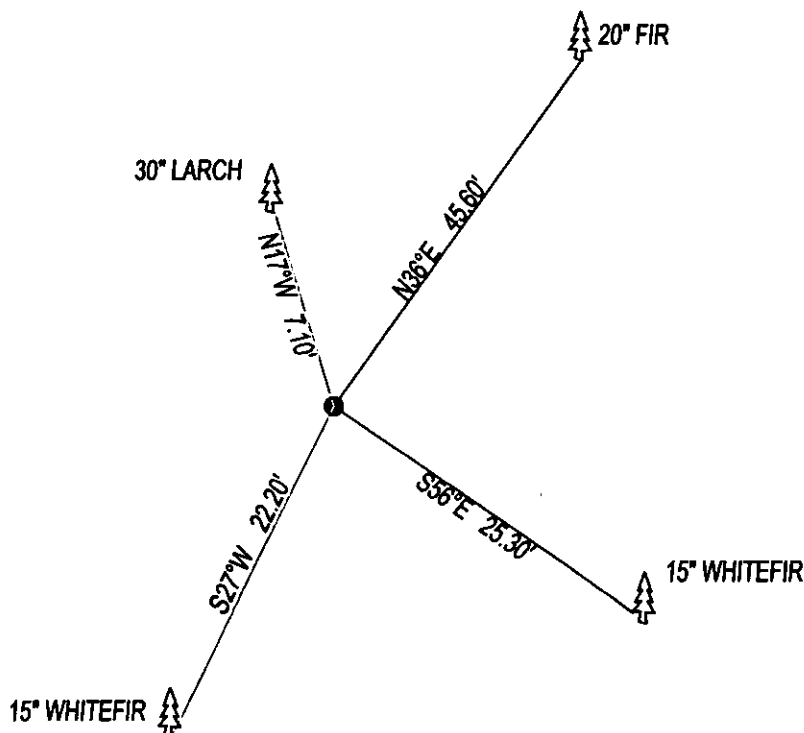

SKETCH OF CORNER

CERTIFICATION

I, DAN CROFT
CERTIFY THE INFORMATION SHOWN HEREIN IS TRUE AND CORRECT.

SIGNATURE GROUND PARTY CHIEF

I, MARC J. CARSTENS
CERTIFY THAT THIS CORNER RECORD CORRECTLY REPRESENTS WORK
PERFORMED BY ME OR UNDER MY DIRECTION IN COMPLIANCE WITH THE
"CORNER RECORDATION ACT" (70-22-101, ET SEQ., M.C.A.)

[Signature]
SIGNATURE OF SURVEYOR & SEAL

10-14-13

DATE

CARSTENS SURVEYING

EMPLOYER

5940LS
REG. NO.

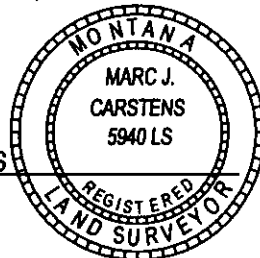

OFFICE OF CLERK AND RECORDER, COUNTY OF LINCOLN
THIS 248107 BOOK: CCR CC&R'S PAGE: 12083 Pages: 1
STATE OF MONTANA LINCOLN COUNTY
AND RECORDED: 10/25/2013 12:25 KOI: CC&R'S
TAMMY D. LAUER CLERK AND RECORDER
FEE: \$0.00 BY: [Signature]
COU FOR: CARSTENS LAND SURVEYING
CROSS INDEX NO. E-5 T. 32N R. 30W P.M.M.
ADOPTED JULY 1, 1981, MONTANA BOARD OF PROFESSIONAL ENGINEERS & LAND SURVEYORS

SEC. 7

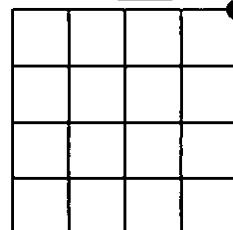

● CORNER THIS SHEET