

CERTIFIED LAND CORNER RECORDATION
(REFERENCE FSM 7153.53)

DESCRIPTION OF CORNER EVIDENCE FOUND, AND ORIGINAL RECORD (IF KNOWN)

Found (record-set) a trachite stone, 27"x12"x12", 20" in ground, marked 1/4 on W face.

From which: A tamarack (alive) 24" diameter, bears N41 1/4°E, 101 links distance, marked 1/4 S28 BT. (REC.)

A tamarack (stump), 28" diameter, bears N17 1/4°W, 93 links distance, marked 1/4 S29 BT. (REC.)

Found stone in place and both BT's at record bearing and distance. Set pipe at corner point.

DESCRIPTION OF MONUMENT AND ACCESSORIES ESTABLISHED TO PERPETUATE THE ORIGINAL LOCATION OF THIS CORNER:

Set a 2 1/2" iron pipe, 30" long, 18" in ground to solid bedrock, with brass cap marked. Buried original stone alongside iron pipe and raised a mound of stone, 3 1/2' base to top of cap.

Date of work: 1978

New BT: A pine, 8" diameter, bears N18°W, 76 links distance, marked 1/4 S29 BT.

Location poster bears N54°E, 20 links distance.

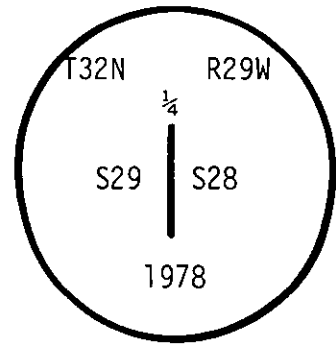

SKETCH, WITH COURSE AND DISTANCE TO ADJACENT CORNERS IF DETERMINED IN THIS SURVEY.
(MAY SKETCH OR PASTE REPRODUCTION ON REVERSE SIDE.)

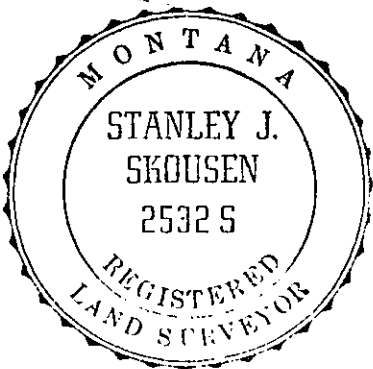
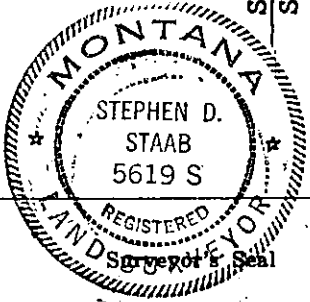
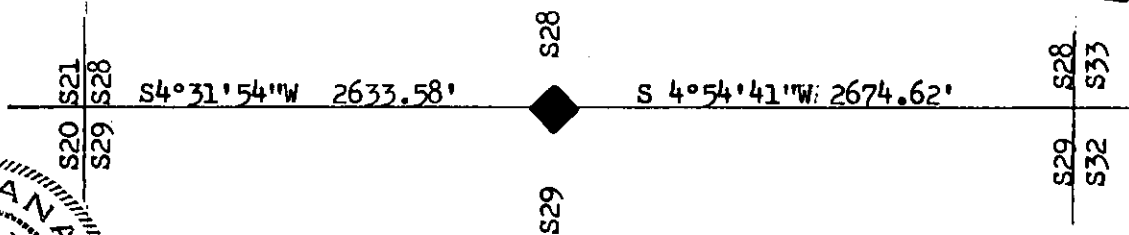
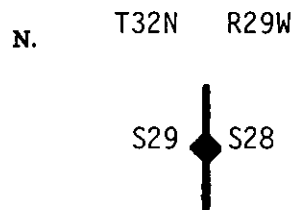

DIAGRAM OF CORNER:



I, Stephen D. Staab Mt. 5619 S
certify that the information shown herein is true and correct.

Stephen D. Staab
Signature of Ground Party Chief

I, Stanley J. Skousen
certify that I have carefully performed or reviewed the work done on the diagrammed corner as reported on this recordation form and approve the same.

Stanley J. Skousen
Signature of Surveyor

◆ = Corner recorded on the sheet

2532S
Registration Number

Office of Clerk and Recorder, County of Lincoln

This "corner record" was filed for record on the 5th day of March, 1980, was noted on the cross-index plat and is assigned page No. 748, in book No. 1

Deason L. Vaughan by Betty Lee
County Official Deputy

Cross Index No. T-9 T. 32N R. 29W Mer.