

CERTIFIED LAND CORNER RECORDATION
(REFERENCE FSM 7153.53)

DESCRIPTION OF CORNER EVIDENCE FOUND, AND ORIGINAL RECORD (IF KNOWN)

NONE FOUND

DESCRIPTION OF MONUMENT AND ACCESSORIES ESTABLISHED
TO PERPETUATE THE ORIGINAL LOCATION OF THIS CORNER:

Date of work: 1978

Set a 2 1/2" X 30" Aluminum pipe with cap at proportionate point marked:

From which a 10" Tamarack, S 59° W, 25.6 feet, scribed 1/4 S19 BT
16" Tamarack, S 70° E, 38.7 feet, scribed 1/4 S20 BT

Placed BT signs and painted a red band around trees.
Placed a fiberglass post next to corner with Forest Boundary and
Attention signs attached.

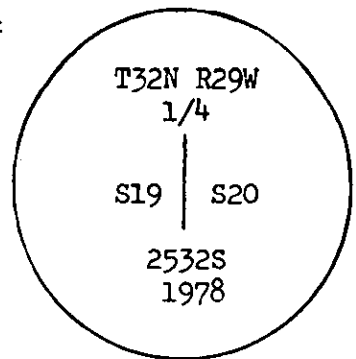

SKETCH, WITH COURSE AND DISTANCE TO ADJACENT CORNERS IF DETERMINED IN THIS SURVEY.
(MAY SKETCH OR PASTE REPRODUCTION ON REVERSE SIDE.)

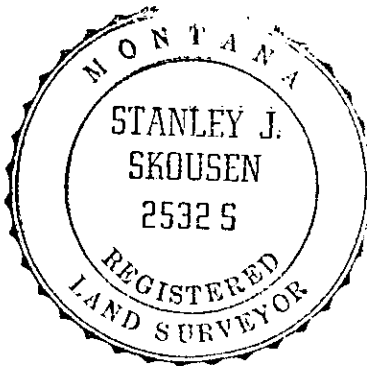
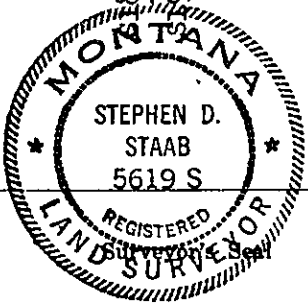
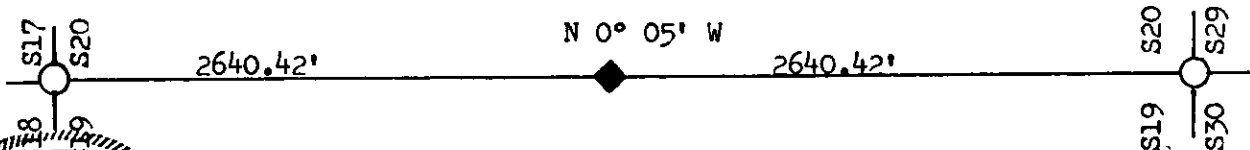

I, Stephen D Staab 5619S
certify that the information shown herein is true and
correct.

Stephen D Staab
Signature of Ground Party Chief

I, Stanley J. Skousen
certify that I have carefully performed or reviewed the
work done on the diagrammed corner as reported on this
recording form and approve the same.

Stanley J. Skousen
Signature of Surveyor

DIAGRAM OF CORNER:

N. T32N R29W S19

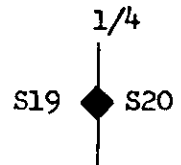

◆ = Corner recorded on the sheet

2532S
Registration Number

Office of Clerk and Recorder, County of Lincoln

This "corner record" was filed for record on the 5th day of March 1980, was noted on the cross-index plat and is
assigned page No. 743, in book No. 1

Cross Index No. P 5 T. 32N R. 29W Mer.