

CERTIFIED CORNER RECORDATION

Corner $1\frac{3}{4}$ $\frac{3}{10}$ T. 32 N. R. 29 W. P.M.M. Lincoln County

RECORD - 1902 GLO SURVEY

SET A TRACHITE STONE 20 X 10 X 3 INS. 15 INS. IN THE GROUND, MARKED '1/4' ON NORTH FACE; FROM WHICH
A 5 INS. DIAM. PINE MARKED '1/4 S 3 BT' BEARS N51°E 38 LKS.
A 8 INS. DIAM. PINE MARKED '1/4 S 10 BT' BEARS S68°30'E 34 LKS.

RECORD - 1939 GLO SURVEY

FOUND ORIGINAL STONE; REPLACED WITH IRON POST AND BRASS CAP, FROM WHICH

FOUND

GLO BRASS CAP AND REFERENCES AS SHOWN BELOW.

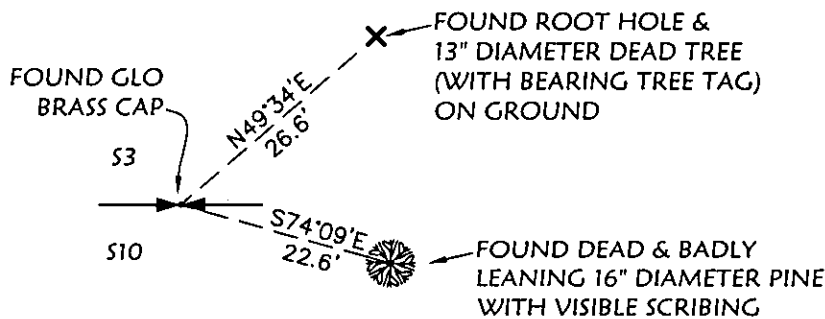

Not to Scale

Basis of bearings: South
line of Section 10 taken
as N89°56'W per
original GLO survey.

SKETCH OF CORNER

CERTIFICATION

I, Brian Parnell
certify the information shown herein is true and correct.

Brian Parnell
Signature Ground Party Chief

I, Dawn Marquardt
certify that this Corner Record correctly represents work
performed by me or under my direction in compliance with
the "Corner Recordation Act" (70-22-10, et seq., M.C.A.)

Dawn Marquardt
Signature of Surveyor

Date: 1-11-07 Reg. No. 73285 7328 LS
Employer: Marquardt & Marquardt Surveyors, Inc.

STATE OF MONTANA
Dawn Marquardt
REGISTERED SURVEYOR
73285 7328 LS

Office of Clerk and Recorder, County of Lincoln. This "corner
record" was filed for record

was noted on the cross-index

Book No. _____

200606 BOOK: CCR CC&R'S PAGE: 10992 Pages: 1
STATE OF MONTANA LINCOLN COUNTY
RECORDED: 01/29/2007 9:20 KOI: CC&R'S
TAMMY D. LAUER CLERK AND RECORDER
FEE: \$0.00 BY: Heather Lauer
TO: MARQUARDT SURVEYING, INC. 285 1ST. AVE. E.N., KALISPELL

Cross Index No. E-15 T. 32 N. R. 29 W. PMM

Adopted July 1, 1981, Montana Board of Professional Engineers & Land Surveyors

Sec. 10

corner this sheet