

CERTIFIED CORNER RECORDATION

Corner N 1/4 cor. of Sec. 22 T 32 N. R. 29 W. P.M.M. LINCOLN County

I. Record: 1902 GLO survey by Bickel & Filer: Set a stone 24x12x3 ins., 18 ins. in the ground from which:

A pine, 14 ins. diam., bears N.54°E., 72 lks. dist. (47.52 ft.).

A tamarack, 12 ins. diam., bears S.22°W., 71 lks. dist. (46.86 ft.).

II. Found: No monument or related accessories were found.

III. Perpetuation: At the calculated position from survey, set a 2 1/2 ins. diam. x 30 ins. long aluminum pipe with a 3 1/4 in. diam. U.S. Forest Service aluminum cap, 21 ins. in the ground, marked as shown:

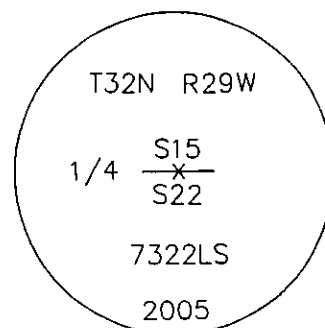

From which:

A fir, 9 ins. diam., bears S.16°E., 11.5 ft. dist., scribed 1/4 S22 BT.

A fir, 11 ins. diam., bears N.82°W., 9.6 ft. dist., scribed 1/4 S15 BT.

Set a 6 ft. galvanized steel post 3 ft. east of corner and attach Land Survey Monument and Property Boundary decals.

Painted 6 in. wide red bands around all Bearing trees and attached Bearing tree and Land Survey Monument signs.

Magnetic declination: 18° East

Equipment used: Hand compass and loggers tape

Kootenai Surveyors Inc., 314 California Av., Libby, MT. 59923 (406) 293-4354

Greased Lightening - PCTC

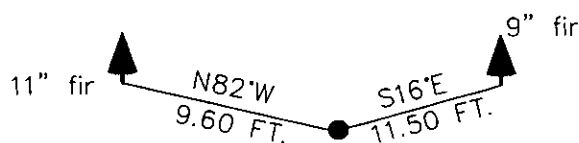

CERTIFICATION

I, Kenneth R. Kern certify the information shown herein is true and correct.

Signature Ground Party Chief

I, Alvah F. Hughes certify that this Corner Record correctly represents work performed by me or under my direction in compliance with the "Corner Recordation Act" (70-22-101, et seq., M.C.A.)

Signature of Surveyor & Sec

Date: 6/23/2005 Reg. No. 7322-LS

Employer: Kootenai Surveyors Inc.

SKETCH OF CORNER

Office of Clerk and Recorder, County of Lincoln This "corner

record" was filed for record

was noted on the cross-ind

book No. _____

186106 BOOK: CCR CC&R'S PAGE: 10829 Pages: 1
STATE OF MONTANA LINCOLN COUNTY
RECORDED: 07/19/2005 8:36 KOI: CC&R'S
CORAL M. CUMMINGS CLERK AND RECORDER
FEE: \$0.00 BY: Debbie L. Langer
TO: FILED

Cross Index No. N - 15 T. 32N. R. 29W. P.M., MT

Adopted July 1, 1981, Montana Board of Professional Engineers & Land Surveyors

