

# CERTIFIED CORNER RECORDATION

Corner S 1/4 cor. of Sec. 31 T 32 N. R. 29 W. P.M.M. LINCOLN County

I. Record: 1898 GLO survey by Bickel: Set a granite stone 20x10x6 ins., 15 ins. in the ground from which:

- A fir, 10 ins. diam., bears N.50°20'W., 42 lks. dist. (27.72 ft.).
- A fir, 12 ins. diam., bears S.31°20'W., 42 lks. dist. (27.72 ft.).

II. Found: No corner monument found.

Accessories: Found fir stump, partially rotted, bears S30°W, 27.7 ft., dist., from a computed location as determined by survey, visible face and visible scribes (orig, GLO bearing tree, 1898)

III. Perpetuation: At a point, determined from the remains of B.T. stump, set a 2 1/2" x 30" long aluminum pipe with a 3 1/4" diam. USFS aluminum cap, N.31°E, 27.72 ft., dist., marked as shown:

Raise a 24" diam., rock collar around monument.

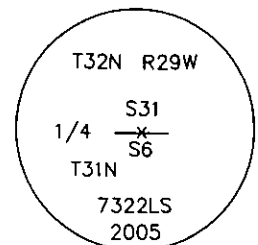

From which:

- A lodgepole pine, 7 ins. diam., bears N.55°E., 39.8 ft. dist., scribed 1/4 S31 BT.
- A fir, 11.5 ins. diam., bears S.50°E., 38.0 ft. dist., scribed 1/4 S6 BT.

Set a 6 ft. galvanized steel post 2 ft. West of corner and attached Land Survey Monument and Property Boundary decals.

Painted 6 in. wide red bands around all Bearing Trees and attached Bearing Tree and Land Survey Monument signs.

Magnetic declination: 18° East

Equipment used: Hand compass and loggers tape

Kootenai Surveyors Inc., 314 California Av., Libby, MT. 59923 (406) 293-4354

## Jackson Creek - PCTC

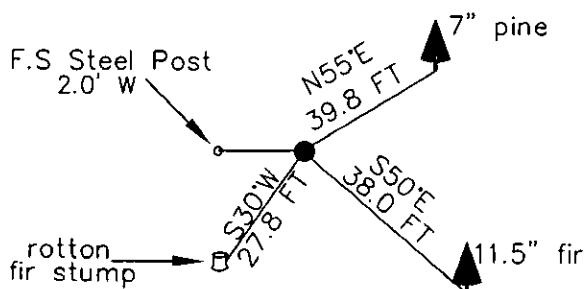

## SKETCH OF CORNER

## CERTIFICATION

I, Kenneth R. Kern  
certify the information shown herein is true and correct.  
Signature Ground Party Chief

I, Alvah F. Hughes  
certify that this Corner Record correctly represents work performed by me or under my direction in compliance with the "Corner Recordation Act" (70-22-101, et seq.)  
Signature of Surveyor & Seal

Date: 7/13/2005 Reg. No. 7322-LS

Employer: Kootenai Surveyors Inc.

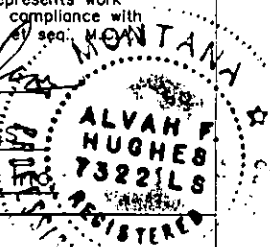

Office of Clerk and Recorder, County of Lincoln. This "corner

record" was filed for record on

186102 BOOK: CCR CC&R'S PAGE: 10825 Pages: 1

was noted on the cross-index

STATE OF MONTANA LINCOLN COUNTY

book No. \_\_\_\_\_

RECORDED: 07/19/2005 8:32 KOI: CC&R'S

CORAL M. CUMMINGS CLERK AND RECORDER

FEE: \$0.00

BY: Debbie L. Smith Deputy

TO: FILED

Cross Index No. Z - 03 T. 32N. R. 29W. P.M., MT

Adopted July 1, 1981, Montana Board of Professional Engineers & Land Surveyors

Sec. 31

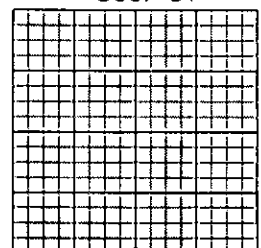

• corner this sheet