

CERTIFIED CORNER RECORDATION

Corner C 1/4 cor. of Sec. 22 T 32 N. R. 29 W. P.M.M. LINCOLN County

I. Record: No previous record.

II. Found: No evidence found during a field search of area.

III. Perpetuation: At the calculated position from survey, set a 3 1/4 in. diam. U.S. Forest Service aluminum cap on a 5/8 in. diameter x 24 ins. long rebar, 21 ins. in the ground, set 0.50" above ground. Raise a collar of stone to the top, marked as shown:

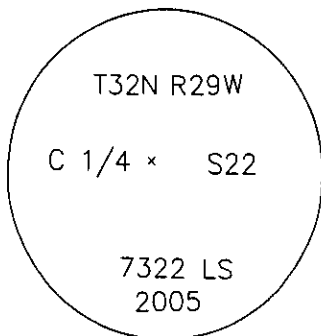

From which:

A larch, 15 ins. diam., bears S.33°E., 3.60 ft. dist., scribed C 1/4 S22 BT.
A larch, 18.5 ins. diam., bears N.20°E., 23.0 ft. dist., scribed C 1/4 S22 BT.

Set a 6 ft. galvanized steel post 3 ft. East of corner and attached Land Survey Monument and Property Boundary decals.

Painted 6 in. wide red bands around all bearing trees and attached new Bearing Tree and Land Survey Monument signs on back of all bearing trees.

Magnetic declination: 18°East

Equipment used: Hand compass and loggers tape

Kootenai Surveyors Inc., 314 California Av., Libby, MT. 59923 (406) 293-4354

Greased Lightning - PCTC

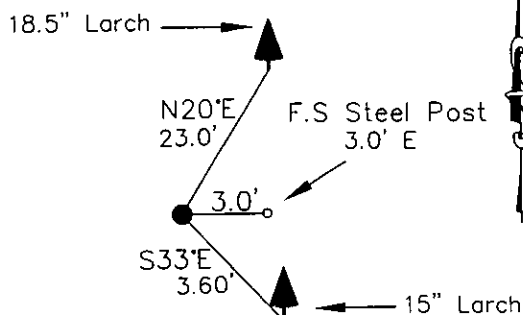

CERTIFICATION

I, Peter Landis
certify the information shown herein is true and correct.

Peter Landis
Signature Ground Party Chief

I, Alvah F. Hughes
certify that this Corner Record correctly represents work performed by me or under my direction in compliance with the "Corner Recordation Act" (70-22-101, et seq., M.C.A.)

Alvah F. Hughes
Signature of Surveyor & Seal

Date: 6/28/05 Reg. No. 7322-LS

Kootenai Surveyors Inc.

Employer: _____

SKETCH OF CORNER

Office of Clerk and Recorder, County of Lincoln This "corner

record" was filed for record on

was noted on the cross-in-

book No. _____

186101 BOOK: CCR CC&R'S PAGE: 10824 Pages: 1

STATE OF MONTANA LINCOLN COUNTY

RECORDED: 07/19/2005 8:31 KOI: CC&R'S

CORAL M. CUMMINGS CLERK AND RECORDER

FEE: \$0.00

TO: FILED

BY: Alvah F. Hughes

Cross Index No. P - 15 T. 32N. R. 29W. P.M., MT

Adopted July 1, 1981, Montana Board of Professional Engineers & Land Surveyors

Sec. 22

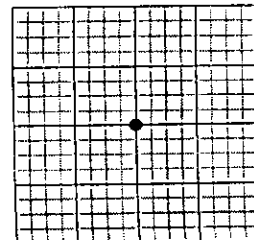

• corner this sheet