

CERTIFIED CORNER RECORDATION

Corner S 1/16 Sec. 24 T. 32N R. 29W P.M., MT Lincoln County

- I. No history found.
- II. No evidence found.
- III. Set by survey, an aluminum rod, 30 ins. long, 3/4 in. diam., 27 ins. in the ground, with a 3 1/4 in. diam. aluminum cap mkd. as shown below:

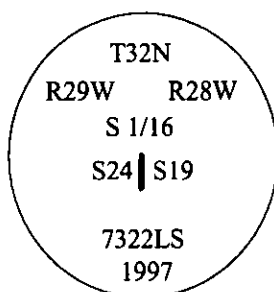

Established two bearing trees:

- A fir, 7 ins. diam., bears S35°E, 10.6 ft. dist., mkd. "S 1/16 S19 BT".
- A pine, 8 ins. diam., bears S48°W, 19.7 ft. dist., mkd. "S 1/16 S24 BT".

Set a 6 ft. galvanized steel guard post, West, 3.0 ft. dist. with Property Boundary and Land Survey Monument decals attached.
Painted bearing trees and attached Land Survey Monument and Bearing Tree signs.

Magnetic Declination: 20° East.

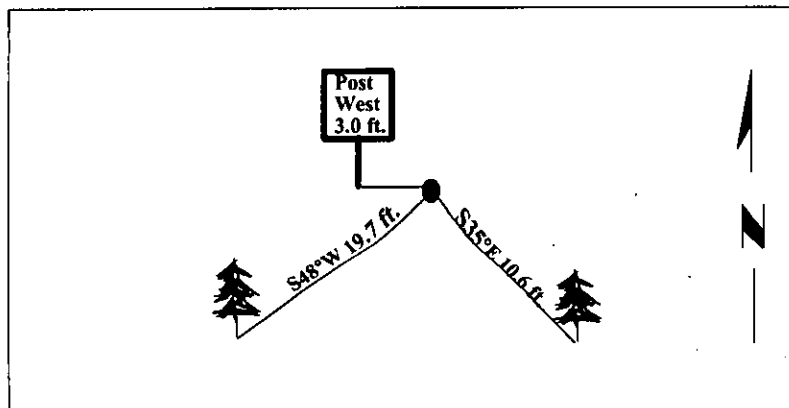

SKETCH OF CORNER

CERTIFICATION	
I. <u>Mark Federman</u>	certify the information shown herein is true and correct.
I. <u>Alvah F. Hughes</u>	certify that this Corner Record correctly represents work performed by me or under my direction in compliance with the "Corner Recordation Act" (70-22-101, et seq., M.C.A.)
Date: <u>11/13/97</u>	Signature of Surveyor & Seal
Reg. No.: <u>7322LS</u>	
Employer: <u>U.S. FOREST SERVICE</u>	

Office of Clerk and Recorder, County of Lincoln. This "corner record" was filed for record on 12-26-97 was noted on the cross-index plat and is assigned page No. 10025 in book No. _____

County Official

Sec. 24

● - corner this sheet