

INSTRUCTIONS

1. Original and/or subsequent record used to evaluate the corner position.
2. Description of evidence found, note discrepancies in the record, state method of establishing lost or obliterated corners.
3. Description of monument and accessories set to perpetuate the corner position.
4. Sketch of corner, show all pertinent data which can best be shown in a sketch example, corner marking, topography ties, position of accessories, etc.
5. Certification must be signed and sealed by Land Surveyor registered in the State of Montana.
6. Fill in Cross Index & Section Diagram at bottom of sheet.

CERTIFIED CORNER RECORDATION

Corner of Secs. 29, 30, 31, 32 T. 32 N., R. 28 W., P.M.M. Lincoln County

- I. 1911 original G.L.O. record by William C. Perkins: "Set a limestone, 18 x 8 x 6 ins., 14 ins. in the ground, for cor. of secs. 29, 30, 31 and 32, marked with 5 notches on E. and 1 notch on S. edge; from which

A fir, 6 ins. in diam., bears N54° E, 40 lks. dist., marked T32N R28W S29 BT.
 A fir, 10 ins. in diam., bears S65° E, 20 lks. dist., marked T32N R28W S32 BT.
 A tamarack, 8 ins. in diam., bears S13° W, 44 lks. dist., marked T32N R28W S31 BT.
 A fir, 12 ins. in diam., bears N23° W, 36 lks. dist., marked T32N R28W S30 BT."

1967 recordation by Ira M. Tillotson (Reg. No. 858 ES): "We double blaze a 7" pine which bears S70° W, 29.0 feet from the original monument, scribed RM."

- II. Found a stone, 18 x 8 x 6 ins., 8 ins. out of the ground, mkd. 5 notches on E. and 1 notch on S. edge, from which

A fir, 21 ins. diam., bears N54° E, 26.6 ft. (40 lks.) dist., scribe overgrown (G.L.O. rcd.)
 A fir, 25 ins. diam., bears S62° E, 12.3 ft. (19 lks.) dist., scribe overgrown (G.L.O. rcd.)
 A dead pine, 11 ins. diam., bears S61° W (rd: S70° W), 29.3 ft. (44 lks.) dist., mkd. RM (Tillotson rcd.)
 A decayed log, bears S13° W, 29.0 ft. (44 lks.) dist., scribe visible (G.L.O. rcd.)
 A fir, 20 ins. diam., bears N19° W, 23.9 ft. (36 lks.).. mkd. 32 28 S3 BT (G.L.O. rcd.)

- III. At the corner point, set a 2 1/2 ins. diam. aluminum pipe, 30 ins. long, 26 ins. in the ground with attached 3 1/4 ins. diam. U.S.D.A. Forest Service aluminum cap, marked as shown:

T32N R28W
 S30 | S29
 S31 | S32
 9008-LS
 1990

Established one new bearing tree:

A fir, 15 ins. diam., bears S77° W, 22.8 ft. dist., mkd. T32N R28W S31 BT.

Painted a red band around each bearing tree and attached "Land Survey Monument" and "Bearing Tree" signs where needed.

Set a guard post, with a "Survey Marker" decal attached, 3 ft. N. from corner.

Magnetic Declination: East, 19°

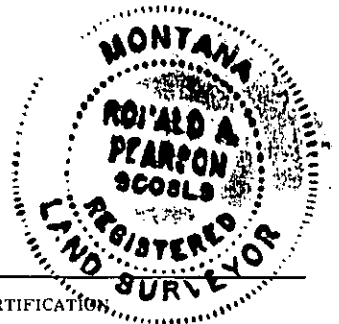

CERTIFICATION

- I. Raymond Pederson
 certify the information shown herein is true and correct.

Raymond Pederson
 Signature Ground Party Chief

- I. Ronald A. Pearson
 certify that this Corner Record correctly represents work performed by me or under my direction in compliance with the "Corner Recordation Act" (70-22-101, et seq., M.C.A.)

Ronald A. Pearson
 Signature of Surveyor & Seal

Date: 11/26/90 Reg. No. 9008LS
 Employer: U.S. FOREST SERVICE

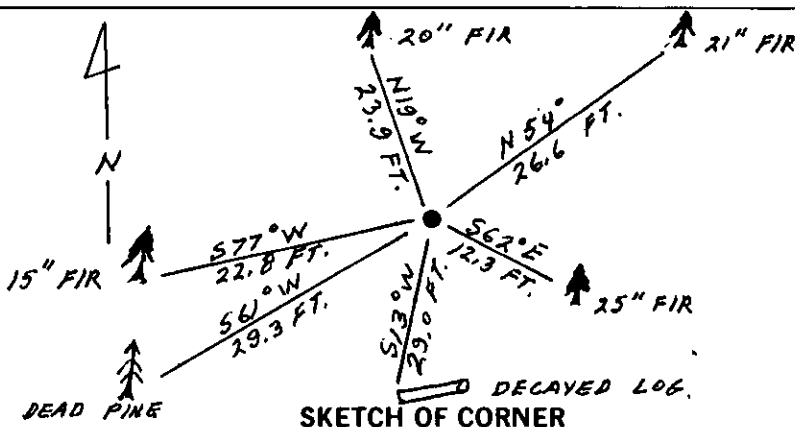

SKETCH OF CORNER

Office of Clerk and Recorder, County of Lincoln. This "corner record" was filed for record on Dec 10, 1990 was noted on the cross-index plat and is assigned page No. 4359, in book No. _____

Grant E. Sigel by Bill Buckhoff
 County Official

V 5

32 N 28 W

Cross Index No. _____ T. _____ R. _____ PMM

Sec. 29

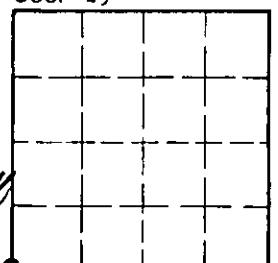

• - corner this sheet