

INSTRUCTIONS

1. Original and/or subsequent record used to evaluate the corner position.
2. Description of evidence found, note discrepancies in the record, state method of establishing lost or obliterated corners.
3. Description of monument and accessories set to perpetuate the corner position.
4. Sketch of corner, show all pertinent data which can best be shown in a sketch example, corner marking, topography ties, position of accessories, etc.
5. Certification must be signed and sealed by Land Surveyor registered in the State of Montana.
6. Fill in Cross Index & Section Diagram at bottom of sheet.

CERTIFIED CORNER RECORDATION

Cor. of Secs. 30 & 31 32 N. 28 W.
Corner Secs. 25 & 36 T. 32 N. R. 29 W. P.M.M. Lincoln County

I. 1902 original G.L.O. record by Paul S. A. Bickel et al: Set a stone monument and four fir bearing trees.

1976 B.L.M. remonumentation record by Joseph E. French: "The cor. of secs. 25, 30, 31 and 36, on the W. bdy. of the Tp., monumented with a trachyte stone, 24 x 11 x 8 ins., firmly set 18 ins. in the ground, mkd. 1 notch on the S. and 5 notches on the N. edges, and witnessed by the remains of the original bearing trees:

A fir stump, 20 ins. diam., bears N41 1/2° E, 63 lks. dist., with the bottom portion of a blaze visible.
A fir stump, 20 ins. diam., bears S38 1/2° E, 53 lks. dist., with an overgrown blaze.
A stump hole, bears S61° W, 48 lks. dist., with a fir, 16 ins. diam., mkd. T32N R29W S36 BT, lying alongside.

At the corner point; set an iron post, 30 ins. long, 2 1/2 ins. diam., 24 ins. in the ground, with brass cap mkd.

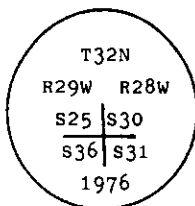

from which new bearing trees:

- A larch, 8 ins. diam., bears N46 1/2° E, 53 lks. dist., mkd. T32N R28W S30 BT.
- A larch, 7 ins. diam., bears S55 1/2° E, 40 lks. dist., mkd. T32N R28W S31 BT.
- A fir, 7 ins. diam., bears S33° W, 33 lks. dist., mkd. T32N R29W S36 BT.
- A larch, 6 ins. diam., bears N73° W, 24 lks. dist., mkd. T32N R29W S25 BT.

Bury the original stone alongside and raise a flat mound of stone, 2 ft. diam., around the iron post."

II. Found a 2 1/2 in. diam. iron pipe, 8 ins. out of the ground with attached 3 1/4 ins. diam. B.L.M. brass cap mkd. as shown above, from which

- A stump, bears N39° W, 42.8 ft. (65 lks.) dist. (G.L.O. rcd.)
- A stump, bears N41° E, 41.6 ft. (63 lks.) dist., partial scribe visible. (G.L.O. rcd.)
- A larch, 14 ins. diam., bears N32° E, 24.2 ft. dist., healed face (no rcd.)
- A larch, 11 ins. diam., bears N47° E, 34.8 ft. (53 lks.) dist., healed face (B.L.M. rcd.)
- A stump and log, bears S38° E, 35.0 ft. (53 lks.) dist. (G.L.O. rcd.)
- A larch, 8 ins. diam., bears S56° E, 26.7 ft. (40 lks.) dist., healed face (B.L.M. rcd.)
- A larch, 12 ins. diam., bears S61° E, 41.7 ft. dist., healed face (no rcd.)
- A fir, 13 ins. diam., bears S33° W, 22.0 ft. (33 lks.) dist., healed face (B.L.M. rcd.)
- A fir, 14 ins. diam., bears S49° W, 15.4 ft. dist., healed face (no rcd.)
- A downed tree, bears S60° W, 31.3 ft. (47 lks.) dist., visible scribe "2" (G.L.O. rcd.)
- A fir, 9 ins. diam., bears N72° W, 15.7 ft. (24 lks.) dist., healed face (B.L.M. rcd.)

III. Painted a red band around each bearing tree and attached "Land Survey Monument" and "Bearing Tree" signs where needed. Set a guard post, with a "Survey Marker" decal attached, 3 ft. S. from corner.
Magnetic Declination: East, 19°

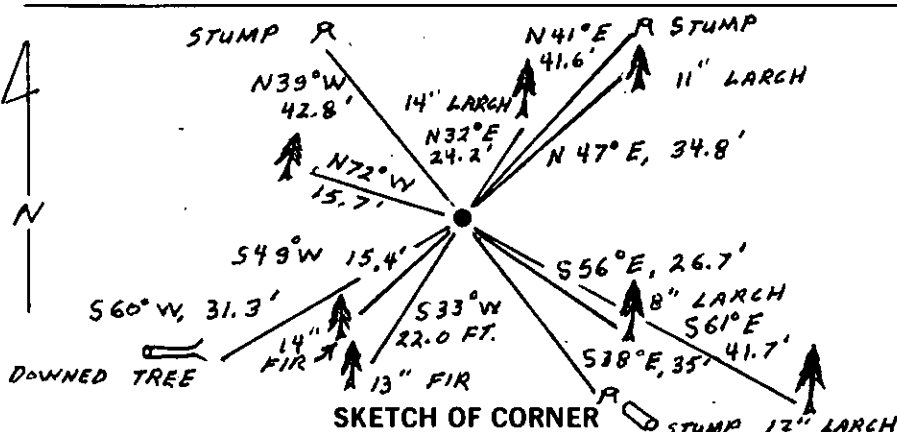

CERTIFICATION

1. Steve Boyer
certify the information shown herein is true and correct.

Signature of Party

1. Ronald A. Pearson
certify that this Corner Record correctly represents work performed by me or under my direction in compliance with the "Corner Recordation Act" (70-22-101, et seq., M.C.A.)

Signature of Surveyor & Seal

Date: 11/26/90 Reg. No. 9008LS

Employer: U.S. FOREST SERVICE

Office of Clerk and Recorder, County of Lincoln. This "corner record" was filed for record on Dec 10, 1990 was noted on the cross-index plat and is assigned page No. 4357 in book No. 4357

County Official

V 1

32 N 28 W

Cross Index No. T. R. PMM

Adopted July 1, 1981, Montana Board of Professional Engineers & Land Surveyors

Sec. 30

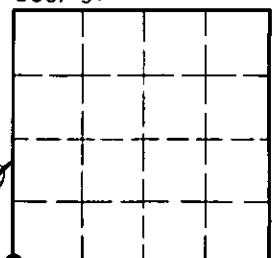

• - corner this sheet