

## INSTRUCTIONS

1. Original and/or subsequent record used to evaluate the corner position.
2. Description of evidence found, note discrepancies in the record, state method of establishing lost or obliterated corners.
3. Description of monument and accessories set to perpetuate the corner position.
4. Sketch of corner, show all pertinent data which can best be shown in a sketch example, corner marking, topography ties, position of accessories, etc.
5. Certification must be signed and sealed by Land Surveyor registered in the State of Montana.
6. Fill in Cross Index & Section Diagram at bottom of sheet.

## CERTIFIED CORNER RECORDATION

Corner SE 1/16 Sec. 30 T. 32 N. R. 28 W. P.M.M. Lincoln County

- I. No previous record.
- II. No evidence of a monument on the ground (Evidence of old Forest Service signs and blazes in area).
- III. At the determined corner position by survey, set a 3/4 in. dia. aluminum rod, 30 ins. long 24 ins. in the ground with attached 3 1/4 in. dia. U.S.D.A. Forest Service aluminum cap, marked as shown:

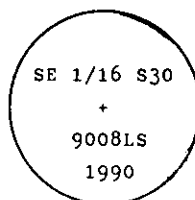

Placed a 2 ft. dia. rock collar around monument.

from which

A Larch, 14 ins. dia., bears S  $4^{\circ}$  W, 21.4 ft. dist., mkd. SE 1/16 S30 BT.

A Larch, 10 ins. dia., bears S  $62^{\circ}$  W, 42.5 ft. dist., mkd. SE 1/16 S30 BT.

Set a guard post, with "Survey Marker" and "Property Boundary" decals attached, 3 ft. W. from corner.

Painted a red band around each bearing tree and attached "Land Survey Monument" and "Bearing Tree" signs where needed.

Magnetic Declination: East,  $19^{\circ}$

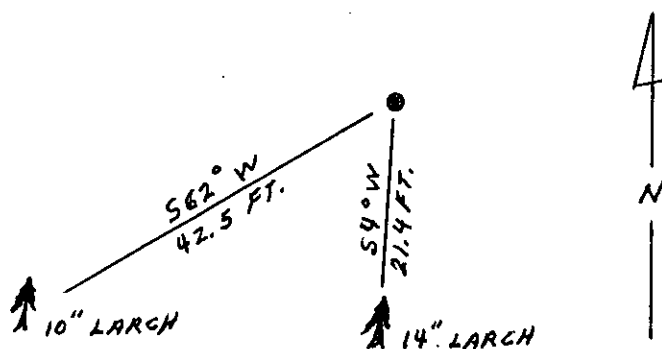
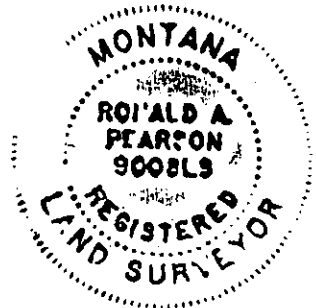

SKETCH OF CORNER

## CERTIFICATION

I, Gary C. Crismon  
certify the information shown herein is true and correct.  
Gary C. Crismon  
Signature Ground Party Chief

I, Ronald A. Pearson  
certify that this Corner Record correctly represents work performed  
by me or under my direction in compliance with the "Corner  
Recordation Act" (70-22-101, et seq., M.C.A.)  
Ronald A. Pearson  
Signature of Surveyor & Seal

Date: 10/30/90 Reg. No. 90081S  
Employer: U.S. FOREST SERVICE

Office of Clerk and Recorder, County of Lincoln. This "corner  
record" was filed for record on Dec 10, 1990  
was noted on the cross-index plat and is assigned page No. 4352, in  
book No. \_\_\_\_\_

Don't BT Aug 1 by Bill Buehly  
County Official

U 4 32 N 28 W  
Cross Index No. \_\_\_\_\_ T. \_\_\_\_\_ R. \_\_\_\_\_ PMM

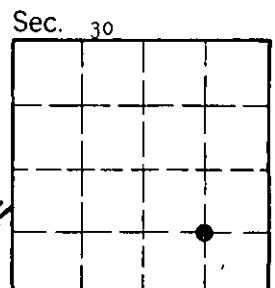

• corner this sheet