

INSTRUCTIONS

1. Original and/or subsequent record used to evaluate the corner position.
2. Description of evidence found, note discrepancies in the record, state method of establishing lost or obliterated corners.
3. Description of monument and accessories set to perpetuate the corner position.
4. Sketch of corner, show all pertinent data which can best be shown in a sketch example, corner marking, topography ties, position of accessories, etc.
5. Certification must be signed and sealed by Land Surveyor registered in the State of Montana.
6. Fill in Cross Index & Section Diagram at bottom of sheet.

CERTIFIED CORNER RECORDATION

Corner 1/4 Cor. of Secs. 19 & 30 T. 32 N. R. 28 W. P.M.M. Lincoln County

- I. 1911 original G.L.O. record by William C. Perkins: "Set a shale stone, 18 x 12 x 4 ins., 14 ins. in the ground for 1/4 sec. cor., marked 1/4 on N. face; from which

A pine, 16 ins. diam., bears S18° W, 19 lks. dist., marked 1/4 S30 BT.
A pine, 12 ins. diam., bears N8° W, 11 lks. dist., marked 1/4 S19 BT."

1967 recordation by Ira M. Tillotson (Reg. No. 858 ES): "We created one new reference monument tree which is a 15 in. pine which bears S72° E, 29.3 feet. This tree is double blazed and scribed RM."

- II. Found a firmly set stone, 18 x 12 x 4 ins., 5 ins. out of ground, mkd. 1/4 on N. face; from which

A pine stump, bears S10° E, 39.3 ft. (59.5 lks.) dist., mkd. RM (Tillotson rcd.)
A pine snag, bears S18° W, 12.5 ft. (19 lks.) dist. (G.L.O. rcd.)
A pine, 16 ins. diam., bears N6° W, 7.3 ft. (11 lks.) dist., mkd. 1/4 S19 BT (G.L.O. rcd.)

- III. At the stone position, set a 2 1/2 ins. diam. aluminum post, 30 ins. long, 26 ins. in the ground with attached 3 1/4 ins. diam., U.S.D.A. Forest Service aluminum cap, mkd. as shown:

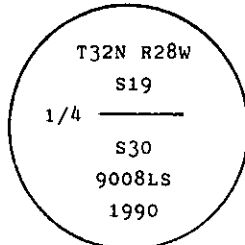

Placed a rock collar around monument
Bury the original stone alongside the new monument.

Established one new bearing tree

A fir, 16 ins. diam., bears S77° E, 45.5 ft. dist., mkd. 1/4 S30 BT.

Set a guard post, with a "Survey Marker" decal attached, 4.7 ft. E. from the corner.

Painted a red band around each bearing tree and attached "Land Survey Monument" and "Bearing Tree" signs where needed.

Magnetic Declination: East, 19°

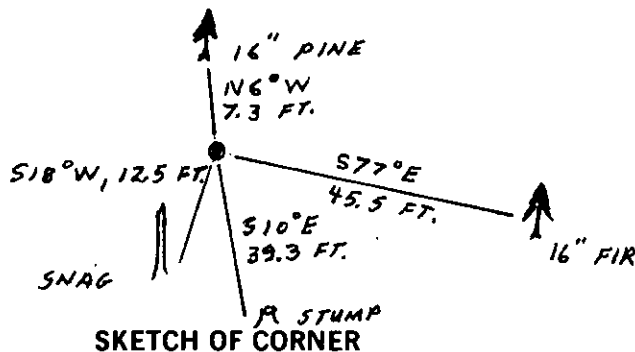
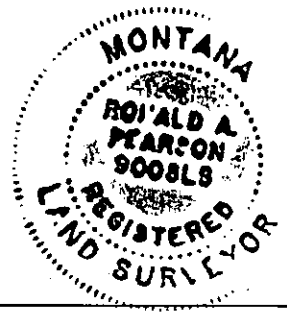

CERTIFICATION

- I. Gary C. Crismon
certify the information shown herein is true and correct.

Gary C. Crismon
Signature Ground Party Chief

- I. Ronald A. Pearson
certify that this Corner Record correctly represents work performed by me or under my direction in compliance with the "Corner Recordation Act" (70-22-101, et seq., M.C.A.)

Ronald A. Pearson
Signature of Surveyor & Seal
Date: 11/19/90 Reg. No. 9008LS
Employer: U.S. FOREST SERVICE

Office of Clerk and Recorder, County of Lincoln. This "corner record" was filed for record on Dec 10, 1990 was noted on the cross-index plat and is assigned page No. 4350, in book No. _____

Grant E. Sigley, D.D. Buckhoff
County Official

R 3 32 N 28 W
Cross Index No. _____ T. _____ R. _____ PMM

Sec. 19

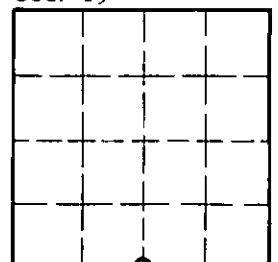

• - corner this sheet