

INSTRUCTIONS

1. Original and/or subsequent record used to evaluate the corner position.
2. Description of evidence found, note discrepancies in the record, state method of establishing lost or obliterated corners.
3. Description of monument and accessories set to perpetuate the corner position.
4. Sketch of corner, show all pertinent data which can best be shown in a sketch example, corner marking, topography ties, position of accessories, etc.
5. Certification must be signed and sealed by Land Surveyor registered in the State of Montana.
6. Fill in Cross Index & Section Diagram at bottom of sheet.

CERTIFIED CORNER RECORDATION

Corner C-N-SW-SE 1/256 Sec. 30 T. 32 N. R. 28 W. Lincoln County

I. 1965 plat No. 1116 by Ira E. Miller (County Surveyor), 1967 plat No. 1268, 1293 & 1307 by Max L. Norris (Reg. No. 2195 E), and 1968 plat No. 1453 by James L. Hahn (Reg. No. 2795-S): subdivision of sec. 30 into lots, no indication of interior corners set.

II. Found, a 1/2 in. dia. rebar, 4 ins. out of ground, bears N75° W. 20.7 ft. dist. from determined corner position.

III. At the determined corner position by survey, set a 3/4 ins. dia. aluminum rod, 30 ins. long, 24 ins. in the ground attached 3 1/4 ins. dia. U.S.D.A. Forest Service aluminum cap, marked as shown:

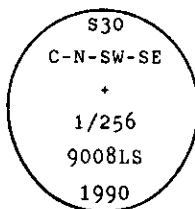

Placed a 2 ft. dia. rock collar around monument.

from which

A larch, 9 ins. dia., bears N28° E. 35.2 ft., mkd. C-N-SW-SE 1/256 BT.

A larch, 11 ins. dia., bears S45° E. 32.1 ft., mkd. C-N-SW-SE 1/256 BT.

Set a guard post, with "Survey Marker" and "Property Boundary" decals attached, 3 ft. W. from corner.

Painted a red band around each bearing tree and attached "Land Survey Monument" and "Bearing Tree" signs where needed.

Magnetic Declination: East, 19°

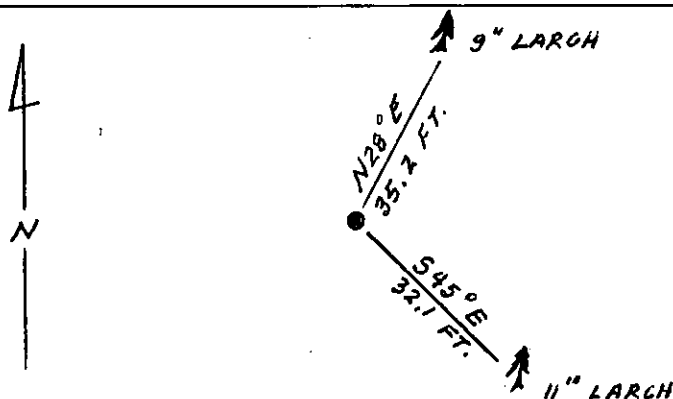
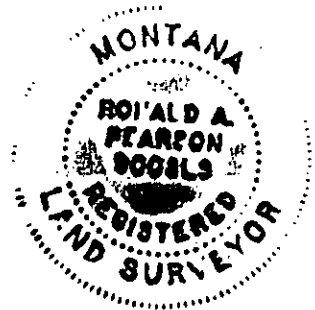

SKETCH OF CORNER

CERTIFICATION

I, Gary C. Crismon
certify the information shown herein is true and correct.

Gary C. Crismon
Signature Ground Party Chief

I, Ronald A. Pearson
certify that this Corner Record correctly represents work performed by me or under my direction in compliance with the "Corner Recordation Act" (70-22-101, et seq., M.C.A.)

Ronald A. Pearson
Signature of Surveyor & Seal

Date: 11/19/90 Reg. No. 9008LS

Employer: U.S. FOREST SERVICE

Office of Clerk and Recorder, County of Lincoln. This "corner record" was filed for record on Dec 10, 1990

was noted on the cross-index plat and is assigned page No. 4342, in book No. _____

Just as Supd. by Dick Buckoff
County Official

Cross Index No. .25 U 3.5 T. 32 N R. 28 W PMM

Sec. 30

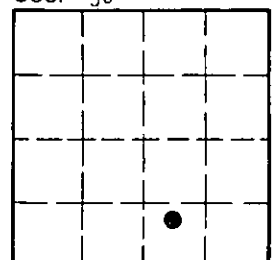

• - corner this sheet