

CERTIFIED LAND CORNER RECORDATION
(REFERENCE FSM 7153.53)

DESCRIPTION OF CORNER EVIDENCE FOUND, AND ORIGINAL RECORD (IF KNOWN)

No original evidence found. Corner position located near road right-of-way.

Original Record:

Set a post, 3 ft. long, 3 ins. square 2 1/2 ins. in the ground, from which;
A tamarack, 12 ins. diam., bears N43°30'E, 19 lks. dist., marked 1/4 S BT
A pine, 8 ins. diam., bears S6°45'W, 8 lks. dist., marked 1/4 S BT

DESCRIPTION OF MONUMENT AND ACCESSORIES ESTABLISHED
TO PERPETUATE THE ORIGINAL LOCATION OF THIS CORNER:

Date of work: 1979

Set a 3" X30" Aluminum pipe approx. 24" in ground, with Alum. cap marked as shown:
Raise a collar of stone. Position of corner determined by single proportionate measurement along township line.

From which:

A 10" diam. pine, bears N2°E, 54.3 Ft., scribed T34N R26W S35 BT
A 9" diam. fir, bears S75°E, 23.9 Ft., scribed T33N R26W S2 BT

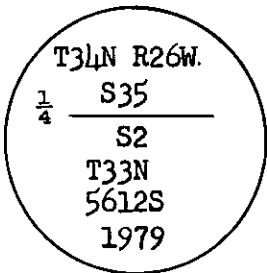

SKETCH, WITH COURSE AND DISTANCE TO ADJACENT CORNERS IF DETERMINED IN THIS SURVEY.
(MAY SKETCH OR PASTE REPRODUCTION ON REVERSE SIDE.)

See Certificate of Survey No. 747

Surveyor's Seal

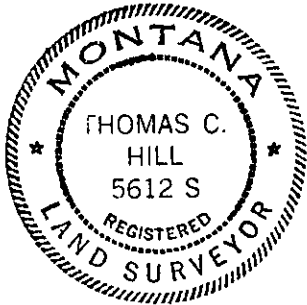

I, _____
certify that the information shown herein is true and correct.

Signature of Ground Party Chief

I, Thomas C. Hill
certify that I have carefully performed or reviewed the work done on the diagrammed corner as reported on this recordation form and approve the same.

Signature of Surveyor

5612-S
Registration Number

DIAGRAM OF CORNER:

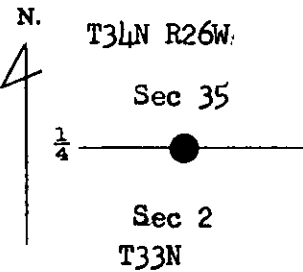

● = Corner recorded on the sheet

Office of Clerk and Recorder, County of Lincoln

This "corner record" was filed for record on the 3rd day of March, 1980, was noted on the cross-index plat and is assigned page No. 632, in book No. 1

County Official
Deputy

Cross Index No. A19 219 T 33 34 R 26 26 Mer.