

INSTRUCTIONS

1. Original and/or subsequent record used to evaluate the corner position.
2. Description of evidence found, note discrepancies in the record, state method of establishing lost or obliterated corners.
3. Description of monument and accessories set to perpetuate the corner position.
4. Sketch of corner, show all pertinent data which can best be shown in a sketch example, corner marking, topography ties, position of accessories, etc.
5. Certification must be signed and sealed by Land Surveyor registered in the State of Montana.
6. Fill in Cross Index & Section Diagram at bottom of sheet.

CERTIFIED CORNER RECORDATION

Corner NE Sec. Cor. of S25 T. 33 N. R. 26 W. P.M.M. Lincoln County

I. 1903 GLO record by Gordon C. Smith: Set a stone and four bearing trees.

1934 Resurvey record by Philip L. Inch: "This cor. will hereafter refer to secs. 24 and 25 only, therefore I erase the markings from the NE and SE bearing trees."

1961 BLM remonumentation record: The cor. of secs. 24 and 25, only, monumented with a granite stone, 4x8x10 ins., loosely set in the ground and mkd. with 2 notches on the S and 4 notches on the N.

from which the original bearing trees:

A fir, 10 ins. diam., bears S2° W, 42 lks. (27.72 ft.) dist., with scribing overgrown.  
(Record: S1/2° W, 42 lks. (27.72 ft.) dist.)  
A fir stump, 26 ins. diam., bears N88 1/2° W, 43 lks. (28.38 ft.) dist., visible scribing.  
(Record: N88 3/4° W, 44 lks. (29.04 ft.) dist.)

At the corner point set an iron post, 30 ins. long, 2 1/2 ins. diam., 26 ins. in the ground, with brass cap mkd.

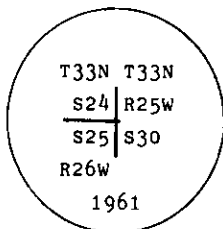

From which:

A larch, 10 ins. diam., bears S52° W, 75 lks. (49.50 ft.) dist., mkd. T33N R26W S25 BT.  
A fir, 10 ins. diam., bears N25° W, 52 lks. (34.32 ft.) dist., mkd. T33N R26W S24 BT.

II. Found a 2 1/2 ins. diam. iron pipe 6 ins. out of the ground with BLM brass cap mkd. as shown.

From which:

A fir, 10 ins. diam., bears S3° W, 28.3 ft. dist., healed face.  
A dead larch, 11 ins. diam., bears S71° W, 55.0 ft. dist., healed face. (Record: S52° W, 49.5 ft.)  
A fir stump, 26 ins. diam., bears N88° W, 28.0 ft. dist.  
A fir, 12 ins. diam., bears N22° W, 34.2 ft. dist., healed face.

III. Painted red bands around the bearing trees and attached "Land Survey Monument" and "Bearing Tree" signs.  
Set a galvanized steel guard post with "Land Survey Marker" and Property Boundary: decals, North, 3 ft.

Magnetic declination: 20° East

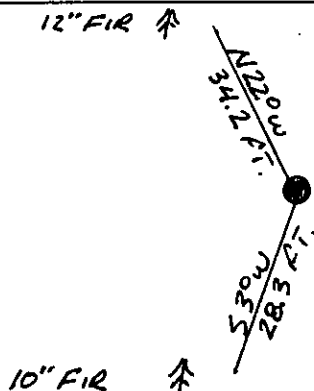

SKETCH OF CORNER

CERTIFICATION

I, Kevin A. Todd 9008LS  
certify the information shown herein is true and correct.

Kevin A. Todd  
Signature Ground Party Chief

I, Ronald A. Pearson 9008LS  
certify that this Corner Record correctly represents work performed by me or under my direction in compliance with the "Corner Recordation Act" (70-22101, et seq., M.C.A.)

Ronald A. Pearson  
Signature of Surveyor & Seal

Date: 12/17/92 Reg. No. 9008LS  
Employer: U.S. FOREST SERVICE

Office of Clerk and Recorder, County of Lincoln. This "corner record" was filed for record on 1-4-93 was noted on the cross-index plat and is assigned page No. 5216, in book No. Coral M Cummings by BB

County Official

R-25 33 N 26W

Cross Index No. T. R. PMM

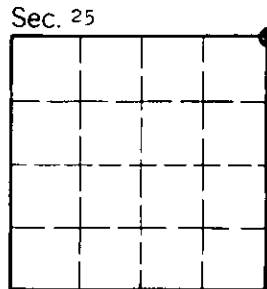

• - corner this sheet