

INSTRUCTIONS

1. Original and/or subsequent record used to evaluate the corner position.
2. Description of evidence found, note discrepancies in the record, state method of establishing lost or obliterated corners.
3. Description of monument and accessories set to perpetuate the corner position.
4. Sketch of corner, show all pertinent data which can best be shown in a sketch example, corner marking, topography ties, position of accessories, etc.
5. Certification must be signed and sealed by Land Surveyor registered in the State of Montana.
6. Fill in Cross Index & Section Diagram at bottom of sheet.

CERTIFIED CORNER RECORDATION

Corner SW Sec. Cor. of S24 T. 33 N. R. 26 W. P.M.M. Lincoln County

I. 1903 GLO record by Gordon C. Smith: Set a stone and four bearing trees.

1960 BLM remonumentation record: The cor. of secs. 23, 24, 25 and 26, monumented with a limestone, 5x12x24 ins., set in a mound of stone, and mkd. with 1 notch on the E face and 2 notches on the S face.

from which the original bearing trees:

- A fir, 11 ins. diam., bears N39 1/2° E, 35 lks. (23.10 ft.) dist., mkd. T33N R26W 2. (Record)
 A larch, 13 ins. diam., bears S82 1/4° E, 53 lks. (34.98 ft.) dist., mkd. T33N R26W S25 BT. (Record)
 A larch stump, 18 ins. diam., bears S43 1/2° W, 37 lks. (24.42 ft.) dist., mkd. T33N R26W S26. (Record)
 A larch, 9 ins. diam., bears N80° W, 16 lks. (10.56 ft.) dist., mkd. T33N R26W S23.
 (Record: N82 1/2° W, 16 lks.)

At the corner point set an iron post, 30 ins. long, 2 1/2 ins. diam., 10 ins. in the ground and concrete to bedrock, and in a mound of stone, 3 ft. base, to top, with brass cap mkd.

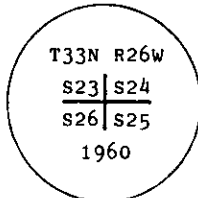

From which:

- A larch, 8 ins. diam., bears N41 1/4° W, 63 lks. (41.58 ft.) dist., mkd. T33N R26W S26 BT.

II. Found a 2 1/2 ins. diam. iron pipe 4 ins. out of the ground with BLM brass cap mkd. as shown.

From which:

- A fir, 13 ins. diam., bears N38° E, 23.6 ft. dist., healed face.
 A larch, 16 ins. diam., bears S83° E, 34.9 ft. dist., healed face.
 A larch, 15 ins. diam., bears S42° W, 41.6 ft. dist., healed face. (Record: N41 1/4° W, 41.58 ft.)
 A stump, 18 ins. diam., bears S45° W, 24.5 ft. dist., mkd. T33N R26W S26.
 A dead larch, 10 ins. diam., bears N79° W, 10.7 ft. dist., visible scribing.

III. Established one new bearing tree:

- A larch, 20 ins. diam., bears N30° W, 7.2 ft. dist., mkd. T33N R26W S23 BT.

Painted red bands around the bearing trees and attached "Land Survey Monument" and "Bearing Tree" signs.
 Set a galvanized steel guard post with "Land Survey Marker" and Property Boundary: decals, West, 3 ft.

Magnetic declination: 20° East

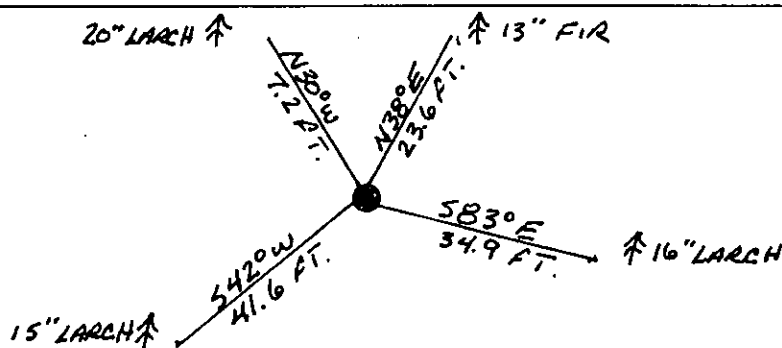

SKETCH OF CORNER

CERTIFIED **RONALD A. PEARSON**
 1. Kevin A. Todd certify the information shown herein is true and correct.
 Signature Ground Party
 1. Ronald A. Pearson
 certify that this Corner Record correctly represents work performed by me or under my direction in compliance with the "Corner Recordation Act" (70-22-101, et seq., M.C.A.)
 Signature of Surveyor & Seal
 12/17/92 9008LS
 Date: Reg. No.
 Employer: U.S. FOREST SERVICE

Office of Clerk and Recorder, County of Lincoln. This "corner record" was filed for record on 1-4-93
 was noted on the cross-index plat and is assigned page No. 5215, in book No. Coral M Cummings by BLP
 County Official

R-21

33 N 26W

Cross Index No. T. R. PMM

Sec. 24

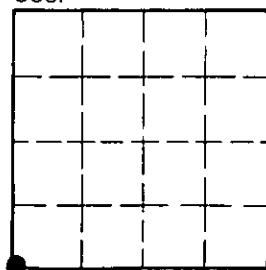

• - corner this sheet