

CERTIFIED CORNER RECORDATION

Corner SE Corner Section 4 T. 33N R. 26W P.M.M. Lincoln County

1903 Original GLO record by Abraham L. Rinearson and Gordon C. Smith:

"Set a limestone, 16 x 12 x 6 ins., 11 ins. in the ground, for cor. of secs. 3, 4, 9 and 10, marked with 5 notches on S and 3 notches on E. edge; from which

A tamarack, 9 ins. diam., bears N. 71° E., 42 lks. dist., marked T 33 N R 26 W S 3 B T

A tamarack, 9 ins. diam., bears S. 14° E 55 lks. dist., marked T 33 N R 26 W S 10 B T

A tamarack, 12 ins. diam., bears S. 54° W., 35 lks. dist., marked T 33 N R 26 W S 9 B T

A tamarack, 16 ins. diam., bears N. 65° W., 15 lks. dist., marked T 33 N R 26 W S 4 B T"

1976 BLM Remonumentation by Joseph E. French

"The cor. of secs. 3, 4, 9 and 10, determined from the remains of the original bearing trees:

A larch stump, 16 ins. diam., bears N. 76° E., 42 lks. dist., mkd. BT. (Record: N. 71° E.)

A larch stump, 18 ins. diam., bears S. 71° W., 35 lks. dist., mkd. S9 BT. (Record: S. 54° W.)

A larch stump, 24 ins. diam., bears N. 65° W., 15 lks. dist., mkd. 4 BT.

At the corner point

Set an iron post, 30 ins. long, 2 1/2 ins. diam., 24 ins. in the ground, with brass cap mkd.

T33N	R26W
S4	S3
S9	S10
1976	

from which new bearing trees:

A fir, 6 ins. diam., bears N. 51° E., 31 lks. dist., mkd. T33N R26W S3 BT.

A fir, 7 ins. diam., bears S. 51 1/2° E., 28 lks. dist., mkd. T33N R26W S10 BT.

A pine, 6 ins. diam., bears S. 78° W., 41 lks. dist., mkd. T33N R26W S9 BT.

A fir, 6 ins. diam., bears N. 44° W., 35 lks. dist., mkd. T33N R26W S4 BT.

raise a flat mound of stone, 1 1/2 ft. diam., around the iron post."

1982 Maintenance by S. R. Smith

"Found: Monument & Accessories per BLM Record."

1991 Maintenance by S. R. Smith

Found an iron post, 2 1/2 ins. diam., 6 ins. above the ground, with 3 1/4 ins. diam. BLM brass cap mkd. as shown, from which all bearings and distances to bearing trees are as per 1976 BLM Remonumentation.

NE BLM tree is a 6 ins. fir with overgrown blaze.

SE BLM tree is an 11 ins. fir with overgrown blaze.

SW BLM tree is a 7 ins. pine mkd. "T33N R26W S9 BT".

NW BLM tree is a 7 ins. fir with overgrown blaze.

NW GLO tree is a 22 ins. stump with visible scribing "BT".

A location poster bears S. 64° W., 5.3 ft. dist. from the monument.

Painted 6 ins. red bands and painted blazes red on BT's. Hung Land Survey Monument signs on BT's.

Set 6 ft. long galv. steel guard post with Land Survey Monument decal attached 1 ft. W. of monument.

Measurements were made with a Silva hand compass (declination 19° E.) and a steel tape to the center of the root crowns of all trees. Distances are horizontal.

See Certificate of Survey No. 1870, filed in conjunction with this Corner Recordation, for ties to adjacent corners.

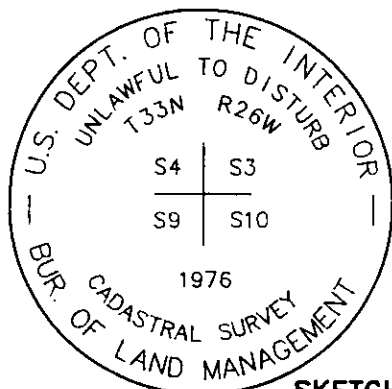

SKETCH OF CORNER

CERTIFICATION

I, David A. Holst

certify the information shown herein is true and correct.

David C. Holst

Signature of Land Party Chief

I, S. R. Smith

certify that this Corner Record correctly represents work performed by me or under my direction in compliance with the "Corner Recordation Act" (70-22-101, et seq., M.C.A.)

S R Smith

Signature of Surveyor & Seal

Date: 9/30/91 Reg. No. 4740S

Employer: Apogee, P.C.

Office of Clerk and Recorder, County of Lincoln This "corner

record" was filed for record on Oct 16, 1991

was noted on the cross-index plat and is assigned page No. 4584 A, in

book No. Coral M Cummings by Bill Bushoff
County Official

Cross Index No. E-13 T. 33N R. 26W PMM

Adopted July 1, 1981, Montana Board of Professional Engineers & Land Surveyors

Sec. 4

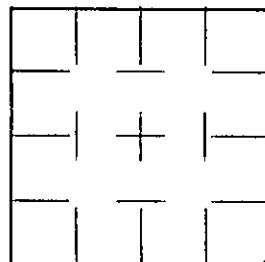

• corner this sheet

CRMCC5.dwg