

## INSTRUCTIONS

1. Original and/or subsequent record used to evaluate the corner position.
2. Description of evidence found, note discrepancies in the record, state method of establishing lost or obliterated corners.
3. Description of monument and accessories set to perpetuate the corner position.
4. Sketch or corner, show all pertinent data which can best be shown in a sketch example, corner marking, topography ties, position of accessories, etc.
5. Certification must be signed and sealed by Registered Land Surveyor in State of Montana.
6. Fill in Cross Index & Section Diagram at bottom of sheet.

## CERTIFIED CORNER RECORDATION

Corner Sections 7 & 18 on W Range T33 N R. 26 W P.M.M. LINCOLN County  
Line

RECORD: GLO 1903

Set a fir post 3' long, 4" sq. 24" in the ground, for corner of secs. 7, 12, 13, and 8, marked T33N S7 on NE, R26W S18 on SE, S13 on SW, and N27W S12 on NW face; with 2 notches on N and 4 notches on S edge; from which  
A spruce, 28" diam., bears N 35 $\frac{1}{2}$ ° E 14 lks. dist., marked T33N R26W S 18 BT.

A spruce, 26" diam. bears S 9° E, 39 lks. dist. marked T33N R26W, S 18 BT.

A spruce, 24" diam., bears S 59 $\frac{1}{4}$ ° W, 28 lks. dist., marked T33N, R27W, S 13 BT.

A hemlock 12" diam, bears N 57° W, 42 lks. dist, marked T33N, R27W, S 12 BT.

RECORD: GLO 1911 Subdivisions of T33N, R27W set closing corners

RECORD: BLM 1976

The corner of secs. 7 and 18, on the E bdy. of the Tp., monumented with the decayed remains of a wood post, and witnessed by the remains of a wood post, and witnessed by the remains of the original bearing trees:

A spruce stump, 24" diam, bears S 59 $\frac{1}{4}$ ° W, 28 lks. dist., mkd. BT.

A hemlock stump, 12" diam., bears N 57° W, 42 lks. dist., marked BT.

At the corner point set an iron post 30" long, 2 $\frac{1}{2}$ " diam., 24" in the ground, with brass cap from which new bearing trees:

A fir 7" diam., bears N 65 $\frac{1}{4}$ ° E, 94 lks. dist., mkd. T33N R26W S18 BT.

A spruce, 12" diam., bears S 57° E, 38 lks. dist., mkd. T33N R26W S7 BT.

Place the decayed remains of the original wood post alongside and raise a flat mound of stone, 2' diam., around the iron post.

FOUND:

3 $\frac{1}{4}$ " BLM Brass Cap on Steel Pipe in a mound of stone.

10" W Fir bears N65° E 62.3' scribing visible N R26W S7 BT.

14" Spruce bears S58° E 25.2' scribing pitched over.

MAINTENANCE:

Set a 6' Steel Post 3' away from monument, cleared brush away from corner. Maintained B.T.'s with signs and paint.

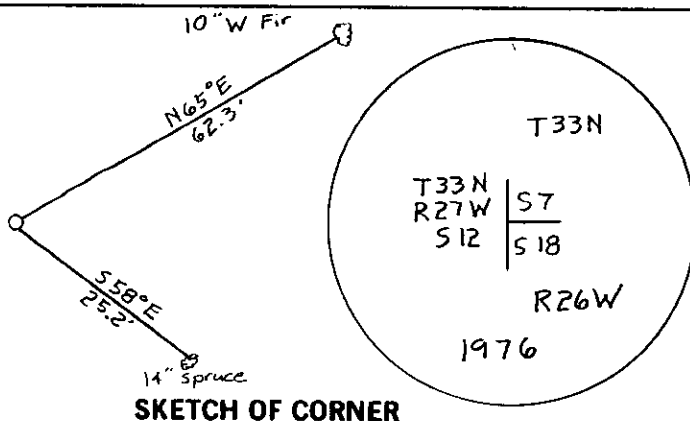

SKETCH OF CORNER

CERTIFICATION

I, Glenn M. Knodle certify the information shown herein is true and correct.

Glenn M. Knodle  
Signature Ground Party Chief

I, H. Gene Warren certify that this Corner Record correctly represents work performed by me or under my direction in compliance with the "Corner Recordation Act" (70-22-101, et seq., M.D.A.)

H. Gene Warren  
Signature of Surveyor & Seal

Date: 7-1-88 Reg. No. 2734S

Employer: Rocky Mountain Surveyors

Office of Clerk and Recorder, County of Lincoln. This "corner record" was filed for record on the July 29 day of 1988 was noted on the cross-index plat and is assigned page No. 3882, in book No. \_\_\_\_\_

Robert D. Sugill  
County Official

Sec. 7 & 18

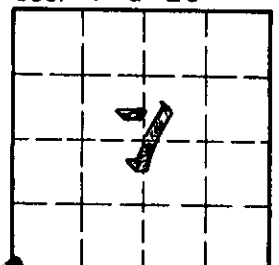

Cross Index No. J-1 T. 34N R. 26W PMM

• - corner this sheet