

## INSTRUCTIONS

1. Original and/or subsequent record used to evaluate the corner position.
2. Description of evidence found, note discrepancies in the record, state method of establishing lost or obliterated corners.
3. Description of monument and accessories set to perpetuate the corner position.
4. Sketch or corner, show all pertinent data which can best be shown in a sketch example, corner marking, topography ties, position of accessories, etc.
5. Certification must be signed and sealed by Registered Land Surveyor in State of Montana.
6. Fill in Cross Index & Section Diagram at bottom of sheet.

## CERTIFIED CORNER RECORDATION

Corner 1/4 SEC. 31 T. 33N R. 26W P.M.M. LINCOLN County

1. RECORD: ORIGINAL 1903 SET A SLATE STONE 14x10x8 9" IN THE GROUND FOR THE STANDARD COR. MARKED S C 1/4 ON THE NORTH FACE FROM WHICH:

A PINE 10" DIAM. BEARS N 52° E 55 LKS. DIST.  
MARKED S C 1/4 S BT.

A PINE 13" DIAM. BEARS N 36° 45' W 66 LKS. DIST.  
MARKED S C 1/4 S BT.

RESURVEY 1961 SET A IRON POST 30" LONG 2 1/2" DIAM.  
27" IN THE GROUND WITH BRASS CAP MARKED:

S C  
T33N R26W  
1/4 S 31  
1961

FROM WHICH:

A LARCH 12" DIAM. BEARS N 59° E 36 LKS. DIST.  
MARKED 1/4 S 31 S C BT.

A LARCH 10" DIAM. BEARS N 37° 30' W 70 LKS. DIST.  
MARKED 1/4 S 31 S C BT.

2. FOUND: BRASS CAP AND BOTH BEARING TREES FROM THE 1961 SURVEY, ( SCRIBING OVERGROWN ).
3. MAINTAINED: MAINTAINED BEARING TREES WITH SIGN'S AND PAINT SET A 6" STEEL POST APPROX. 3.0' EAST OF CAP.

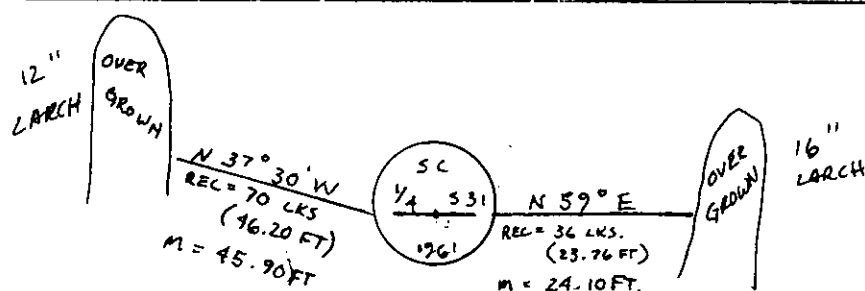

SKETCH OF CORNER

## CERTIFICATION

I, DANIEL J CROFT  
certify the information shown herein is true and correct.

Daniel J Croft  
Signature, Registered Land Surveyor

I, GENE WARTEN  
certify that this corner record correctly represents work performed by me or under my direction in compliance with the "Corner Recordation Act" (70-22-101, et seq., M.C.A.).

Gene Warten  
Signature, Registered Land Surveyor

Date: 2/24/87  
Employer: ROCKY MOUNT SURVEYORS

Office of Clerk and Recorder, County of Lincoln. This "corner record" was filed for record on the Feb 24 day of 1987 was noted on the cross-index plat and is assigned page No. 3528 in book No.         

Janet BF Sugil by Bill Buschhoff  
County Official Deputy

Cross Index No. Z-3 T. 33N R. 26W P.M.M.

Sec. 31 T33N R26W

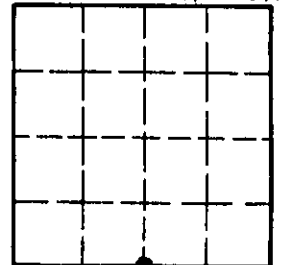

• corner this sheet