

## INSTRUCTIONS

1. Original and/or subsequent record used to evaluate the corner position.
2. Description of evidence found, note discrepancies in the record, state method of establishing lost or obliterated corners.
3. Description of monument and accessories set to perpetuate the corner position.
4. Sketch of corner, show all pertinent data which can best be shown in a sketch example, corner marking, topography lies, position of accessories, etc.
5. Certification must be signed and sealed by Registered Land Surveyor in State of Montana.
6. Fill in Cross Index & Section Diagram at bottom of sheet.

## CERTIFIED CORNER RECORDATION

Corner E 1/16 Sec. 1 T. 33N R. 26W P.M.M. LINCOLN County

No record or evidence of corner being previously set.

I position corner from found Section and Quarter corners and as shown on the Certificate of Survey as filed and as of record in the Lincoln Co. Courthouse.

I set a 3" alum. cap for corner position, from which:

A 16" fir bears N.38°E., 25.2' scribed E 1/16 S1 BT  
A 6" fir bears S.22°E., 14.9' scribed E 1/16 S12 BT

Painted red bands around BT's and painted blazes red.

Posted BT, Attention, and Location signs.

Placed a 6' metal post w/survey monument sticker along side cap.

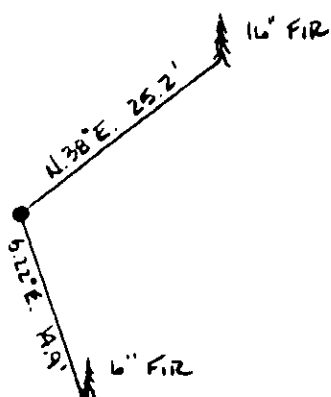
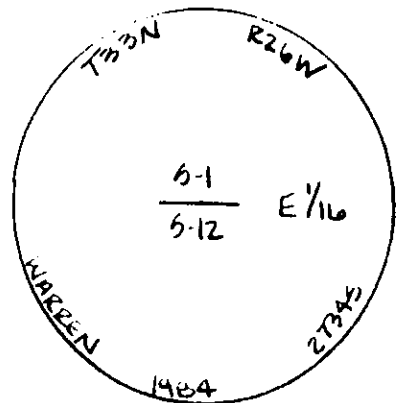

SKETCH OF CORNER

## CERTIFICATION

I, GLENN KNODLE

certify the information shown herein is true and correct.

Glenn Knodle

Signature Ground Party Chief

I, H. GENE WARREN

certify that this Corner Record correctly represents work performed by me or under my direction in compliance with the "Corner Recordation Act" (70-22-101, et seq., M.D.A.)

H. Gene Warren

Signature of Surveyor & Seal

Date: 10/84 Reg. No. 27345

Employer: ROCKY MOUNTAIN SURVEYORS

Office of Clerk and Recorder, County of LINCOLN. This "corner record" was filed for record on the Nov 30 day of 1984 was noted on the cross-index plat and is assigned page No. 2804, in book No. \_\_\_\_\_

Janet BF Sigel by Betty Conner  
County Official deputy

Sec. 1

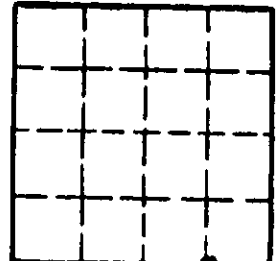

• corner this sheet

Cross Index No. E24 T. 33N R. 26W P.M.M.