

INSTRUCTIONS

1. Original and/or subsequent record used to evaluate the corner position.
2. Description of evidence found, note discrepancies in the record, state method of establishing lost or obliterated corners.
3. Description of monument and accessories set to perpetuate the corner position.
4. Sketch of corner, show all pertinent data which can best be shown in a sketch example, corner marking, topography ties, position of accessories, etc.
5. Certification must be signed and sealed by Land Surveyor registered in the State of Montana.
6. Fill in Cross Index & Section Diagram at bottom of sheet.

CERTIFIED CORNER RECORDATION

Corner: East $\frac{1}{4}$ Sec. Cor. S. 13 T. 33 N. R. 26 W. P.M.M. Lincoln County

I. 1893 GLO Survey Horse Plains Guide Meridian: Set a limestone, 18x10x5 ins., 12 ins. in the ground, for $\frac{1}{4}$ sec. cor. mkd. $\frac{1}{4}$ on W face; from which:

A fir, 7 ins. diam., bears N38°E, 7 lks. dist., mkd. $\frac{1}{4}$ S BT.

A fir, 7 ins. diam., bears S27 $\frac{1}{2}$ °W, 11 lks. dist., mkd. $\frac{1}{4}$ S BT.

1903 GLO Retracement and Resurvey Horse Plains Guide Meridian: Set a limestone, 18x12x5 ins., 12 ins. in the ground, for $\frac{1}{4}$ sec. cor., mkd. $\frac{1}{4}$ on W. face; from which:

A fir, 8 ins. diam., bears N54E, 12 lks. dist., mkd. $\frac{1}{4}$ S18 BT.

A fir, 6 ins. diam., bears S53W, 15 lks. dist., mkd. $\frac{1}{4}$ S13 BT.

The old corner, which is a stone, mkd. and witnessed as described by the surveyor general, I destroy.

1934 GLO Retracement and Resurvey Horse Plains Guide Meridian: At 31.36 chains, the $\frac{1}{4}$ sec. cor. of secs. 13 and 18, which is a sandstone, 10x6x4 ins. above the ground, mkd. as described, with the exception that both bearing trees are dead and fallen. The $\frac{1}{4}$ sec. cor. will hereafter refer to sec. 13 only. Establish bearing trees:

A tamarack, 8 ins. diam., bears S 24 $\frac{1}{2}$ °W, 44 lks. dist., mkd. $\frac{1}{4}$ S13 BT.

A tamarack, 16 ins. diam., bears N 50 $\frac{1}{2}$ ° W, 92 lks. dist., mkd. $\frac{1}{4}$ S13 BT.

1961 BLM Remonumentation: The $\frac{1}{4}$ sec. cor. of sec. 13, only, monumented with an unmarked sandstone, 8x10x4 ins., loosely set in the ground. from which the original bearing trees:

A larch, 14 ins. diam., bears S84 $\frac{1}{2}$ °W, 44 lks. dist., mkd. $\frac{1}{4}$ S13 BT. (Record: S 24 $\frac{1}{2}$ °W, 44 lks. dist.)

A larch, 16 ins. diam., bears N7°W, 92 lks. dist., mkd. $\frac{1}{4}$ S13 BT. (Record: N 50 $\frac{1}{2}$ ° W, 92 lks. dist.)

Note: There is no apparent reason for the gross differences in bearings between the 1961 Record and the 1934 Record.

At the corner point

Set an iron post, 30 ins. long, 2 $\frac{1}{2}$ ins. diam., 26 ins. in the ground in concrete, with brass cap mkd., from which:

A larch, 6 ins. diam., bears S 24 $\frac{1}{2}$ ° W, 58 lks. dist., mkd. $\frac{1}{4}$ S13 BT.

A larch, 4 ins. diam., bears N 38° W, 26 lks. dist., mkd. $\frac{1}{4}$ S13 BT.

Bury the original stone alongside the iron post. Set a wooden post, 4 ft. long, 4 ins. diam., in the ground alongside the iron post. Raise a mound of stone, 2 $\frac{1}{2}$ ft. base, 1 $\frac{1}{2}$ ft. high, W. of the iron post.

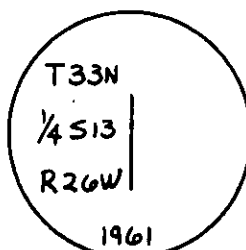
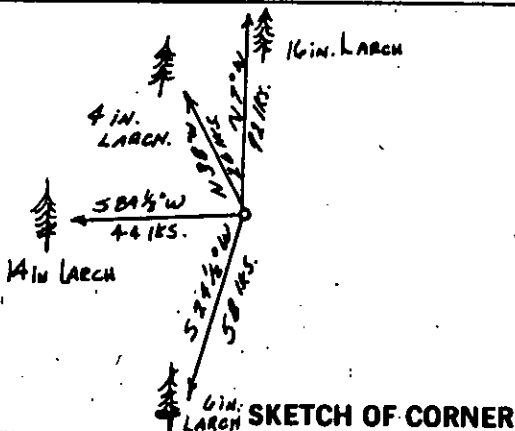

1. Randall Kelsey ALVAH F. certify the information shown herein is true and correct.

Randall Kelsey ALVAH F. Signature of Ground Party Chief

1. Alvah F. Hughes certify that this Corner Record correctly represents work performed by me or under my direction in compliance with the "Corner Recordation Act" (70-22-101, et seq., M.C.A.)

Alvah F. Hughes Signature of Surveyor & Seal

Date: 7-2-84 Reg. No. 7322 S

Employer: USES

Office of Clerk and Recorder, County of Lincoln This "corner

record" was filed for record on July 9th 1984

was noted on the cross-index plat and is assigned page No. 2633, in

book No. Janet B. Siegel by Betty Conces County Official deputy

Sec. 13

- II. I found a $3\frac{1}{2}$ in. diam., brass cap, 6 ins. above the ground with a collar of stone, from which:
- A dead larch, 4 ins. diam., bears N 48° E, 16.8 ft., scribing visible.
 - A larch, 10 ins. diam., bears S 28° W, 38.0 ft., healed face.
 - A dead larch, 16 ins. diam., bears S 88° W, 29.3 ft., scribing partially visible.
 - A wooden post, 4 ins. diam., bears south 0.4 ft. from the brass cap.
- III. Set a 6 ft. carsonite post, 2 ft. in the ground, 2 ft. south of the brass cap, with a Survey Marker Decal attached. Painted red bands around bearing trees and attached attention signs. Scribed one new bearing tree: A fir, 8 ins. diam., bears N 8° W, 8.4 ft., scribed $\frac{1}{4}$ S 13 BT.