

INSTRUCTIONS

1. Original and/or subsequent record used to evaluate the corner position.
2. Description of evidence found, note discrepancies in the record, state method of establishing lost or obliterated corners.
3. Description of monument and accessories set to perpetuate the corner position.
4. Sketch or corner, show all pertinent data which can best be shown in a sketch example, corner marking, topography ties, position of accessories, etc.
5. Certification must be signed and sealed by Registered Land Surveyor in State of Montana.
6. Fill in Cross Index & Section Diagram at bottom of sheet.

CERTIFIED CORNER RECORDATION

Corner E 1/16 S33 T. 33N R. 26W P.M.M. LINCOLN County

RECORD: No record of corner on file.

FOUND: Nothing to show evidence of a previously monumented corner.

SET: A 3 1/4 ins. diam. aluminum cap on a 30 ins. long aluminum pipe approx. 27ins. in the ground, surrounded by a mound of stone and mkd. as shown.

from which

A larch ; 18 ins. diam., bears N.35°E., 25.8 feet dist., scribed S33 BT.

A larch, 10 ins. diam., bears N.78°E., 43.3 feet dist., scribed S33 BT.

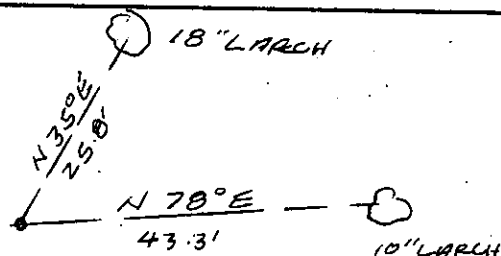
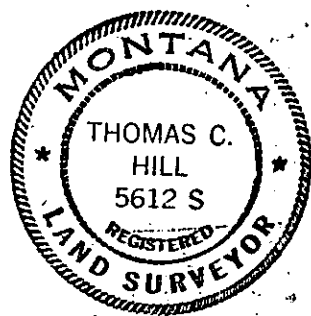
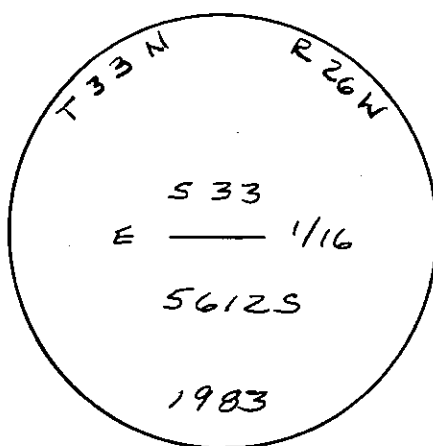

SKETCH OF CORNER

CERTIFICATION
 I, James W. Reed
 certify the information shown herein is true and correct.
James W. Reed
 Signature Ground Party Chief
 I, Thomas C. Hill
 certify that this Corner Record correctly represents work performed
 by me or under my direction in compliance with the "Corner
 Recordation Act" (70-23-101, et seq., M.D.A.)
Thomas C. Hill
 Signature of Surveyor & Seal
 Date: 8/1/83 Reg. No. 5612 S
 Employer: U.S.F.S.

Office of Clerk and Recorder, County of LINCOLN. This "corner
 record" was filed for record on the AUGUST 18 day of 1983
 was noted on the cross-index plat and is assigned page No. 2282, in
 book No. _____

Janet BF Siegel by Betty L. Conner
 County Official deputy

Cross Index No. _____ T. 33 R. 26 P.M.M.

Sec. 33

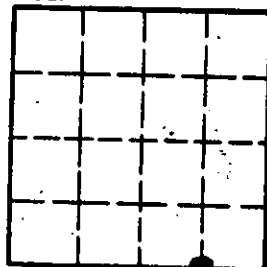

• corner this sheet