

INSTRUCTIONS

1. Original and/or subse record used to evaluate the corner position.
2. Description of evidence found, note discrepancies in the record, state method of establishing lost or obliterated corners.
3. Description of monument and accessories set to perpetuate the corner position.
4. Sketch or corner, show all pertinent data which can best be shown in a sketch example, corner marking, topography ties, position of accessories, etc.
5. Certification must be signed and sealed by Registered Land Surveyor in State of Montana.
6. Fill in Cross Index & Section Diagram at bottom of sheet.

CERTIFIED CORNER RECORDATION

Corner Sec. Cor 13 & 24 T. 33 N R. 27 W P.M.M. Lincoln County
18 & 19 T 33 N R 26 W

Found BLM brass cap.

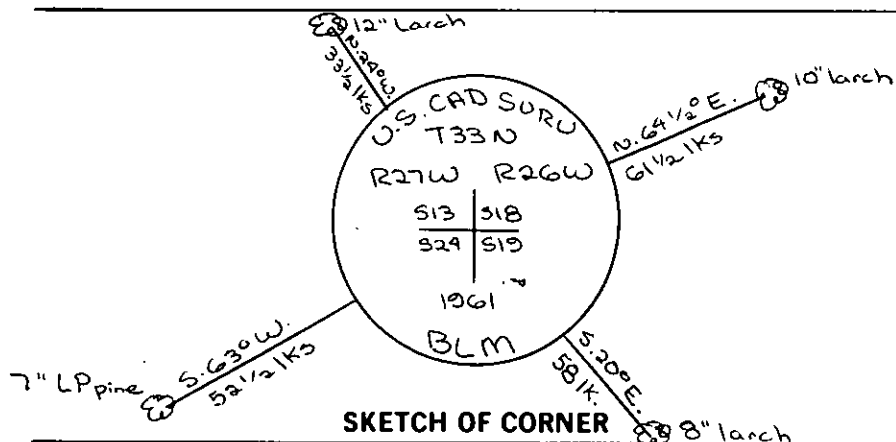

CERTIFICATION

I, _____
 certify the information shown herein is true and correct.

Signature Ground Party Chief

I, D.K. Marquardt
 certify that this Corner Record correctly represents work performed
 by me or under by direction in compliance with the "Corner
 Recordation Act" (70-22-101, et seq., M.D.A.)

Signature of Surveyor & Seal

Date: 7-15-18 Reg. No. 2288 ES

Employer: _____

SKETCH OF CORNER

Office of Clerk and Recorder, County of Lincoln. This "corner
 record" was filed for record on the 17th of July day of 19 19,
 was noted on the cross-index plat and is assigned page No. 1097, in
 book No. 1

James L. Vaughn, by Betty Bell,
 County Official deputy

Cross Index No. 10-1 T. 33 N R. 26 W PMM
10-25 T33N R27W

Sec. 19

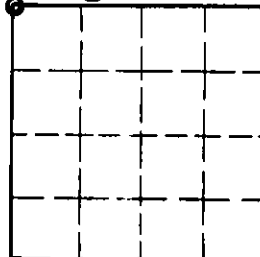

• corner this sheet