

CERTIFIED CORNER RECORDATION

Corner 1/4 Sec. 14&23 T. 31N R. 34W P.M., MT Lincoln County

- I. 1903 G.L.O. Original Record by Allen B. Benedict: Set a granite stone, 12x10x8 ins., 8 ins. in the ground, for 1/4 sec. cor., mkd. "1/4" on the N. face. Established two bearing trees.
- 1966-68 B.L.M. Remonumentation Record by Woodrow E. Damm et. al: The 1/4 sec. cor. of secs. 14&23, monumented with a granite stone, 12x10x8 ins., firmly set, mkd. "1/4" on the N. face, and witnessed by the remains of the original bearing trees. At the corner point, set an iron post, 30 ins. long, 2 1/2 ins. diam., 24 ins. in the ground, with a brass cap mkd. as shown.

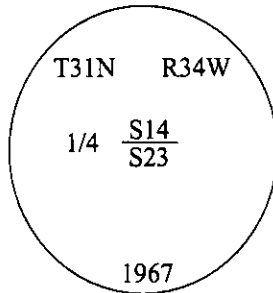

Established one new bearing tree and burined the original stone alongside the iron post.

1982 Certified Corner Recordation by J. H. Ninneman, 4661S: Found a B.L.M. brass capped monument mkd. as shown above. Found one original and the B.L.M. bearing tree. Painted accessories red.

- II. Found a 2 1/2 in. diam. iron pipe, protruding 6 ins. above the ground, with a 3 1/4 in. diam. B.L.M. brass cap mkd. as shown above.

from which:

A fir, 23 ins. diam., bears N35°W, 3.7 ft. dist., with visible scribe. (GLO-record-N45°30'W)

- III. Established one bearing tree:

A pine, 25 ins. diam., bears S08°W, 75.5 ft. dist., mkd. "1/4 S23 BT".

Painted red bands around the bearing tree and attached Land Survey Monument and Bearing Tree signs.

Magnetic Declination: 20° East.

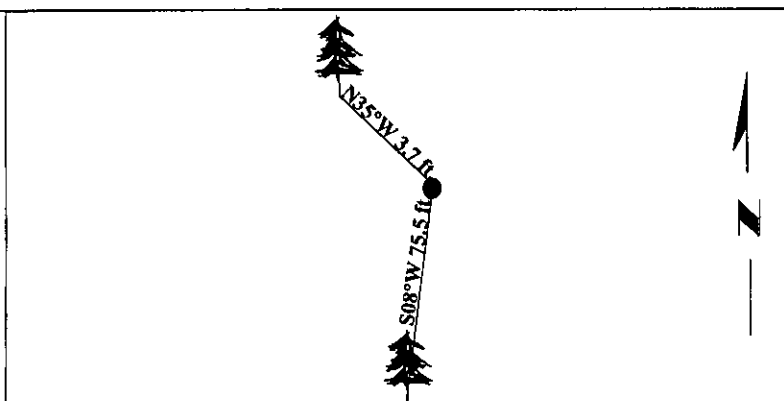

SKETCH OF CORNER

CERTIFICATION

I, Thomas Hommel certify the information shown herein is true and correct.

I, Ronald A. Pearson certify that this Corner Record correctly represents work performed by me or under my direction in compliance with the "Corner Recordation Act" (70-22-101, et seq., M.C.A.)

Signature of Surveyor & Seal

Date: 09/29/97

Reg. No.: 9008LS

Employer: U.S. FOREST SERVICE

Office of Clerk and Recorder, County of Lincoln. This "corner record" was filed for record on Oct 10, 1997 was noted on the cross-index plat and is assigned page No. 9975 in book No. _____

Coral M. Cummings By DUB
County Official

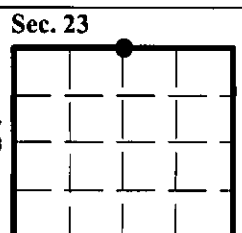

• - corner this sheet

Cross Index No. N-19 T. 31N R. 34W P.M., MT