

CERTIFIED CORNER RECORDATION

Corner WE 1/64 Sec. 14&23 T. 31N R. 34W P.M., MT Lincoln County

I. 1982 Certified Corner Recordation by Jack H. Ninneman, 4661S: This corner was not previously set. Set by survey, a 3 in. diam. x 30 ins. long aluminum pipe, mkd. as shown.

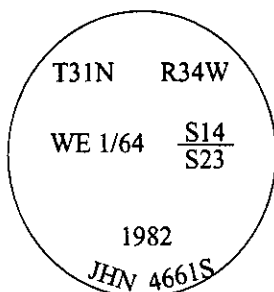

Established two bearing trees:

- A fir, 12 ins. diam., bears N68°30'E, 5.9 ft. dist., mkd. "S14 WE 1/64 BT".
- A fir, 8 ins. diam., bears S04°30'W, 10.6 ft. dist., mkd. "S23 WE 1/64 BT".
- A fir, 8 ins. diam., bears S61°W, 7.1 ft. dist., with a location poster attached.

II. Found a 3 1/4 in. diam., USFS aluminum cap, set flush in a collar of stone, mkd. as shown above. Found both of the bearing trees set by J. H. Ninneman in 1982.

from which:

- A fir, 13 ins. diam., bears N68°E, 5.5 ft. dist., with a healed face.
- A dead fir, 8 ins. diam., bears S04°W, 10.6 ft. dist., with a healed face.

III. Established one bearing tree:

- A larch, 14 ins. diam., bears S15°W, 56.8 ft. dist., mkd. "WE 1/64 S23 BT".

Painted red bands around the bearing tree and attached Land Survey Monument and Bearing Tree signs.

Magnetic Declination: 20° East.

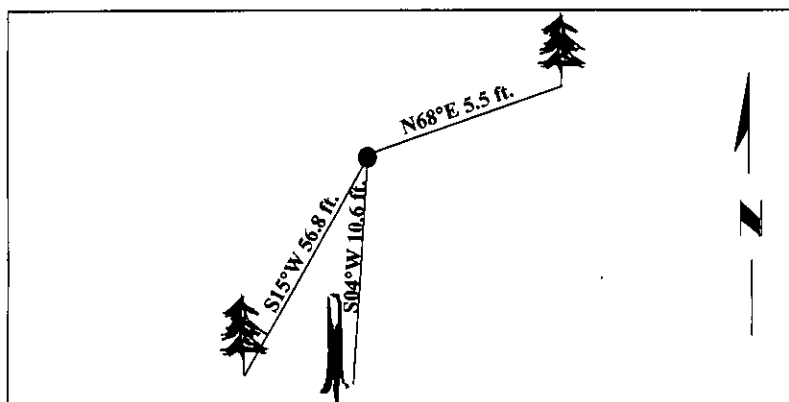

SKETCH OF CORNER

CERTIFICATION

I, Thomas Hommel
certify the information shown herein is true and correct.

Thomas Hommel

I, Ronald A. Pearson
certify that this Corner Record correctly represents work performed by me or under my direction in compliance with the "Corner Recordation Act" (70-22-101, et seq., M.C.A.)

Ronald A. Pearson
Signature of Surveyor & Seal

Date: 09/29/97

Reg. No.: 9008LS

Employer: U.S. FOREST SERVICE

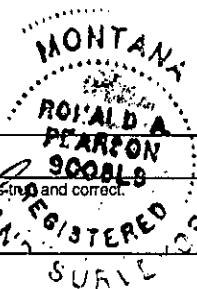

Office of Clerk and Recorder, County of Lincoln. This "corner record" was filed for record on Oct 10, 1997 was noted on the cross-index plat and is assigned page No. 9974 in book No. _____

Coral M. Cummins By PEB
County Official

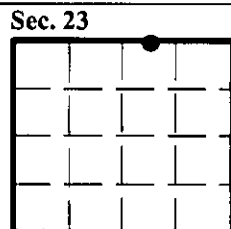

● - corner this sheet