

CERTIFIED CORNER RECORDATION

Corner **1/4** **Sec. 16 & 21** **T. 31N** **R. 34W** **P.M., MT** **Lincoln** **County**

I. 1903 G.L.O. original record by Allen B. Benedict: Set a granite stone 16x8x6 ins., 11 ins. in the ground, mkd. 1/4 on N. face, from which

A pine, 12 ins. diam., bears S41°W, 20 lks. dist. marked "1/4 S21 BT"
A pine, 20 ins. diam., bears N61°30'W, 55 lks. dist. marked "1/4 S16 BT"

1967 B.L.M. remonumentation record by Woodrow E. Damm et. al.: Set an iron post 30 ins. long, 2 1/2 ins. diam., 24 ins. in the ground, with brass cap mkd. as shown:

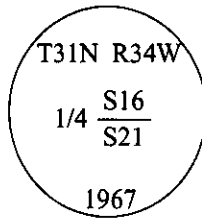

From which:

The original bearing tree:

A pine, 31 ins. diam., bears N60°30'W, 55 lks. dist., mkd. "1/4 S16 BT". (Record N61°30'W)

The new bearing tree:

A pine, 5 ins. diam., bears S52°30'E, 70 lks. dist., mkd. "1/4 S21 BT".

Bury original stone alongside iron post.

II. Found iron pipe, 30 ins. long, 2 1/2 ins. diam., 24 ins. in the ground with brass cap mkd. as shown above.

From which:

A pine, 34 ins. diam., bears N60°30'W, 36.3 ft. dist. (55 lks.) healed face.
A pine, 14 ins. diam., bears S52°30'E, 46.2 ft. dist. (70 lks.) healed face.

III. Painted bearing trees and attached Land Survey Monument and Bearing Tree signs.
Magnetic Declination: 20° East

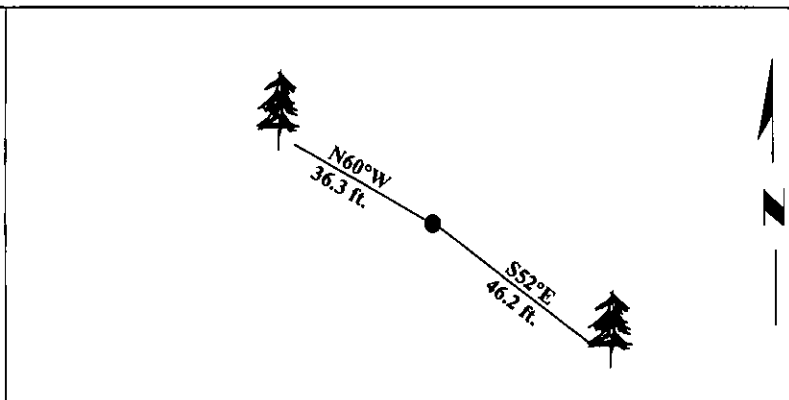

SKETCH OF CORNER

CERTIFICATION
I. <u>Ryan Rummelhart</u> certify the information shown herein is true and correct.
Signature Ground Party Chief
I. <u>Alvah F. Hughes</u> certify that this Corner Record correctly represents work performed by me or under my direction in compliance with the "Corner Recordation Act" (70-22-101, et seq., M.C.A.)
Signature of Surveyor & Geol.
Date: <u>1/8/96</u>
Reg. No.: <u>7322LS</u>
Employer: <u>U.S. FOREST SERVICE</u>

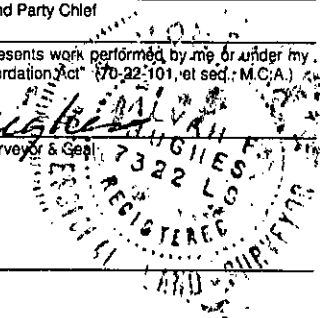

Office of Clerk and Recorder, County of LINCOLN. This "corner record" was filed for record

FEB 20, 1997

was noted on the cross-index plat and is assigned page No. 9231

Book No. _____

CORAL M. CUMMINGS *By DEB*

County Official

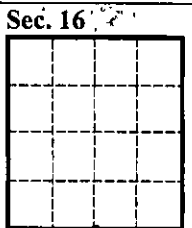

● - corner this sheet

Cross Index No. **N - 11** T. **31N** R. **34W** P.M., MT