

INSTRUCTIONS

1. Original and/or subsequent record used to evaluate the corner position.
2. Description of evidence found, note discrepancies in the record, state method of establishing lost or obliterated corners.
3. Description of monument and accessories set to perpetuate the corner position.
4. Sketch of corner, show all pertinent data which can best be shown in a sketch example, corner marking, topography ties, position of accessories, etc.
5. Certification must be signed and sealed by Land Surveyor registered in the State of Montana.
6. Fill in Cross Index & Section Diagram at bottom of sheet.

CERTIFIED CORNER RECORDATION

Corner NW SEC. COR. S26 T. 31 N. R. 34 W. P.M.M. Lincoln County

- I. 1903 Original Survey by Allen B. Benedict et. al: Set stone and scribed four bearing trees.

1985 Certified Corner Recordation by Carl R. McMillen, Reg. #4659S: "Found original stone, 10 X 10 X 6 ins. out of place 3 ft., w/2 (with 2) visible notches on the South and East edges.

Found 2 remains of fallen pine, bearing S36°45'W @ 19.8 ft. (30 lks. dist.). (original record)
Found 2 down 6 in. pine, bearing N26°30'W @ 21.1 ft. (32 lks. dist.). (original record)
Found stumpholes in NE & SE sec. corners.

Set a U.S.D.A. aluminum Mon. w/cap.

Set an 8", fir B.T., bears N36°E, @ 34.3 ft., scribed S23 BT.
Set a 12", larch B.T., bears S62°E, @ 25.9 ft., scribed S26 BT.
Set a 6", cedar B.T., bears S84°W, @ 22.7 ft., scribed S27 BT.
Set an 8", fir B.T., bears N32°W, @ 37.7 ft., scribed S22 BT."

- II. Found a 2 1/2 ins. dia. aluminum pipe, 6 ins. above ground with 3 1/4 ins. dia., U.S.D.A., Forest Service, aluminum cap marked as shown:

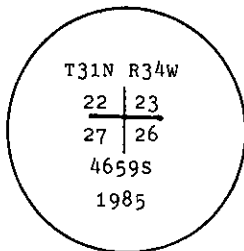

from which

A grand fir, 9 ins. dia., bears N43°E, 43.3 ft. dist., mkd. S23 BT. (1985 record: N36°E, 34.3 ft.)
A larch, 12 ins. dia., bears S54°E (recd: S62°E), 25.8 ft. dist., mkd. S26 BT. (1985 record)
A cedar, 8 ins. dia., bears N87°W (recd: S84°W), 22.7 ft. dist., mkd. S27 BT. (1985 record)
A grand fir, 9 ins. dia., bears N24°W, 37.0 ft. dist., mkd. S22 BT. (1985 record: N32°W, 37.7 ft.)
Rotten remains, bears S34°W, 18.0 ft. (27.3 lks.) dist., mkd. BT. (original record)

A 6 ft. galvanized steel guard post with Land Survey Marker decal, West, 2.3 ft.

- III. Painted red bands around the bearing trees and attached Land Survey Monument and Bearing Tree Signs.

Magnetic Declination 20° East

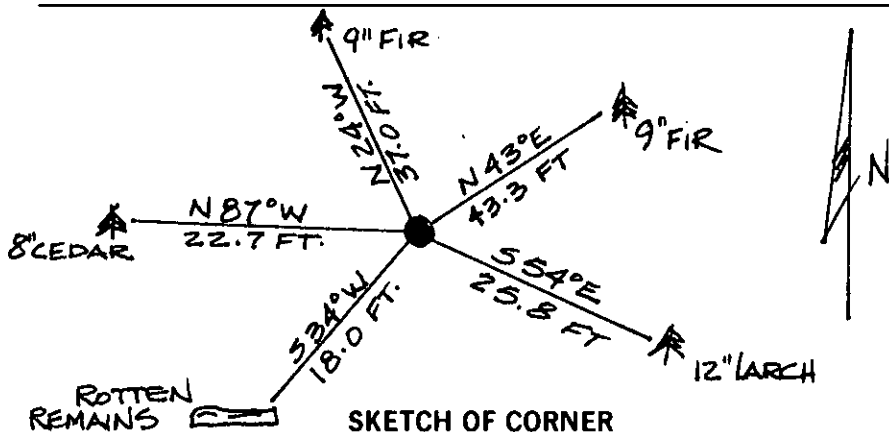

SKETCH OF CORNER

CERTIFICATION

I, Thomas M. Hommel
certify the information shown herein is true and correct.

Thomas M. Hommel
Signature Ground Party Chief

I, Alvah F. Hughes
certify that this Corner Record correctly represents work performed for me or under my direction in compliance with the "Corner Recordation Act" (70-22-101, et seq., M.C.A.)

Alvah F. Hughes
Signature of Surveyor & Seal

Date: 1/10/92 Reg. No. 73221S

Employer: U.S. FOREST SERVICE

Office of Clerk and Recorder, County of Lincoln. This "corner record" was filed for record on 4-21-92 was noted on the cross-index plat and is assigned page No. 5045, in book No. Coral M. ...

County Official [Signature]

R-17

31 N 34 W

Cross Index No. T. R. PMM

Sec. 26

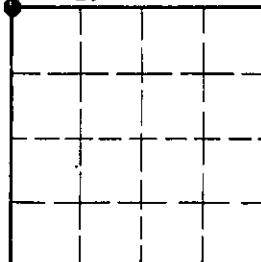

• - corner this sheet